

## Product Features

Available in standard and custom configuration  
Tempered safety glass  
Pivot jamba to have a continuous vinyl seal  
Top pivot pin to have safety washer to prevent accidental dislodging of the door

## Metal Cuts

SC-505 header = Centerline Dim. + 1/2  
SC-505A curb = Centerline Dim. + 1/2  
SC-505 return header = Centerline dim. + 1/2  
SC-505A return curb = Centerline dim. + 1/2  
SC-506 head and curb fill = Top and bottom rail + 3/8  
SC-508 wall jamb = Unit ht. - 3/4  
SC-513 90° post = Unit ht. - 3/4  
SC-522P pivot jamb = Unit ht. - 2  
SC-552S strike jamb = Unit ht. - 2  
SC-589 drip rail = door glass - 15/16  
SC-558 bottom rail = door glass - 4 5/8

## Parts List

- A. 2 Curb Sections (with weep slots)
- B. 2 90° Anchor Plates
- C. 26 #8 x 1/4 Truss Head Screws
- D. 2 Header Sections
- E. 2 Wall Jamba
- F. 6 Plastic Wall Anchors
- G. 6 #8 x 1 1/2 Truss Head Screws
- H. 2 Plastic Setting Blocks
- J. 2 Fixed Glass Panels
- K. 1 90° Post
- L. 1 180° Post
- M. 2 Clear Vinyl Jamb Seal
- N. 1 Glazed Door Panel
- P. 1 Pivot Jamb
- R. 1 Strike Jamb (Magnetic)
- S. 2 Snap-in Fillers
- T. 1 Drip Rail
- U. 2 Drip Plugs
- V. 1 Tapered Drip Vinyl
- X. 1 Roll Double Stick Tape
- AA. 1 Nylon Spacer
- BB. 2 Nylon Pivot Bushings
- CC. 1 Security Washer
- DD. 1 Interior Door Handle
- EE. 1 Exterior Door Handle
- FF. 2 #6 x 1 1/4 Round Head Screws
- GG. 8 Pcs .Vert. Glazing Vinyl (72)
- HH. 8 Pcs. Horiz. Glazing Vinyl (48°)

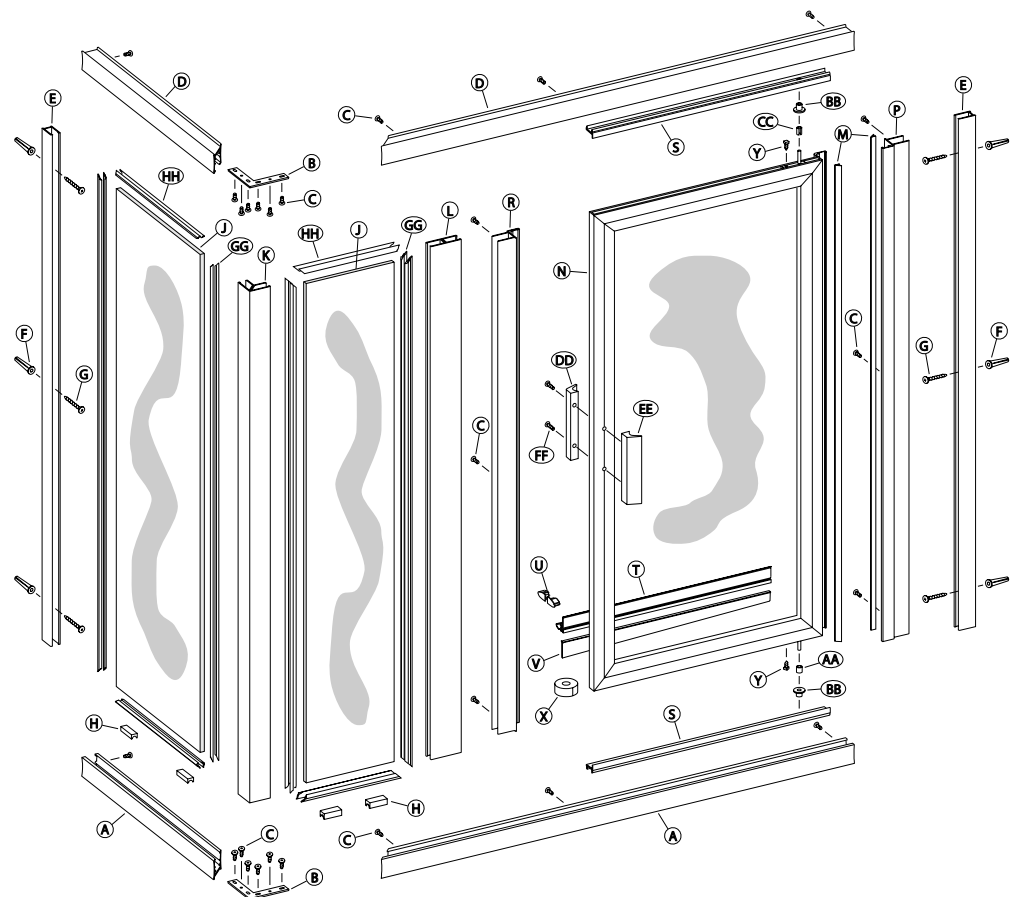

## Options

Glass patterns  
Finish

## Calculations

Maximum allowable width of unit = 36  
Maximum allowable height of unit = 84

## Glass Size

Door glass width  
= Centerline dim. - 2 11/16  
Door glass ht.  
= Unit ht. - 5  
Return panel glass width  
= Centerline dim. - 7/8  
Return panel glass ht. = Unit ht. - 1

