

F1364P – ACCESSIBLE SHOWERS

inches

Interior: 36 x 36 x 76

Exterior: 39 ¾ x 39 x 78 ½

The F1364P transfer shower features innovative installation design, including an engineered leveled base and improved front threshold. A true time and money saver, our pre-leveled base lets you install directly on a **level** floor. And its front threshold is engineered to keep a constant level without the use of brackets during installation.

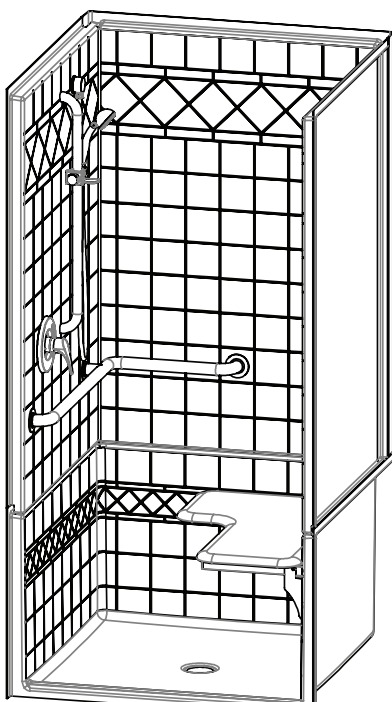

AQUATIC ADVANTAGE

- National distribution
- 6 manufacturing facilities
- Private fleet
- Centralized customer service
- Field support

COLOR & TRIM OPTIONS

Stock	Upgraded
White	Almond Biscuit Bone

**Additional custom colors available.
(Contact Customer Service)

FEATURES

- Pre-leveled base
- AcrylX™ applied acrylic surface
- ¾" skirt
- ½" interior threshold
- Barrier free properly installed
- 4-pc
- Diagonal tile design
- Center drain
- Lifetime limited warranty (30 year commercial)

OPTIONS

- RH or LH fixture wall
- Grab bars
- Fold-up seat
- Hand-held shower assembly with slide bar
- Pressure balancing mixing valve
- Soap dish
- Curtain rod and/ or shower curtain

CODE COMPLIANCE

- ADA
- FHA
- ICC/ANSI A117.1
- IAPMO Z124-2011
- HUD UM73a
- CAN/CSA-B651-04
- CSA-B45-11

**Code compliant when fully equipped and installed according to guidelines.



Aquatic products may be specified as Lasco Bathware.



F1364P

Interior: 36 x 36 x 76
Exterior: 39 ¾ x 39 x 78 ½
inches



ADA/ANSI compliant when fully equipped and installed according to guidelines.

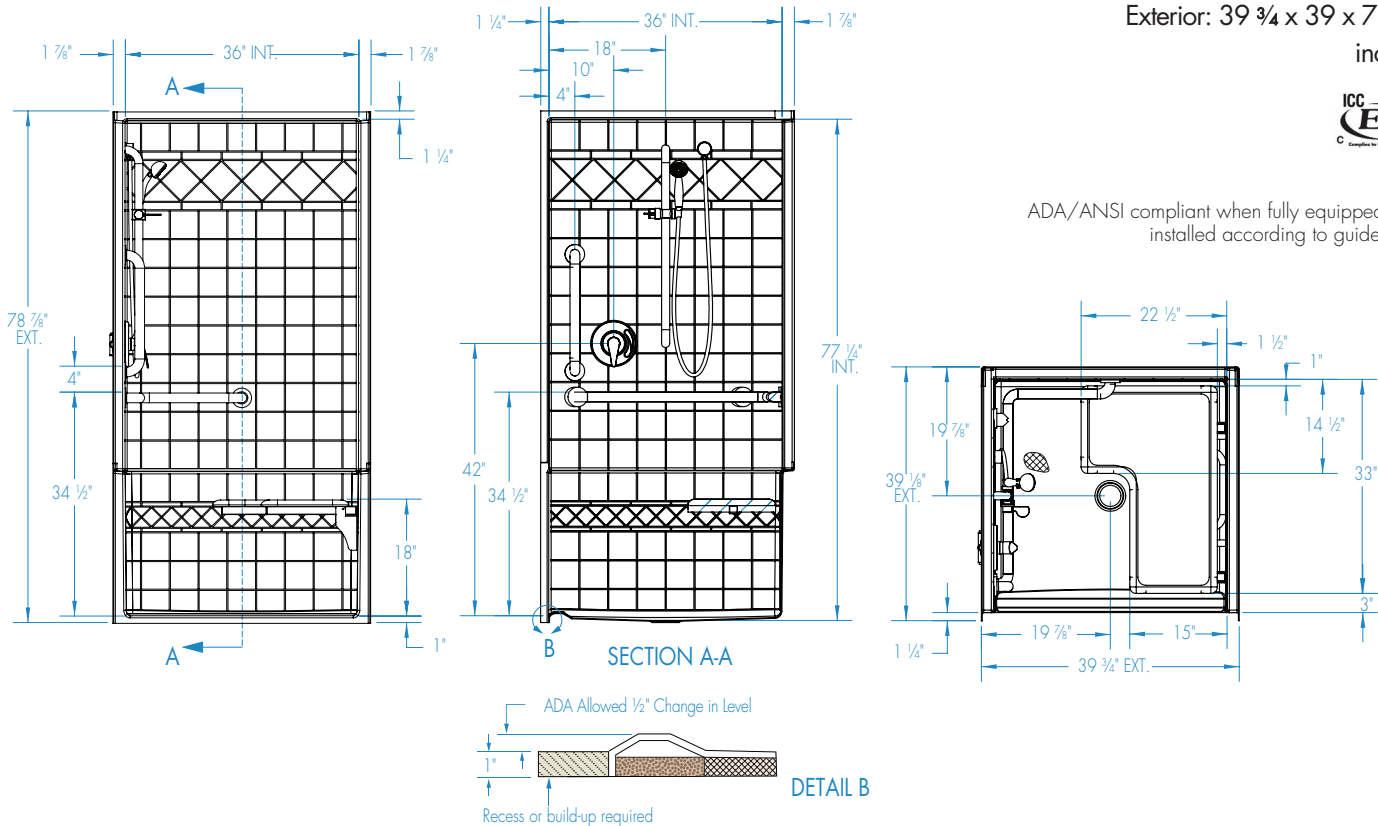

FEATURES

Dimensional Tolerance $\pm \frac{3}{8}$ ". Dimensions needed for site preparation should be measured from the unit. Aquatic assumes no responsibility for preparatory work.

Type and Model #	Material	Wall Finish	Pieces	Drain	Dam/Skirt Height	Net Wt. lbs	Pkg. Wt. lbs
Shower #F1364P	AcrylX™	Smooth tile	4	Center	¾" skirt, ½" interior threshold	152	162

DIMENSIONS

Specifications	inches
Width: Overall / Net	39 ¾ / 36
Depth: Overall / Net	39 / 36
Height: Overall / Net	78 ½ / 76
Enclosure Opening:	36
Skirt Height:	¾
Drain Rough-In (from Back Wall)	19 ¾
Drain Rough-In (from Side Wall)	19 ¾

FRAMING DIMENSIONS inches

Type	D Depth	W Width	H Height	A	B	C
Alcove	39	39 7/8	—	Box Out	19 ¾	19 ¾

