

# American Standard

## PRESSURE BALANCE TEMPERATURE/VOLUME CONTROL VALVE

MODEL NUMBER

**R121SS**

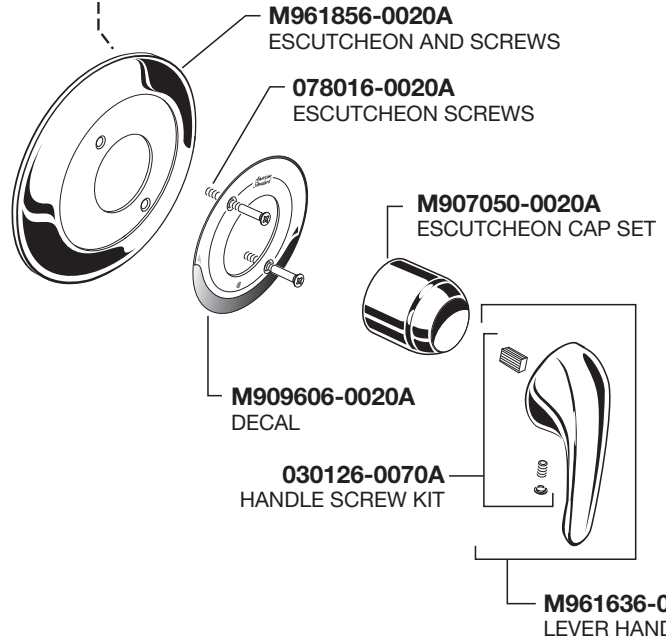
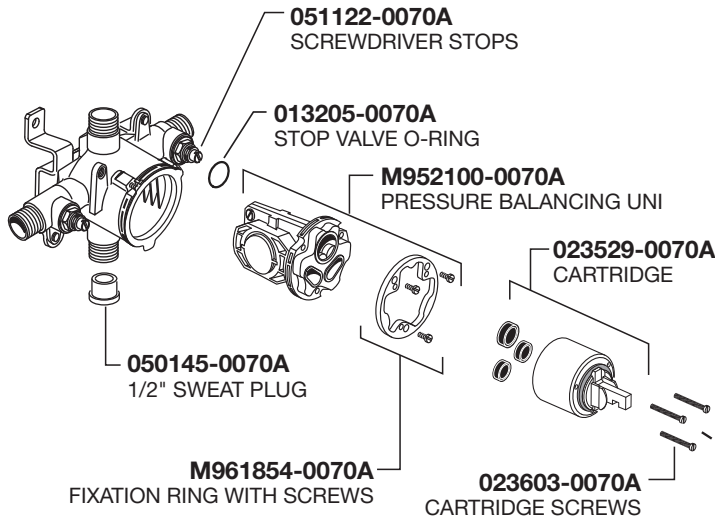

## COLONY SOFT VALVE TRIM

MODEL NUMBER

**T675.500**

Appropriate finish code

**CHROME 002**

### HOT LINE FOR HELP

For toll-free information and answers to your questions, call:

1 (800) 442-1902

Mon. - Fri. 8:00 a.m. to 8:00 p.m. EST

Saturday 10:00 a.m. to 4:00 p.m. EST

IN CANADA 1-800-387-0369

(TORONTO 1-905-306-1093)

Weekdays 8:00 a.m. to 7:00 p.m. EST

IN MEXICO 01-800-839-1200



PART OF **LIXIL**

# American Standard

36" SLIDE BAR

1660.236.002

3-FUNCTION HAND SHOWER

1660766.002  
(1.5 gpm)

1660767.002  
(2.5 gpm)

WALL SUPPLY

8888.037.002

8888037.002  
WALL SUPPLY

M962520-0020A  
CHECK VALVE

030782-0020A  
HOSE KIT

M9641800020A  
SPRAY HOLDER  
ASSEMBLY

M964179-0070A  
MOUNTING KIT

METAL HOSE

8888.035.002

022650-YYY0A  
DIVERTER SPOUT

Appropriate finish code

CHROME 002

## HOT LINE FOR HELP

For toll-free information and answers to your questions, call:  
1 (800) 442-1902

Mon. - Fri. 8:00 a.m. to 8:00 p.m. EST

Saturday 10:00 a.m. to 4:00 p.m. EST

IN CANADA 1-800-387-0369

(TORONTO 1-905-306-1093)

Weekdays 8:00 a.m. to 7:00 p.m. EST

IN MEXICO 01-800-839-1200



PART OF LIXIL