

W3024,W3624,W362424
W2424, W2724, W3324, W302424, W332424
ASSEMBLY INSTRUCTIONS

- STEP 1: Joint side panel with back panel
STEP 2: Joint top panel with side panel
STEP 3: Joint bottom panel with side panel
STEP 4: Attach frame on
STEP 5: Put on the adjustable shelves
STEP 6: Fix door onto the frame and adjust the cover-space

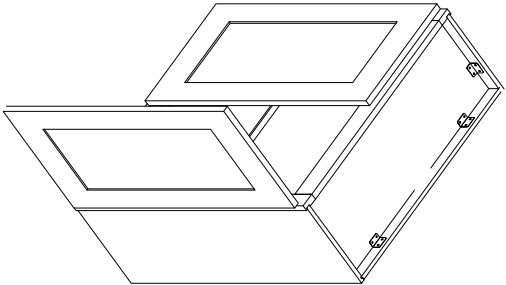

PARTS LIST		
NO.	Description	QTY
A	SIDE PANEL	2
B	BACK PANEL	1
C	TOP&BOTTOM PANEL	2
D	FACE FRAME	1
E	ADJUSTABLE SHELF	1
F	CABINET'S DOOR	2

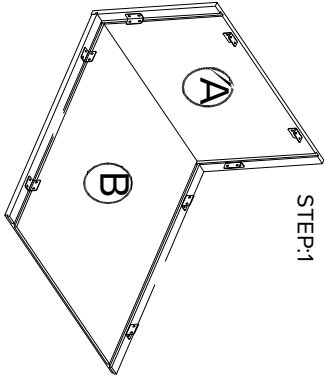

SOFTCLOSE HINGE

4



3/4" round head screw

4



BUMPER

4



SHELF CLIP

4



9/16" round head screw

56



CLEAT

14



1"FLAT HEAD SCREW FOR CARCASS

8

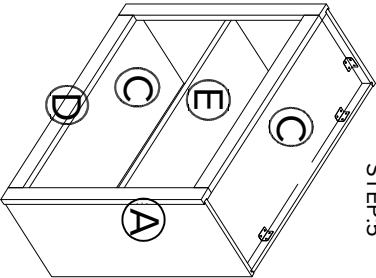

STEP:5

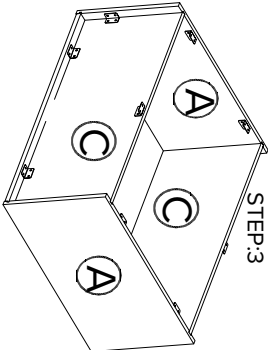

STEP:3

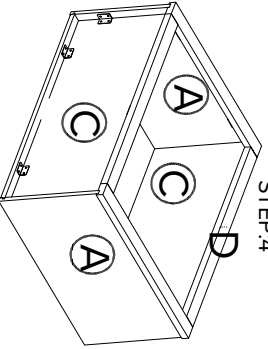

STEP:4

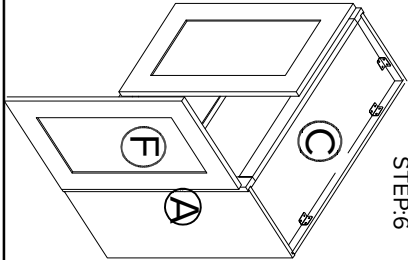

STEP:6



NO.

Description

QTY

PICTURE

HARDWARE LIST