

FEATURES

- Base Cabinet with 2 drawers or 2 doors for use with Catalano double bowl washbasin 1125LI.
- Frameless cabinet box made of 3/4" maple plywood with a light maple wood grain finish.
- Drawer boxes are 5/8" solid hard rock maple, joined at all 4 corners by dovetail joints. Drawer bottoms are 1/4" closed grain wood dadoed into drawer sides, front and back. Drawer fronts are solid one piece construction, attached to drawer box with wood screws.
- Includes polished chrome towel bar and set of (4) legs.
- Undermounted drawer glides with self-closing full extension guides.
- NL1252DR to be installed wall-hung or floor mounted. NL1252DO to be installed wall hung or floor mounted.
- Quality construction. Made in the USA

OPTIONS

- Additional Towel Bar TB19

Specified Model

	Model No.	No. of Drawers	No. of Doors	Size W x D x H	*Ship Wt. (lbs.)
<input type="checkbox"/>	NL1252DR	2	0	48 $\frac{1}{16}$ " x 18 $\frac{1}{2}$ " x 23 $\frac{1}{4}$ "	100
<input type="checkbox"/>	NL1252DO	0	2	48 $\frac{1}{16}$ " x 18 $\frac{1}{2}$ " x 23 $\frac{1}{4}$ "	100

*approximate shipping weight

To Be Specified: Finish/ Color

NEW LIGHT	
WOOD GRAIN LAMINATE	
<input type="checkbox"/>	05 Wharf
<input type="checkbox"/>	07 Canyon
GLOSS LAMINATE	
<input type="checkbox"/>	02 White



Shown NL1252DR-07 with optional 1125LI00 washbasin

NL1252DR

shown with 1125LI washbasin
(not included).

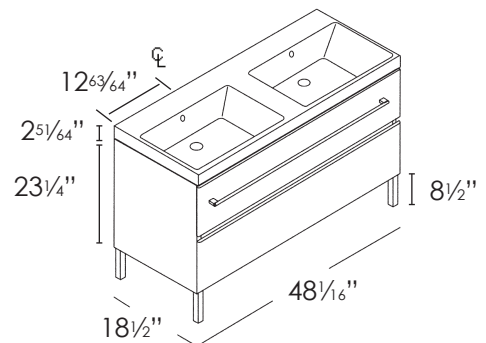

NL1252DO

shown with 1125LI washbasin
(not included).

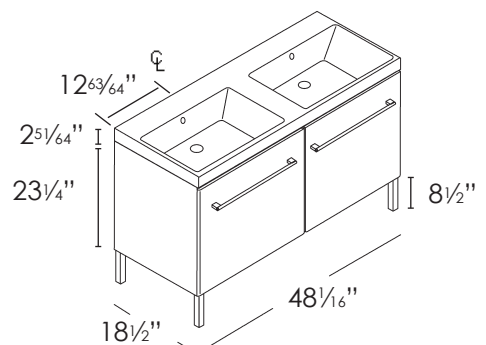

Made in USA