

FEATURES

- Base Side Cabinet with 2 drawers for use with Catalano Premium base cabinets.
- Frameless cabinet box made of 3/4" maple plywood with a light maple woodgrain finish.
- Drawer boxes are 5/8" solid hard rock maple, joined at all 4 corners by dovetail joints. Drawer bottoms are 1/4" closed grain wood dadoed into drawer sides, front and back. Drawer fronts are solid one piece construction, attached to drawer box with wood screws.
- Undermounted drawer glides with self-closing full extension guides.
- Cabinet available with both ends finished, one end finished (specify left or right side) or no finished ends.
- Quality construction. Made in the USA

FURNITURE FINISHES

- 9 Hi Gloss
- 1 Lacquer
- 3 Pattern Laminate
- 9 Wood Veneer
- 3 Euro Gloss Wood
- 3 Euro Gloss Solid

REQUIRED

- Premium Countertop Insert to complete installation. See Premium Countertop Specification for details.

OPTIONS

- Base Cabinets, Base Fillers. See Specification sheets.

Specified Model

	Model No.	Finished Ends	Size W x D x H	*Ship Wt. (lbs.)
<input type="checkbox"/>	PM10S2DRB	Both	39 ³ / ₈ " x 18 ¹ / ₂ " x 29 ⁷ / ₈ "	202
<input type="checkbox"/>	PM10S2DRL	Left		
<input type="checkbox"/>	PM10S2DRR	Right		
<input type="checkbox"/>	PM10S2DRN	None		

*approximate shipping weight

To Be Specified: Finish/ Color

WOOD VENEER		EURO GLOSS WOOD		HI GLOSS	
<input type="checkbox"/>	V01 Walnut Burl	<input type="checkbox"/>	E01 Olivio Gloss	<input type="checkbox"/>	H01 Arctic
<input type="checkbox"/>	V02 Zebra Wood	<input type="checkbox"/>	E02 Tobaco Gloss	<input type="checkbox"/>	H02 Ivory
<input type="checkbox"/>	V03 Grey Oak Lati	<input type="checkbox"/>	E03 Guayana Gloss	<input type="checkbox"/>	H03 Glacier
<input type="checkbox"/>	V04 Ebony Safari	EURO GLOSS SOLID		<input type="checkbox"/>	H04 Light Grey
<input type="checkbox"/>	V06 Walnut Crown			<input type="checkbox"/>	H05 Slate
<input type="checkbox"/>	V07 Anigre Figured	<input type="checkbox"/>	E04 Pistachio	<input type="checkbox"/>	H06 Black
<input type="checkbox"/>	V08 Ash Lati	<input type="checkbox"/>	E05 Magenta	<input type="checkbox"/>	H07 Cobalt
<input type="checkbox"/>	V09 Wenge Groove	<input type="checkbox"/>	E06 Blue Metallic	<input type="checkbox"/>	H08 Graphite
<input type="checkbox"/>	V10 Silver Ash	LACQUER		<input type="checkbox"/>	H09 Champagne
		<input type="checkbox"/>	L01 White	PATTERN LAMINATE	
				<input type="checkbox"/>	P01 White Velvet
				<input type="checkbox"/>	P02 Grey Velvet
				<input type="checkbox"/>	P03 Black Flame



Made in USA



Shown PM10S2DRB-V09 Wood Veneer finish with required Premium Countertop Insert.

PM10S2DR.

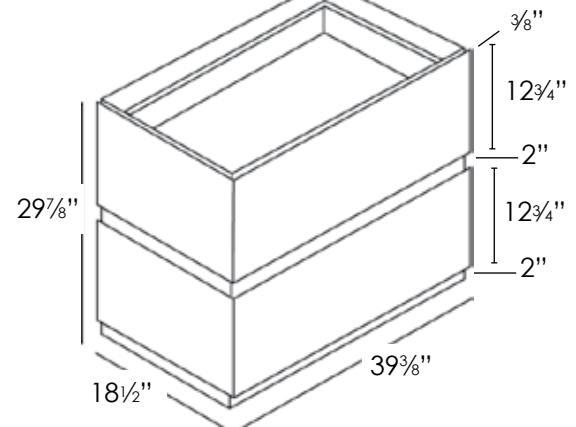

UNDERSTANDING FINISHED/NON-FINISHED CABINET ENDS AND THE USE OF FILLERS

When the cabinet end is not finished, a filler must be used when placing the cabinet against a wall (minimum filler needed is 1"). When combining cabinets, adjoining cabinets do not require a finished end, however a 3-1/2" filler must be used - this adds 2" to the overall length of the ensemble and maintains the 2" recess design of the Premium Cabinet Collection.