

**Clarion**  
BATHWARE

## Collapsible Threshold & End Caps

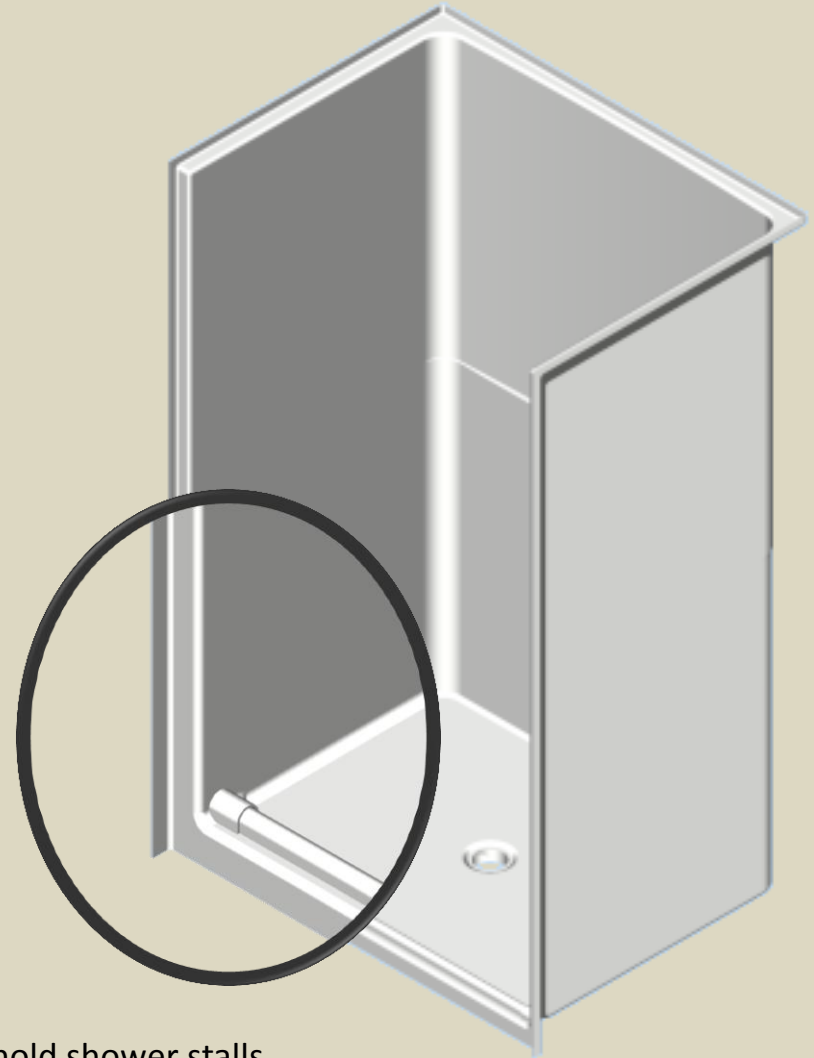
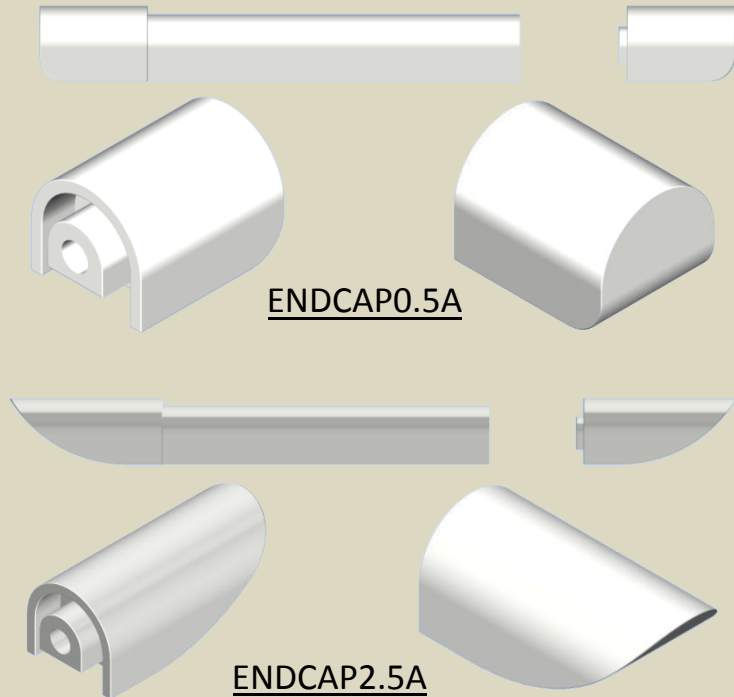

### **Clarion Bathware introduces the new and improved collapsible threshold with end caps.**

- \*This improvement utilizes our original threshold design with the addition of end or termination caps that improve the aesthetics and simplify the installation process.
- \*This innovation is a recommended accessory for all of our ¾" threshold shower stalls, but is also available for purchase as a standalone product for any low threshold units.

**[Click Here for Installation Instructions](#)**

For product information contact the Clarion Bathware Team.

Amy Wolbert (Sales Institutional), Pam McHenry (Sales Residential), Lee Wentling (SVP Sales & Marketing), Brain Milford (Engineering), or Dave Groner (CEO)

Contact Information: Phone: (800) 576-9228, [www.clarionbathware.com](http://www.clarionbathware.com)

**Instructions**

Cut on dashed line.

Use template to determine which radius best fits your shower stall.

Measure width of threshold flange to determine the length of collapsable threshold needed.

TCap 2.5

TCap .5