

FRONT VIEW

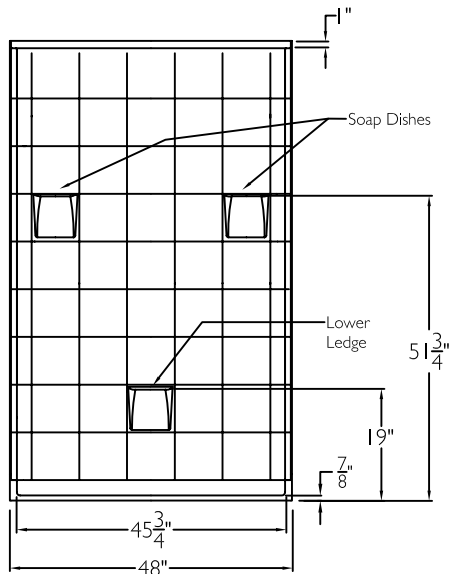

SIDE VIEW

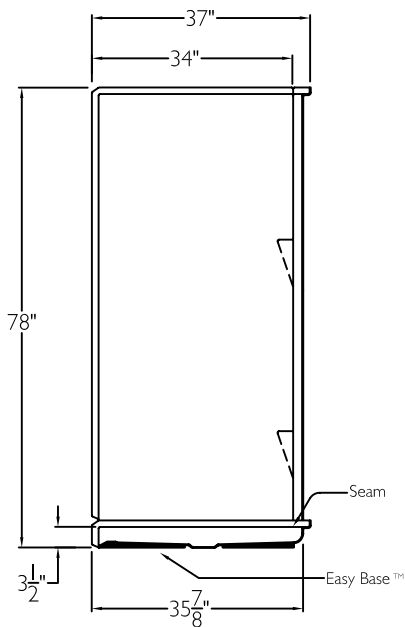

TOP VIEW

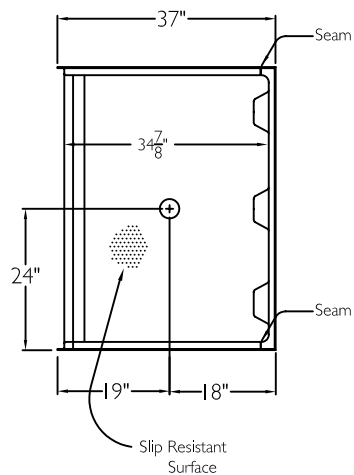

CROSS SECTION OF THRESHOLD

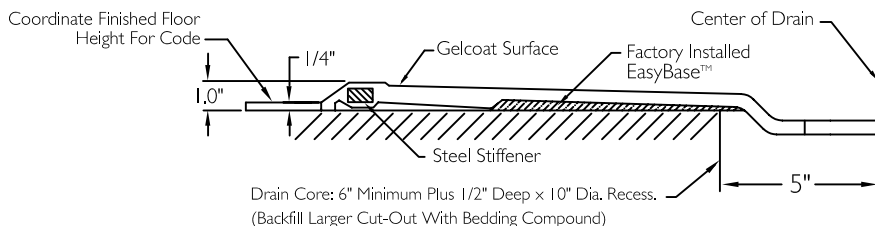

SUBMITTAL

This shower enclosure shall be model XST 4836 BF 4P .875 center drain. Finished surface shall be of a sanitary grade polyester gelcoat exhibiting a minimal thickness of 15 dry mils and a finished cured Barcoal hardness of 80-90 as tested with ASTM D-2583. Unit construction shall be of a molded reinforced fiberglass with a 15% minimum fiberglass content.

The unit shall have outside dimensions of 48" x 37" x 78"

The unit shall meet ANSI Z124.1-2. HUD, BOCA, NAHB, UPC, and shall meet the requirements of the Southern Building Code.

The enclosure shall be equipped with the following accessories:

1) Four piece sectional design, 2) Three molded soap ledges, two high, and one low on the back wall, 3) tile finish 4) full wood backing on all walls, 5) self locating aluminum guide pin wall interlocking system, 6) center drain, 7) low profile 7/8" change of level threshold, 7) EasyBase™ self sustaining bottom.

THIS UNIT FEATURES THE OUTSIDE DIMENSION OF 48" OF OVERALL WIDTH. THIS DOES NOT ALLOW FOR FULL ENCLOSURE OF THE BOLTS AND NUTS USED TO SECURE THE BARS AND SEAT IN PLACE. THE BOLT AND NUT COMBINATION SHOULD NOT PROTRUDE MORE THAN 3/4" ON EITHER SIDE OF THE SHOWER WALLS. THIS MAY REQUIRE THE NEED TO NOTCH STUDS TO ALLOW BOLT CLEARANCE FOR A DRYWALL ENCLOSED FIRE WALL INSTALLATION. ADJUSTMENT OF THE WALL BOARD MAY BE NECESSARY TO PROVIDE CLEARANCE OF THE BOLT(S) WHILE MAINTAINING THE INTEGRITY OF THE DRYWALL ENCLOSED FIRE WALL ENCLOSURE.

Job Name	Approved By	Name	Date	COMFORT DESIGNS	
Project No	Architect			Model No. XST4836 BF 4P .875-I	
Comfort Designs 435 Industrial Road Savannah, TN 38372 tel 800.443.7269 fax 731.925.4290 www.comfortdesignsbathware.com	Engineer			Drawing No. XST 4836 BF 4P .875 C FWB EB	
	Rep			Date Issued, 4-23-12	Drawing Rev.
	Wholesaler			Material, Gelcoat Surface	
	Comments			Color,	
				Dimensions are in inches. Due to the nature of the materials dimensions may vary ± 1/2"	