

CD Product Sheet

COMMERCIAL MULTI-PIECE

XST6060BF 5P C

MULTI-PIECE
Enhancing Livable Design

TECHNICAL INFORMATION

OD 60" x 61" x 78"

THRESHHOLD 1.125"

LOAD FACTOR .80

HANDED BY Center Drain

FRONT VIEW

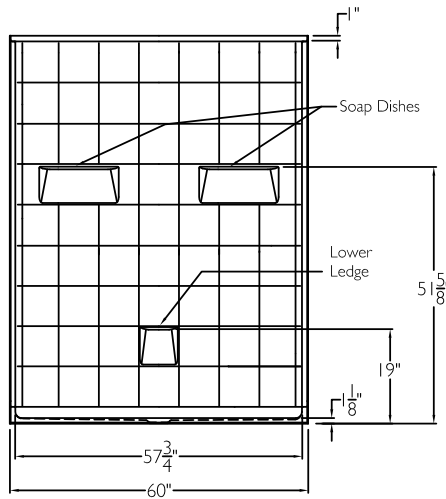

SIDE VIEW

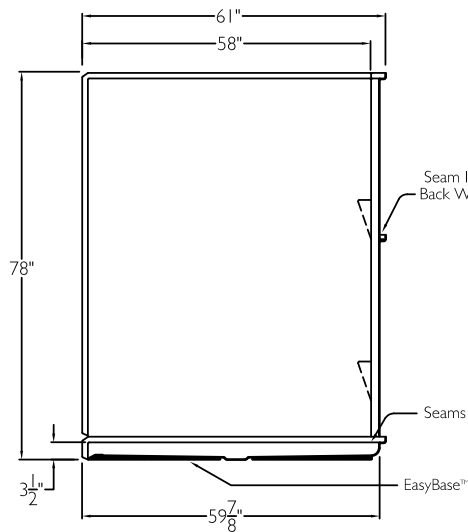

TOP VIEW

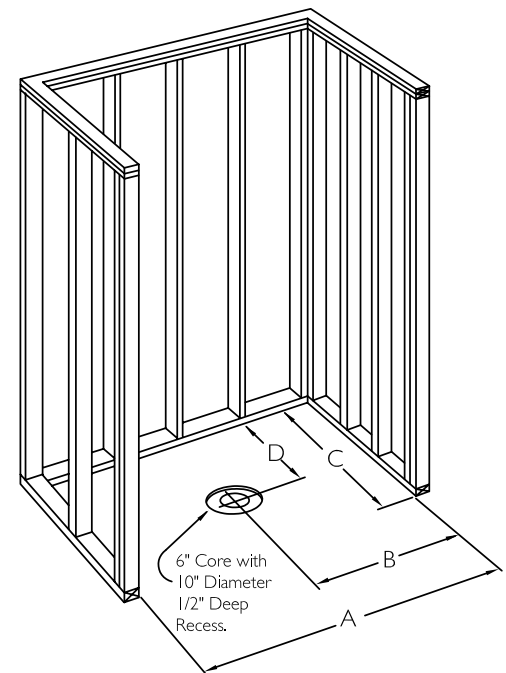
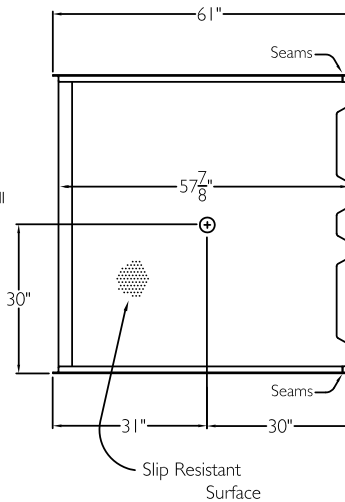

FRAMING DIMENSIONS

A 60.25" **B** 30.125"

C 61" **D** 30"

CROSS SECTION OF THRESHOLD

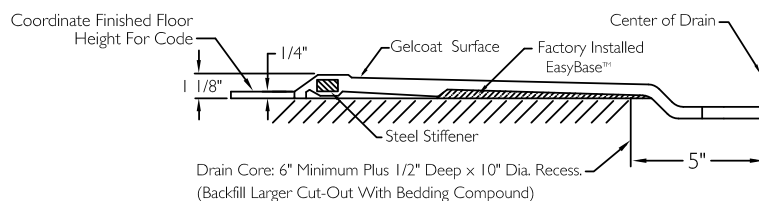

ADDITIONAL CODES

ICC/ANSI I 17.1, ANSI I 24.2, BOCA,
NAHBUPC, Southern Building Code

cd
comfortdesigns

comfortdesignsbathware.com | 800.443.7269