

FRONT VIEW

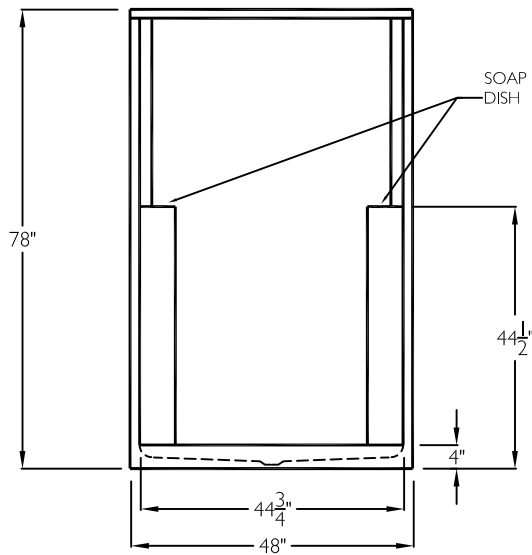

SUBMITTAL

This shower enclosure shall be model SSS 4878 SH NS, right, or left. Finished surface shall be of a sanitary grade solid surface exhibiting a minimal thickness of 55 dry mils and a finished cured Barcoal hardness of 80-90 as tested with ASTM D-2583. Unit construction shall be of a molded reinforced fiberglass with a 15% minimum fiberglass content.

The unit shall have outside dimensions of 48" x 35 1/2" x 78". The unit shall meet CSA B45.5-11, BOCA, NAHB, IAPMO Z124-2011, and shall meet the requirements of the Southern Building Code.

HANDED BY THE CENTER DRAIN

SIDE VIEW

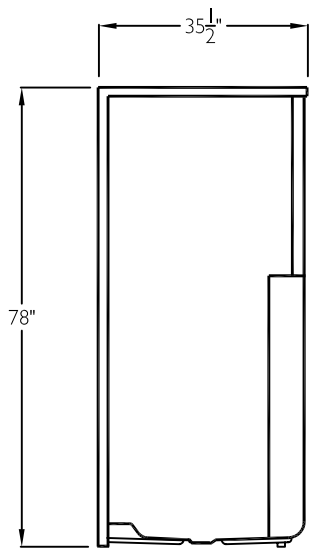

TOP VIEW

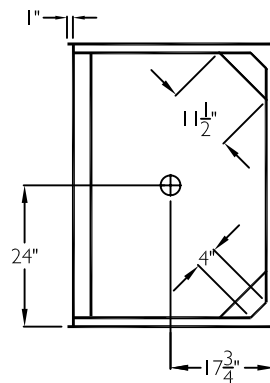

The enclosure shall be equipped with the following accessories:

- 1) Molded soap ledges in each corner,
- 2) Center drain location,
- 3) Solid surface,
- 4) 4" Threshold.

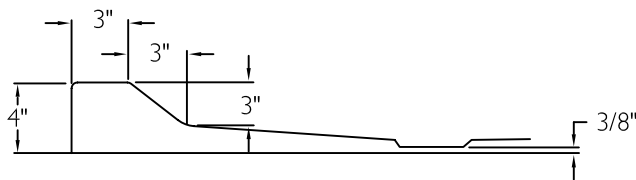

MODIFIED THRESHOLD DETAIL

Job Name	Approved By	Name	Date	COMFORT DESIGNS	
Project No	Architect			Model No. SSS 4878 SH NS 4.0	
Comfort Designs 435 Industrial Road Savannah, TN 38372 tel 800.443.7269 fax 731.925.4290 www.comfortdesignsbathware.com	Engineer			Drawing No. SSS 4878 SH NS 4.0	
	Rep			Date Issued. 4-3-12	Drawing Rev. 7-11-13
	Wholesaler			Material. Solid Surface	
	Comments			Color,	
				Dimensions are in inches. Due to the nature of the materials dimensions may vary $\pm 1/2"$	