

Submitted Model No.: \_\_\_\_\_

Specific Features: \_\_\_\_\_

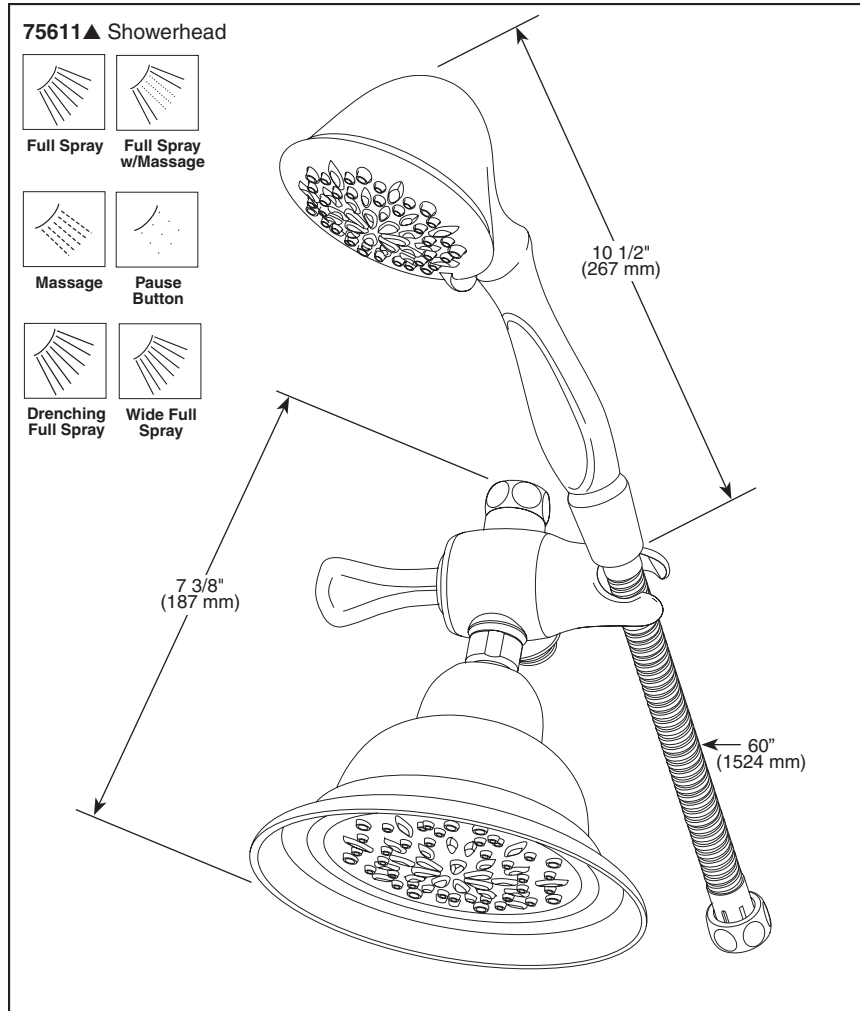

▲ Designate proper finish suffix



## COMBO PACK

- 2-In-1 Shower
- 2.5 GPM Max @ 80 PSI (Each Device)

### STANDARD SPECIFICATIONS:

- Easy installation on existing shower arm or using included shower arm and flange.
- Handshower docks securely onto diverter arm mount when not in use.
- Multiple handshower spray settings and pause feature.
- Five foot stainless steel hose.

### WARRANTY

- Lifetime Faucet and Finish Limited Warranty to the original consumer purchaser to be free from defects in material and workmanship.
- 5 Year Limited Warranty for usage in all industrial, commercial and business applications.



### COMPLIES WITH:

- ASME A112.18.1 / CSA B125.1

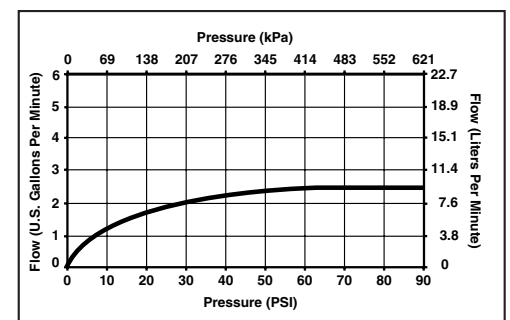

Delta reserves the right (1) to make changes in specifications and materials, and (2) to change or discontinue models, both without notice or obligation. Dimensions are for reference only. See current full-line price book or [www.specselect.com](http://www.specselect.com) for finish options and product availability.

DSP-B-75611 REV. A

55 E 111th Street, Indianapolis, Indiana 46280  
350 South Edgeware Road, St. Thomas, ON N5P 4L1  
© 2011 Masco Corporation of Indiana