

1158LF▲

Submitted Model No.: _____

Specific Features: _____

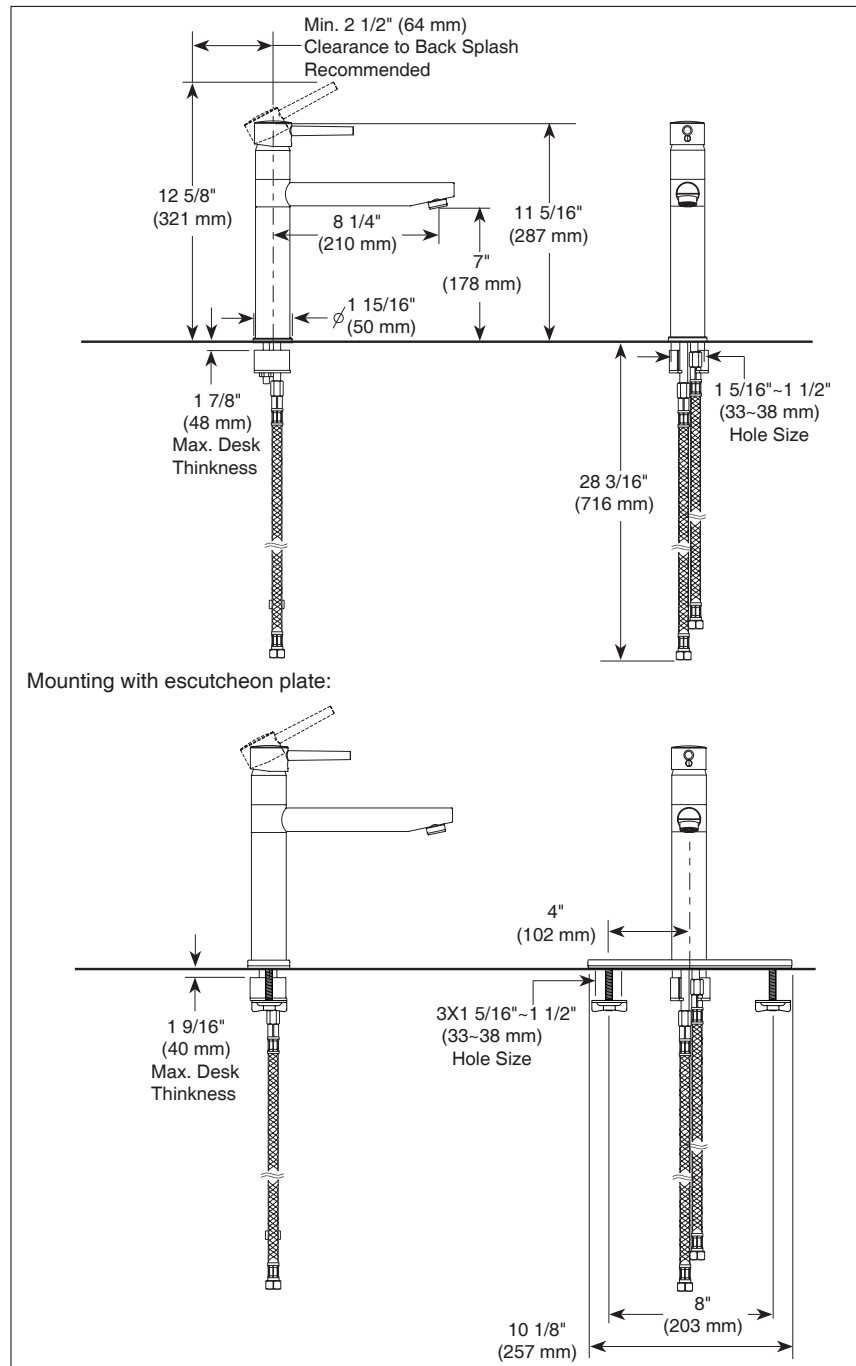

▲ Designate proper finish suffix

Delta reserves the right (1) to make changes in specifications and materials, and (2) to change or discontinue models, both without notice or obligation. Dimensions are for reference only. See current full-line price book or www.specselectonline.com for finish options and product availability.

DSP-K-1158LF Rev. A



KITCHEN FAUCETS

- Grail® Series
- Single Handle Deck Mount
- 1 Hole or 3 Hole Sink Applications

STANDARD SPECIFICATIONS:

- Ceramic cartridge.
- 1 hole or 3 hole 8" installation.
- 8 1/4" (210 mm) long, 7" (178 mm) high spout, swings 360°.
- Maximum 1 7/8" (48 mm) deck thickness for 1 hole installation.
- Maximum 1 9/16" (40 mm) deck thickness for 3 hole installation.
- Color coded button on handle for hot/cold identification.
- Maximum flow rate 1.8 gpm @ 60 PSI.

WARRANTY

- Lifetime limited warranty on parts (other than electronic parts and batteries) and finishes; or, for commercial users, for 5 years from the date of purchase.
- 5 year limited warranty on electronic parts (other than batteries); or for commercial users, for 1 year from the date of purchase. No warranty is provided on batteries

COMPLIES WITH

- ASME A112.18.1 / CSA B125.1
- ASME A112.18.6

 Indicates compliance to
ICC / ANSI A117.1

Verified compliant with 0.25% weighted
average Pb content regulations

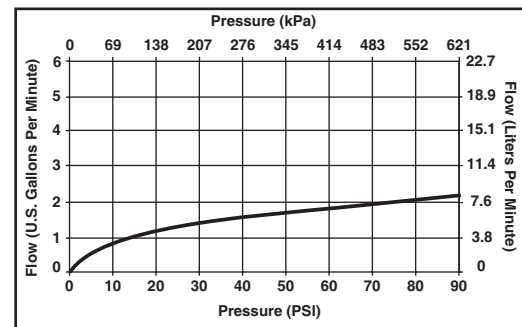

55 E. 111th Street, Indianapolis, Indiana 46280
350 South Edgeware Road, St. Thomas, Ontario Canada N5P 4L1
© 2013 Masco Corporation of Indiana