

ELKAY®

1100000031 -- SEDIMENT FILTER KIT INSTALLATION INSTRUCTIONS

Note: Danger! Electrical shock hazard. Disconnect power and shut off water before servicing unit.

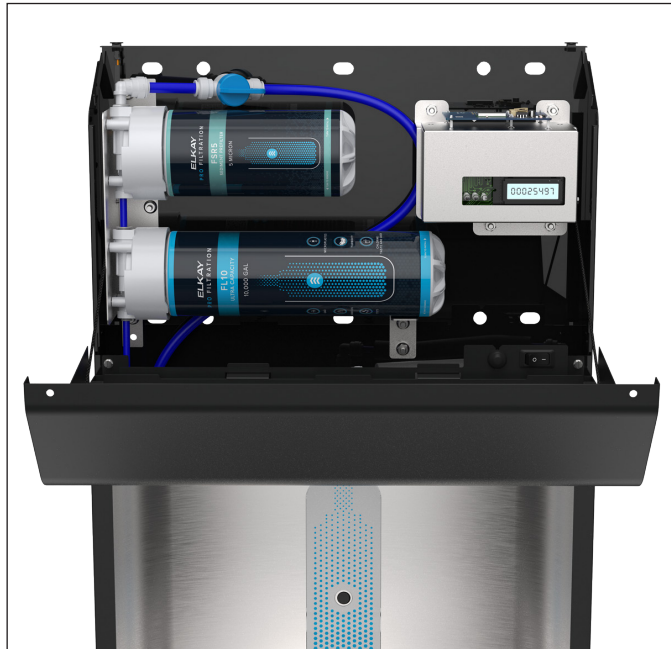

IMPORTANT

FOR INDOOR APPLICATION ONLY. ALL SERVICE TO BE PERFORMED BY AN AUTHORIZED SERVICE PERSON.

TOOLS REQUIRED BUT NOT PROVIDED

SAFETY GLASSES
GLOVES
PHILLIPS SCREW DRIVER
T25 SCREW DRIVER
FLAT BLADE SCREW DRIVER
1/4" NUT DRIVER
3/8" NUT DRIVER

Patent zurn-elkay.com/patents

⚠ **WARNING:** Cancer and Reproductive Harm - www.P65Warnings.ca.gov

⚠ **ADVERTENCIA:** Cáncer y daño reproductivo - www.P65Warnings.ca.gov

⚠ **AVERTISSEMENT:** Cancer et effets néfastes sur la reproduction - www.P65Warnings.ca.gov

Note: Danger! Electrical shock hazard. Disconnect power and shut off water before servicing unit.

Instructions for adding Elkay Pro Filtration® Sediment Filter Kit

1. Remove two (2) security screws (T25) securing the filter access door to the bottle filler with torx T25 screwdriver. Remove the filter access door.
5. Ensure that all electrical power is off by disconnecting power to the unit at the outlet or by turning power off to the circuit powering bottle filler.

Note: Do not discard mounting screws, they will be needed to resecure the filter door.

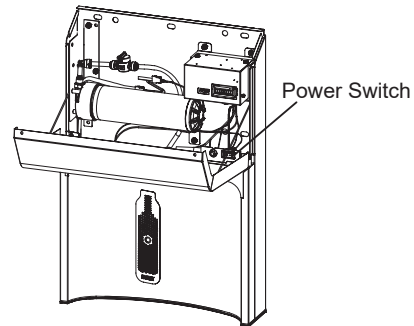
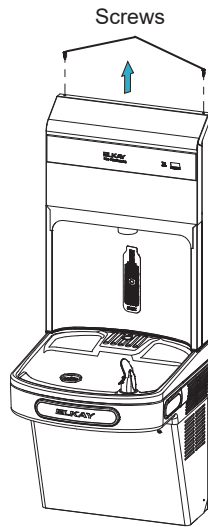

2. Rotate the filter access door forward. The door will be retained in the open position by the tethers.
6. Rotate lower filter counter-clockwise 1/4 turn to remove from filter head.

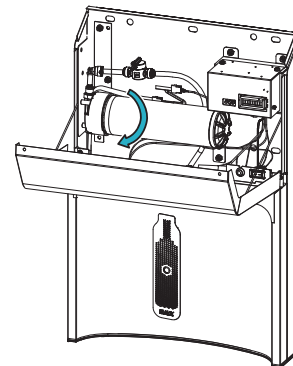
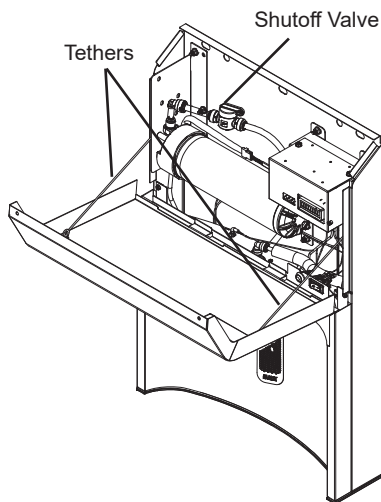

3. Turn off the water supply by rotating the shutoff valve clockwise so lever is perpendicular to inlet/outlet tubing.
4. Dispense water to relieve pressure by activating bottle filler IR sensor or push bars on the bubbler front panel.
7. Disconnect lower filter cable from main wire harness.

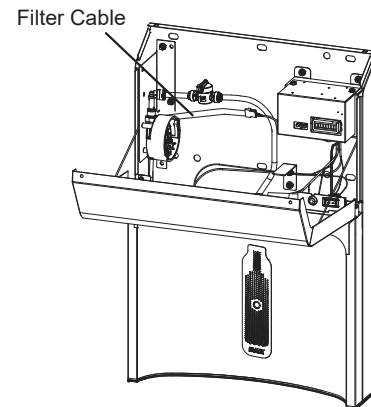

8. Remove the 3/8" elbow fitting from the inlet to the lower filter head by depressing collar on filter head, leaving the 3/8" poly tubing attached to fitting.

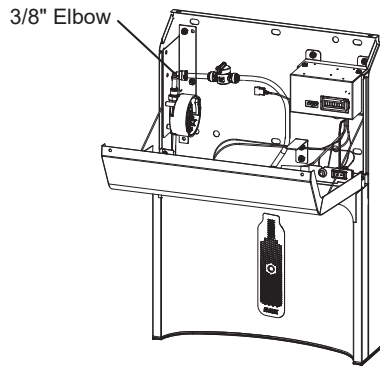

9. Remove filter mounting bracket from back panel by removing three (3) fasteners that hold the bracket to the back panel, using a 3/8" nut driver or socket.

Note: Do not discard the #10 nuts, they will be needed to resecure the filter bracket.

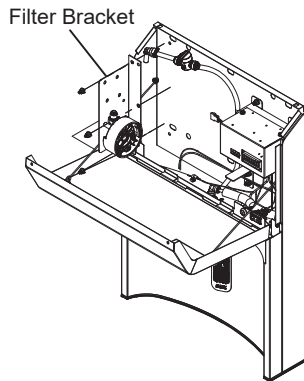

10. Install stem fitting from kit into the 1/4" end of sediment filter head supplied with kit (the 1/4" fitting is on the outlet of the filter head).
11. Slide the filter head and stem assembly into the lower filter head and secure filter head to filter bracket using four (4) screws supplied. 3/8" end of stem fitting should be inserted into top of lower filter head.
12. Reinstall filter mounting bracket to the back panel by reusing the three (3) fasteners that hold the bracket to the back panel, using a 3/8" nut driver or socket.

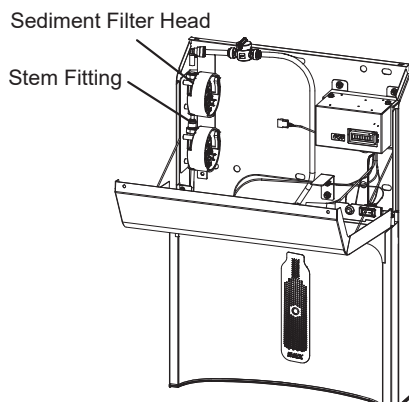

13. Reinstall the 3/8" elbow fitting removed in step 8 to the upper filter head by pressing the fitting into the top of the filter head, leaving the 3/8" poly tubing attached to fitting.

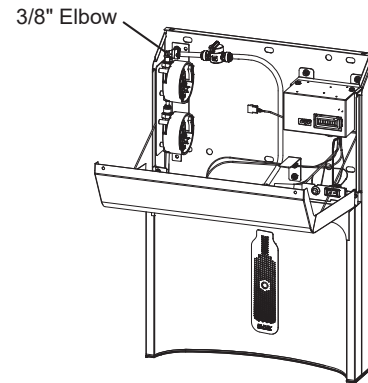

14. Using the harness supplied in kit, connect the long end of the harness to the upper filter head assembly and the short end of the harness to the lower filter head assembly. Reconnect the remaining end of the harness to the end of the main wire harness that was removed in step 7.

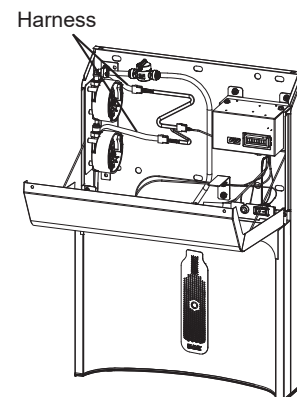

15. Reinstall filter removed in step 6 into lower filter head and turn fully clockwise.

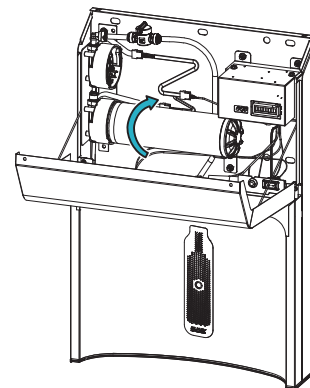

16. Insert new sediment filter into upper filter head and turn fully clockwise.

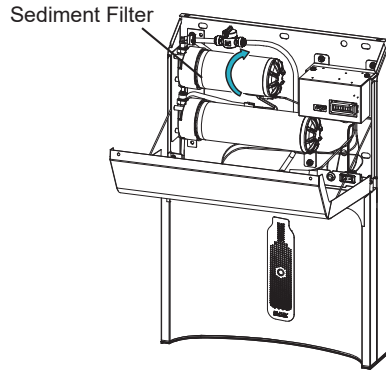

17. Turn on the water supply by rotating the shutoff valve clockwise so lever is parallel to inlet/outlet tubing. Confirm that there are no leaks.
18. Turn on the electrical power by depressing the right side of the power switch, moving it to the on position.
19. Close the filter access door, do not secure with screws at this step.
20. Wait for the automatic filter flush timer to begin counting down. After the countdown is complete, the unit will continuously flush water through the system. This should take 1-3 minutes.
21. Once automatic filter flush complete, secure filter access door using the two mounting screws from step 1.

22. Verify proper dispensing from the bottle filler by placing a cup under the water dispenser spout and verify the bubbler operation by pressing the push bar on the front panel.

Note: Initial dispenses may sputter due to air in the line. If air is trapped in the inlet line or filter, micro bubbles may be present and water may appear cloudy. Over time these bubbles will dissipate and water will run clear.

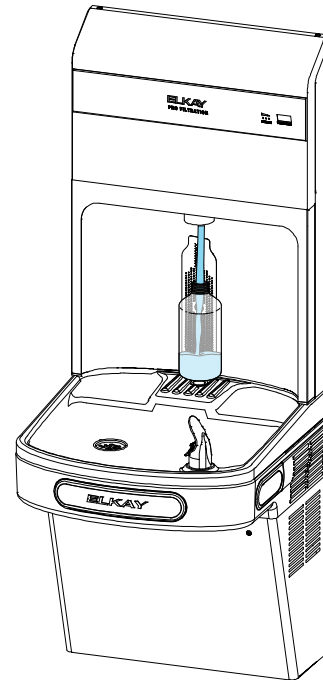

Instructions For Replacing Pro Filtration Filters

WARNING

Turn off power when servicing filters.

1. Remove two (2) mounting screws securing the filter access door to the bottle filler using Torx T25 security bit screwdriver and rotate the access door forward. The filter access door will be held in the open position by the tethers.
2. Turn off water supply by rotating the blue lever on the water shutoff valve located in the bottle filler clockwise so lever is perpendicular to inlet/outlet tubing.
3. Dispense water to relieve pressure by using bottle filler IR Sensor or bubbler.
4. Turn off power to the unit using the rectangular rocker switch located above the lower right corner of door.
5. Hold a rag or towel underneath the filter before removing to catch any dripping water.
6. Rotate filter counterclockwise to disengage filter from head and remove.
7. Remove protective cap from new filter and place the cap on the used filter to seal it.
8. Engage filter to filter head by pressing filter into head and rotate filter clockwise to tighten.
9. Turn on water supply by rotating blue lever on the water shutoff valve 90 degrees counter-clockwise so lever is parallel to inlet/outlet tubing.
10. Turn on electrical power to the unit using the rectangular rocker switch.
11. When power is restored, the unit will start an automatic flush sequence to remove air from the system.
12. After filter flush is complete, close filter access door and reinstall mounting screws.

Pro Filtration® Sediment Filter Parts List

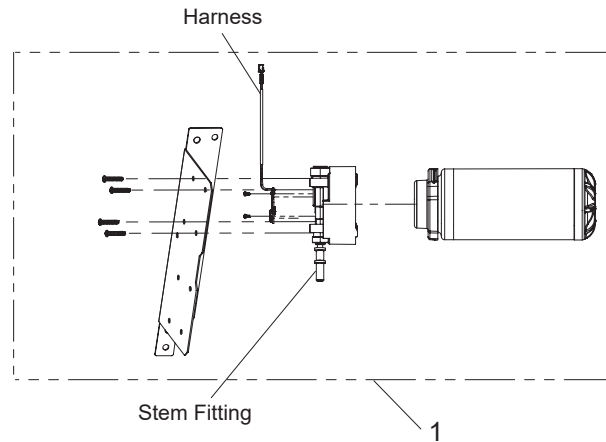

Fig. 1

Pro Filtration® Sediment Filter Detail

Pro Filtration® Sediment Filter Parts List		
ITEM NO.	PART NO.	DESCRIPTION
1	1100000031	Sediment Filter Kit – Includes FSR5 filter, Filter head, Stem Fitting, Harness and Mounting screws



Scan for information on where to buy and troubleshooting assistance.

OPERATION OF QUICK CONNECT FITTINGS

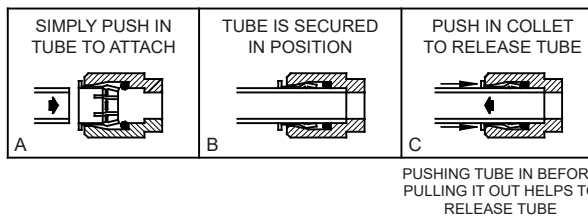

Fig. 2

FCC COMPLIANCE STATEMENT

CAUTION: Changes or modifications not expressly approved could void your authority to use this equipment. This device complies with Part 15 of the FCC Rules. Operation is subject to the following two conditions: (1) This device may not cause harmful interference, and (2) this device must accept any interference received, including interference that may cause undesired operation.

NOTE: This equipment has been tested and found to comply with the limits for a Class B digital device, pursuant to part 15 of the FCC Rules. These limits are designed to provide reasonable protection against harmful interference in a residential installation. This equipment generates, uses and can radiate radio frequency energy and, if not installed and used in accordance with the instructions, may cause harmful interference to radio communications. However, there is no guarantee that interference will not occur in a particular installation. If this equipment does cause harmful interference to radio or television reception, which can be determined by turning the equipment off and on, the user is encouraged to try to correct the interference by one or more of the following measures:

- Reorient or relocate the receiving antenna.
- Increase the separation between the equipment and receiver.
- Connect the equipment into an outlet on a circuit different from that to which the receiver is connected.
- Consult the dealer or an experienced radio/TV technician for help.

To ensure compliance with FCC and ICSED RF exposure requirements this device must be installed to provide a minimum of 20cm between the device and people.

INDUSTRY CANADA STATEMENT

This device complies with Industry Canada license-exempt RSS standard(s). Operation is subject to the following two conditions: (1) this device may not cause interference, and (2) this device must accept any interference, including interference that may cause undesired operation of the device.

Le présent appareil est conforme aux CNR d'Industrie Canada applicables aux appareils radio exempts de licence. L'exploitation est autorisée aux deux conditions suivantes : (1) l'appareil ne doit pas produire de brouillage, et (2) l'utilisateur de l'appareil doit accepter tout brouillage radioélectrique subi, même si le brouillage est susceptible d'en compromettre le fonctionnement.



2000002339

PRINTED IN U.S.A.

FOR PARTS, CONTACT YOUR LOCAL DISTRIBUTOR OR CALL 1.800.834.4816
REPAIR SERVICE INFORMATION TOLL FREE NUMBER 1.800.260.6640

ELKAY MANUFACTURING COMPANY • 1333 BUTTERFIELD ROAD SUITE 200 DOWNERS GROVE, IL 60515 USA • 630.574.8484 • www.elkay.com