

# ELKAY<sup>®</sup>

## SPECIFICATIONS

### The Mystic<sup>®</sup> by Elkay Undermount Sink Model MYSTICE2920

#### GENERAL

Highest quality sink formed of #18 (1.2mm) gauge, type 304 (18-8) nickel bearing stainless steel. Undermount.

#### DESIGN FEATURES

Bowl Depth: 10" (254mm).

Finish: Exposed surfaces are polished to a Bright Euro Highlighted finish.

Underside: Fully protected by heavy duty Sound Guard<sup>®</sup> undercoating designed to reduce condensation and dampen sound.

#### OTHER

Drain Opening: 3-1/2" (89mm).

NOTE: All Elkay undermount sinks are designed to affix to the underside of any solid surface countertop.

Installation: See illustrated profile below.

Sink complies with ASME A112.19.3-2008 / CSA B45.4-08

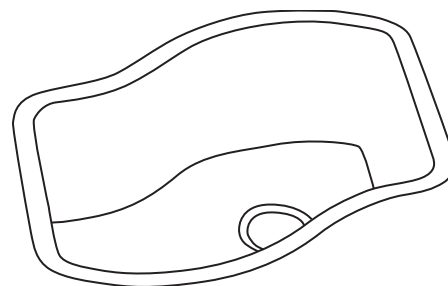

Model MYSTICE2920

#### SINK DIMENSIONS\*

Model Number	Overall		Inside Bowl			Cutout in Countertop	Minimum Cabinet Size
	L	W	L	W	D		
MYSTICE2920	28 <sup>5</sup> / <sub>8</sub> (727mm)	19 (483mm)	26 <sup>1</sup> / <sub>8</sub> (664mm)	16 <sup>1</sup> / <sub>2</sub> (419mm)	10 (254mm)	See Template**	33 (838mm)

\*Length is left to right. Width is front to back.

\*\*Template is packed with every sink.

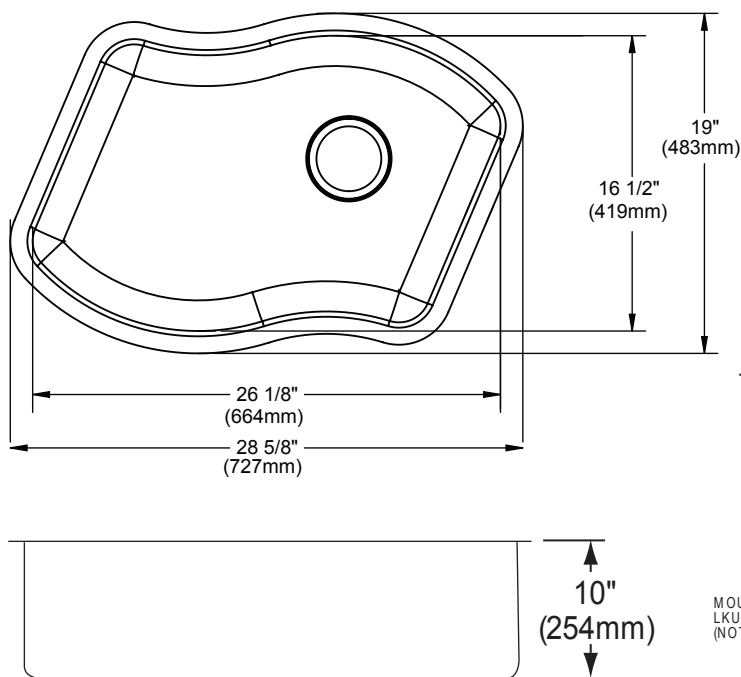

#### Installation Profile

The template provided with each sink provides the only type of installation recommended by Elkay.

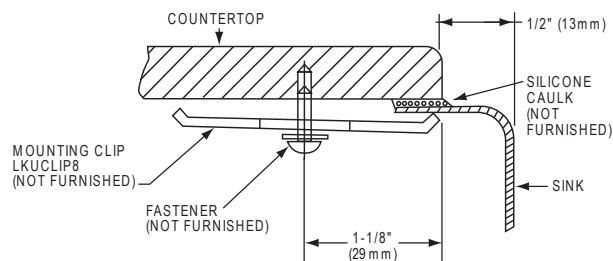

In keeping with our policy of continuing product improvement, Elkay reserves the right to change product specifications without notice. Please visit [elkayusa.com](http://elkayusa.com) for most current version of Elkay product specification sheets.

This specification describes an Elkay product with design, quality and functional benefits to the user. When making a comparison of other producers' offerings, be certain these features are not overlooked.

**Elkay**

[elkayusa.com](http://elkayusa.com)

2222 Camden Court  
Oak Brook, IL 60523

Printed in U.S.A.  
©2010 Elkay

(Rev. 04/10) 1-383

# ELKAY<sup>®</sup>

## SPECIFICATIONS

### The Mystic<sup>®</sup> by Elkay Undermount Sink Model MYSTICE2920

#### OPTIONAL ACCESSORIES

Mounting Clips: LKUCLIP8

Utensil Caddy for Rinsing Basket: LKWUCSS

Drain: LK99

For Additional Accessories see table below

Model Number	Description	Overall			Material/Finish
		L	W	Depth/Thickness	
LKCB2616HW	Cutting Board**	13" (330mm)	17-1/4" (438mm)	1" (25mm)	Hardwood
LKWOBG2616SS	Bottom Grid	25-3/8" (645mm)	15-3/4" (400mm)	1-1/8" (29mm)	Polished Stainless Steel
LKWRB2616SS	Rinsing Basket	24-1/8" (612mm)	14-1/2" (368mm)	5-1/2" (141mm)	Polished Stainless Steel

\*Length is left to right. Width is front to back.

\*\*Sink must be installed with 1/2" reveal for cutting board to fit properly.

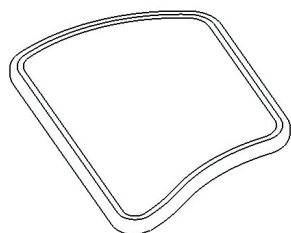

LKCB2616HW

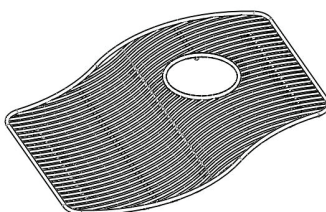

LKWOBG2616SS

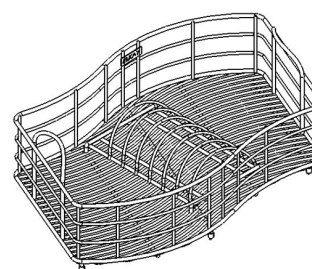

LKWRB2616SS

In keeping with our policy of continuing product improvement, Elkay reserves the right to change product specifications without notice. Please visit [elkayusa.com](http://elkayusa.com) for most current version of Elkay product specification sheets.

This specification describes an Elkay product with design, quality and functional benefits to the user. When making a comparison of other producers' offerings, be certain these features are not overlooked.

**Elkay**

[elkayusa.com](http://elkayusa.com)

2222 Camden Court  
Oak Brook, IL 60523

Printed in U.S.A.  
©2010 Elkay

(Rev. 04/10) 1-383