

ATRIO
Thermostatic Shower Mixer
MODEL # 19167

Pure Freude an Wasser

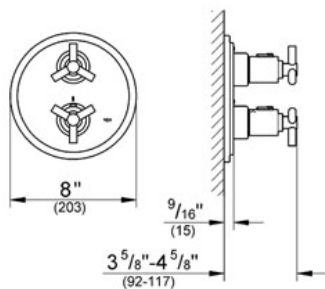

GROHE America, Inc | 200 North Gary Avenue, Suite G, Roselle, IL 60172
Phone: +1 (800) 444-7643 | Fax: +1 (800) 225-2778 | us-customerservice@grohe.com



Product Description:
Thermostatic Shower Mixer

Standard Specification:

Set for final installation for

- For use with GROTHERM Rough-In Valve 34 126
- Without concealed body
- With Ypsilon handle
- Includes trio spoke handle
- Must use with GROTHERM Integrated Rough-In Valve 34 126
- Max Flow Rate 12.6 gpm at 45 psi

Applicable Codes & Standards:

- Energy Policy Act of 1992
- ASME A112.18.1/CSA B125.1

Color:

- ☐ 19167 000 chrome
- ☐ 19167 EN0 Brushed Nickel