

# Installation Instructions / Warranty

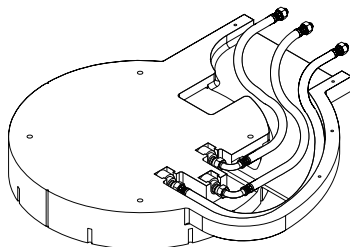

**Rough-in**  
28412181

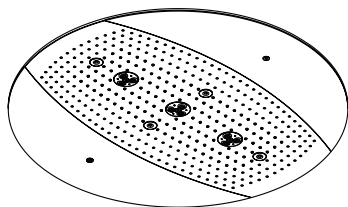

**Raindance Imperial**  
28403001

**hansgrohe**

**Raindance Imperial Rough-in**  
**28412181**

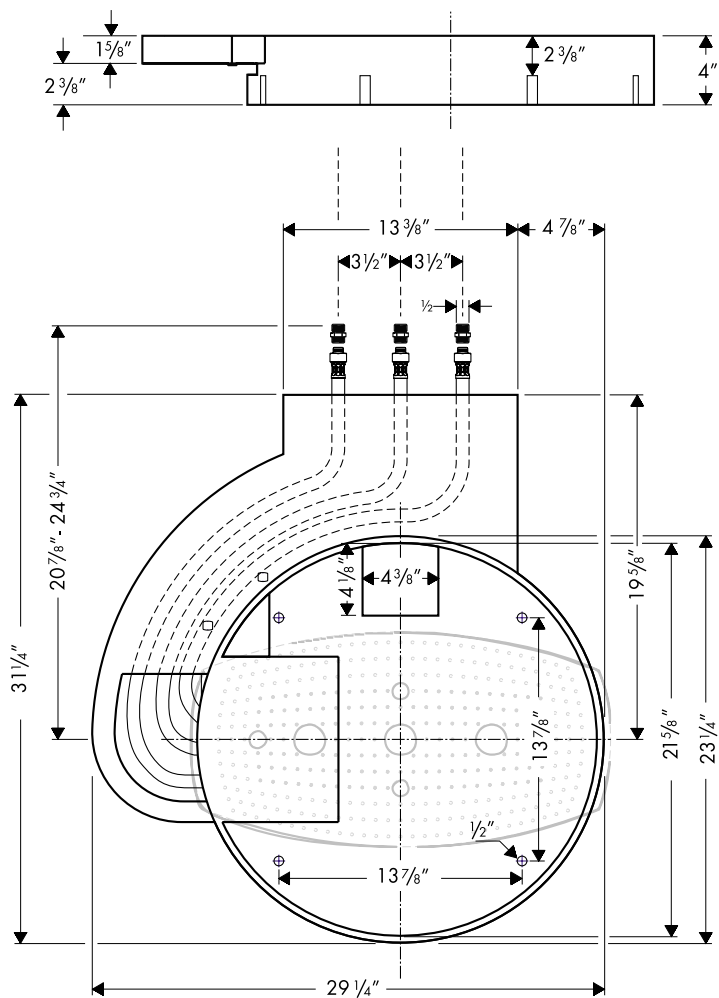

**28412181 Rough-in**

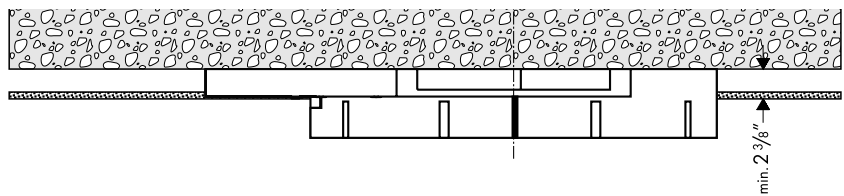

Raindance Imperial  
28403001

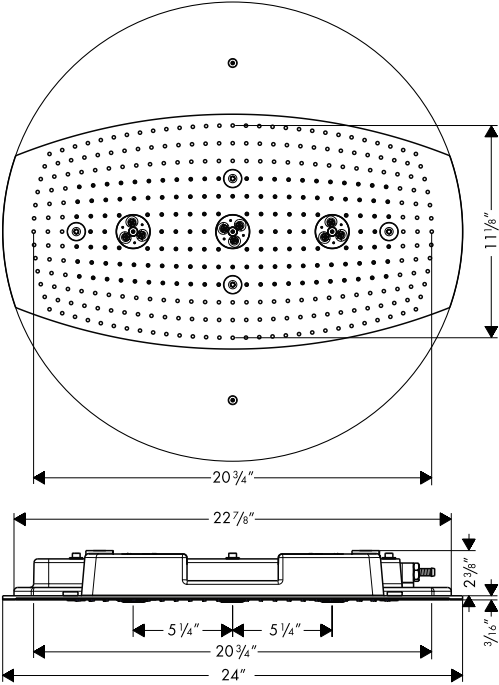

**Suggested Installation**

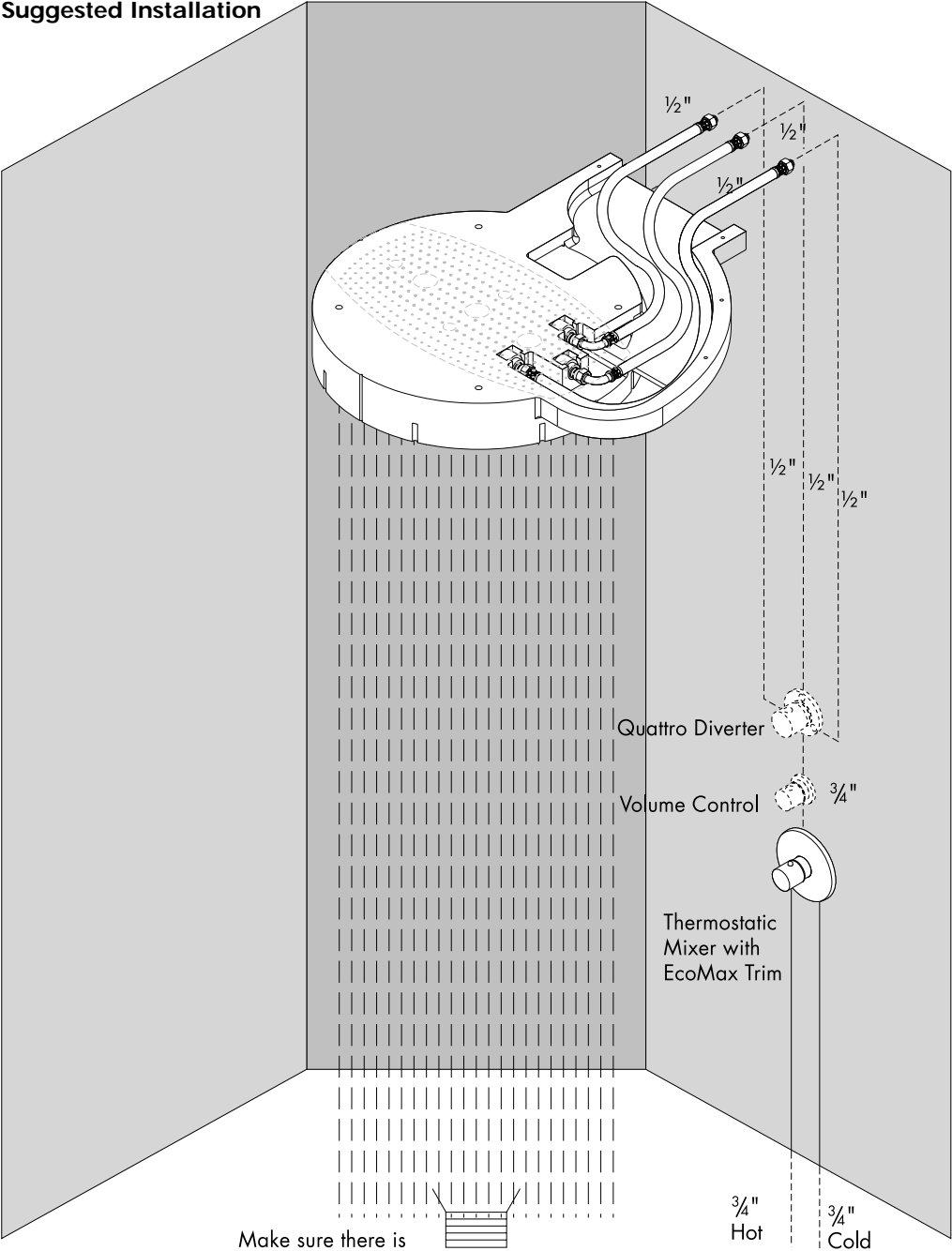

# Raindance Imperial Rough 28412181

## Raindance Imperial 28403001

### Technical Specifications

Spray modes	
Dual Rain	2.5 gpm
Rain Air	2.5 gpm
Whirl Air	2.5 gpm
Recommended incoming water pressure	45 psi

### Installation Considerations:

This unit should be installed with 3/4" Ecostat Thermostatic mixing valve rough 15374181 with EcoMax™ trim, 3/4" volume control rough 13975181 and Quattro diverter rough 13932181. Trim kits are specified and sold separately. Rough valves and trims are not included with the Raindance Imperial.

Additional features, such as a handshower and/or bodysprays, may be added, however, additional volume controls are required.

The Raindance Imperial rough must be installed to the ceiling prior to the installation of the finishing material (tile, marble, etc.).

Install the thermostatic mixer, volume control(s) and Quattro diverter according to the installation instructions. Run three 1/2" lines from outlet ports on the Quattro diverter to supply the Raindance Imperial. At the ends of the lines, attach 1/2" straight connectors, which will connect to the supply lines on the Raindance Imperial rough-in.

Make sure that sufficient drain capacity is provided.

### User Instructions:

- There are no controls on the Raindance Imperial itself.
- In the system shown, the thermostatic mixer controls the temperature of the water. The volume control turns the water on and off. The Quattro diverter allows the bather to select any one of the three shower functions (Dual Rain, Rain Air and Whirl Air) individually, or any two simultaneously.

# Installation Instructions

Position the 28412181 rough-in on the ceiling in the desired location. Mark the positions of the screw holes. Place the rough-in in a safe location.

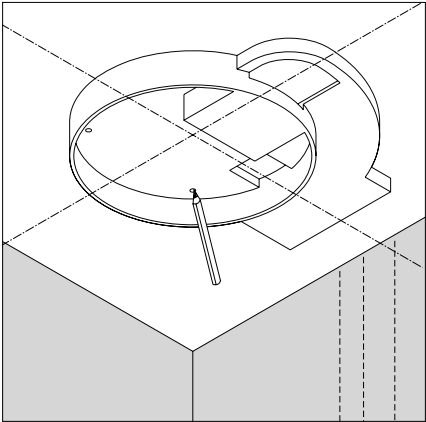
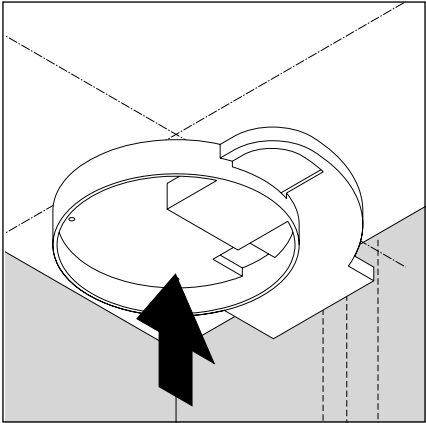

Drill the four holes for the main (“round”) portion of the rough with a 10 mm bit.

Drill the three holes for the supply manifold with a 6 mm bit.

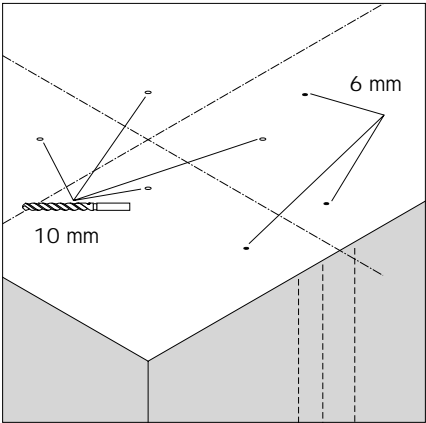

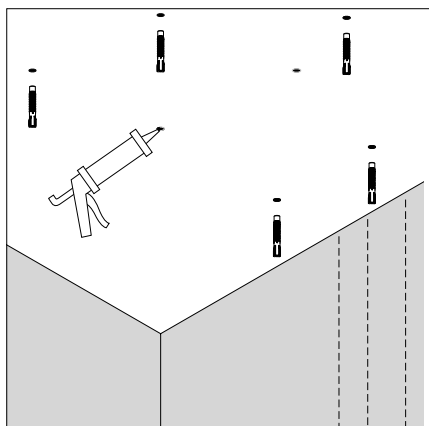

Install the four 10 mm anchors in the ceiling. Seal around them with a waterproof sealant.

Install the three 6 mm anchors in the ceiling. Seal around them with a waterproof sealant.

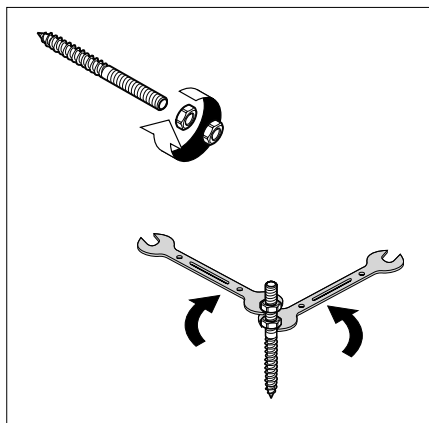

Install the nuts on the four 100 mm anchor bolts. This will make it easier to install the anchor bolts.

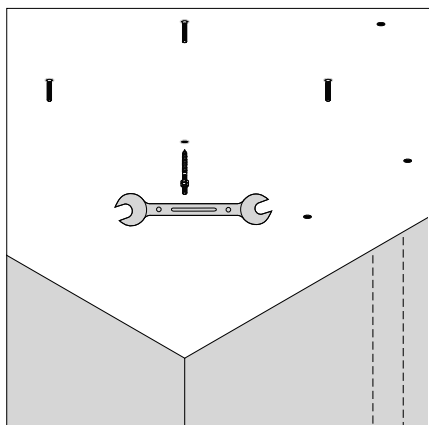

Screw the anchor bolts into the anchors. The anchor bolts should extend outside the mounting surface  $1 \frac{3}{8}$ " – 2" and should be at a 90° angle to the mounting surface. Remove the nuts and put them in a safe place, where they will not be lost.

Install the supply lines to the rough-in.

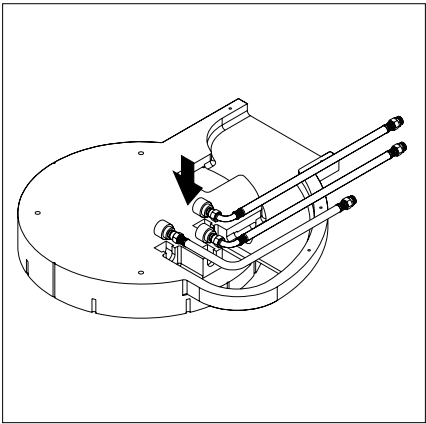

With a helper holding the rough, attach the supply lines and adapters to the connectors.

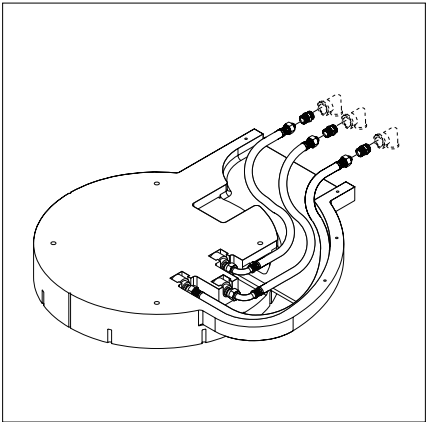

Use washers and nuts to attach the rough-in to the exposed anchor bolts.

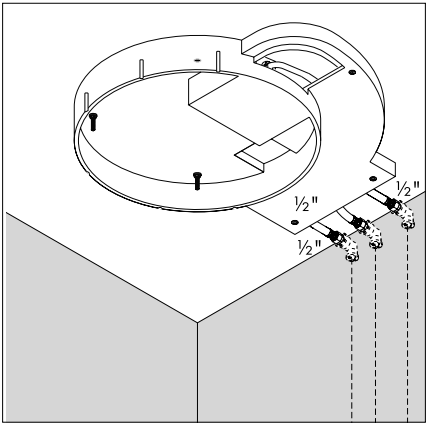



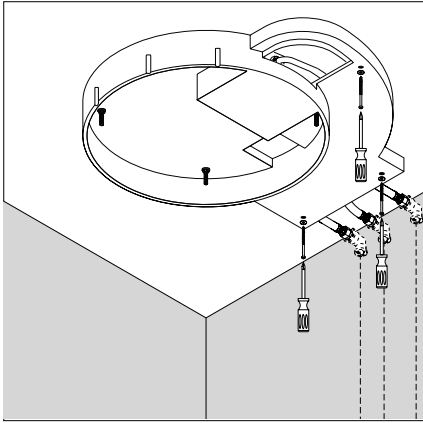

Use three 90 mm screws and washers to attach the manifold section of the rough to the ceiling.

Turn on the water and check the plumbing connections for leaks.

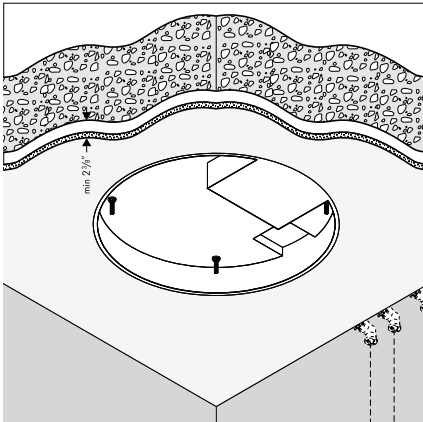

Install the finished ceiling surface.

# Install the 28403000

Use a razor knife or similar tool to cut out the indicated area from the rough-in.

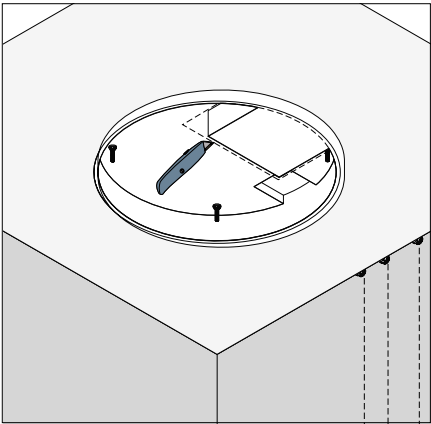

Turn off the water and detach the hoses from the adapters. Remove the adapters.

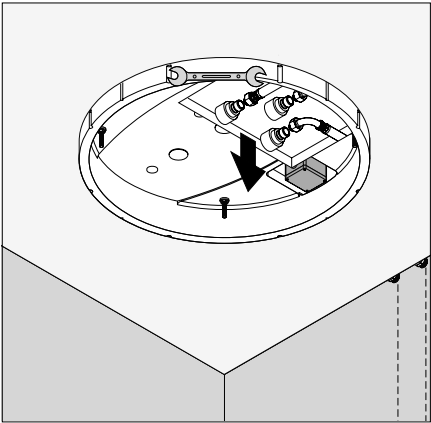

By hand, break away any of the plastic housing extending outside the wall.

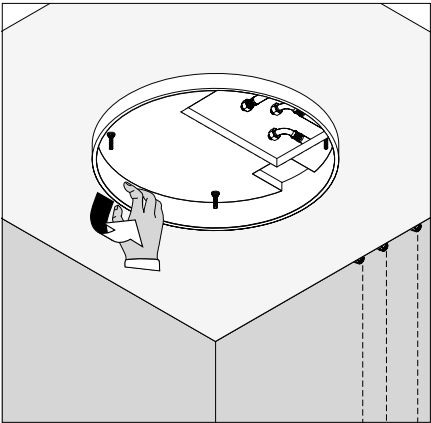

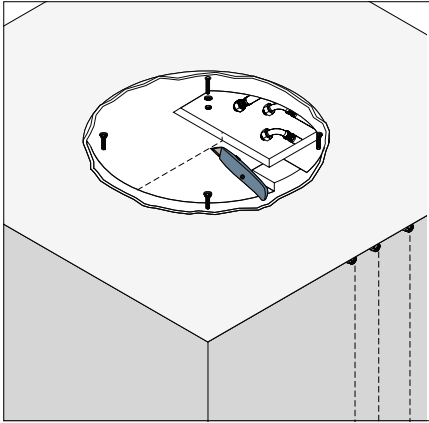

Use a razor knife to cut a straight line through the center knockout.

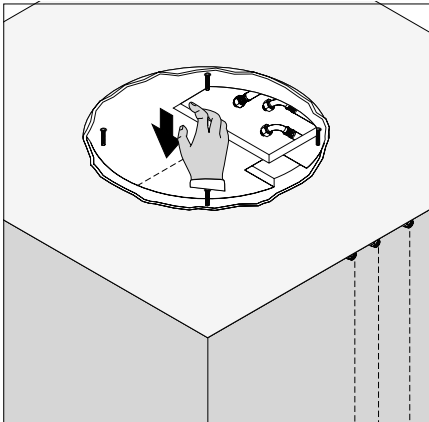

Break away and remove the rest of the knockout. Cut the remainder flush with a razor knife.

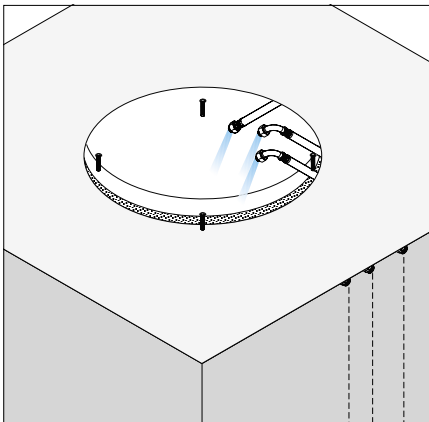

Flush the supply lines thoroughly of debris.

Unscrew the fastening screws on the side panel of the Raindance Imperial with a 3 mm Allen wrench. Do not discard the screws!

Remove the side panels by sliding them out, then up.

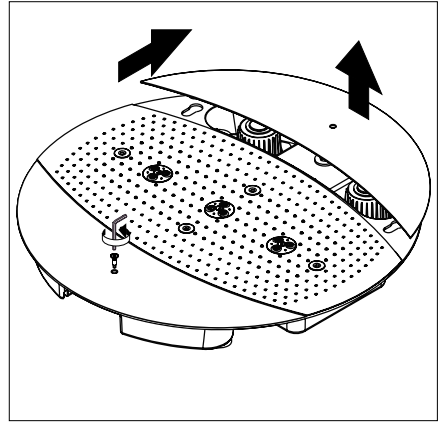

With a helper supporting the Raindance Imperial, attach the supply lines to the inlet ports.

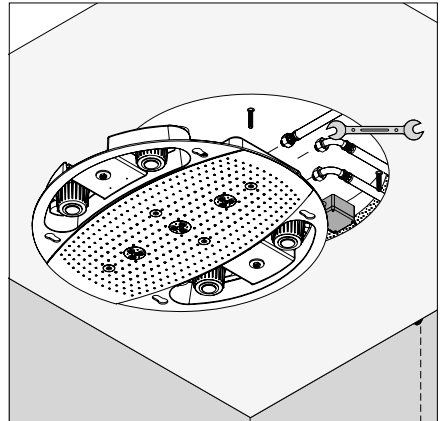

Slide the Raindance Imperial into the rough-in. The rough-in anchor bolts should go through the mounting holes in the Raindance Imperial. Attach the Raindance Imperial to the anchor bolts with the nuts and washers.

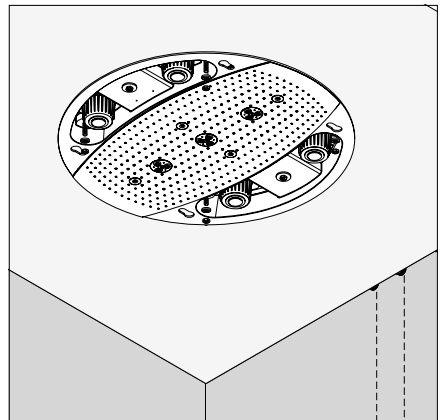

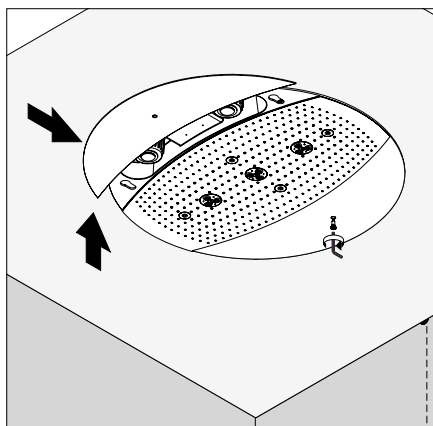

Install the side panels. Attach the fastening screws with a 3mm Allen wrench.

## Replacement Parts

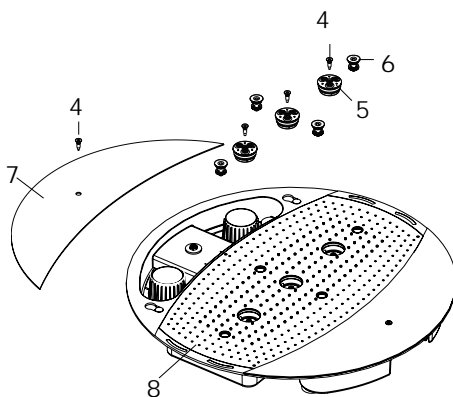
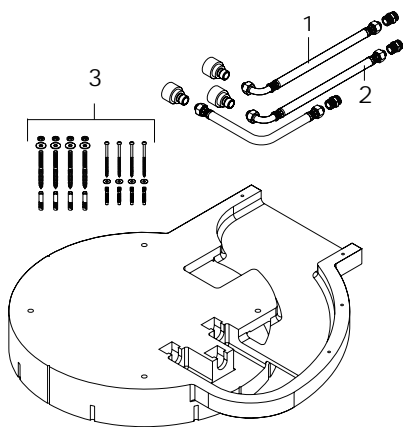

1	800 mm hose	25963000
2	hose	97720000
3	mounting kit	97722000
4	screw	97723000
5	spray body	97724000
6	air jet	97725000
7	side cover	97728000
8	cover	97726000

## Cleaning Recommendation for Hansgrohe Products

Modern faucetry and shower products utilize a combination of materials to comply with the needs of the market with regard to design and functionality.

To avoid damage, it is necessary to use some caution when cleaning. Damage caused by improper treatment is not covered under the Hansgrohe warranty.

### Cleaning Materials for Faucets and Showers

- To remove lime scale, use only products made specifically for that purpose. Always follow the manufacturer's instructions when using.
- Do not use cleaners that contain hydrochloric, formic, acetic, or phosphoric acids, as these will cause considerable damage to finishes and to plastic components.
- Never mix cleaning materials.
- Never use cleaners containing abrasives. Do not use abrasive cleaning cloths, pads, or sponges.

### Cleaning Procedures

- Clean your faucets and shower products as and when required. Regular cleaning will prevent scale buildup and water spotting.
- Follow the label instructions. Do not allow any cleaner to remain on the product for longer than necessary.
- When using spray cleaners, spray first onto a sponge or cloth – do not spray directly onto the product.
- After cleaning, rinse thoroughly with clear water to remove any cleaner residue.

### Important

- Soap and shampoo residue can also cause damage to the product. Rinse well with clean water after use.
- If the surface is already damaged, harsh cleaning materials will cause further damage.

## Limited Lifetime Consumer Warranty

This product has been manufactured and tested to the highest quality standards by Hansgrohe, Inc. ("Hansgrohe"). This warranty is limited to Hansgrohe products which are purchased by a consumer in the United States after March 1, 1996 and installed in either the United States or Canada.

### WHO IS COVERED BY THE WARRANTY

This warranty extends to the original consumer purchaser only.

### WHAT IS COVERED BY THE WARRANTY

This warranty covers only your Hansgrohe manufactured product. Hansgrohe warrants this product against defects in material or workmanship as follows: Hansgrohe will repair at no charge for parts only or, at its option, replace any product or part of the product which proves defective because of improper workmanship and/or material, under normal installation, use, service and maintenance. If Hansgrohe is unable to provide a replacement and repair is not practical or cannot be timely made, Hansgrohe may elect to refund the purchase price in exchange for the return of the product.

### LENGTH OF WARRANTY

Replacement or repaired parts of products will be covered for the term of this warranty as stated in the following two sentences. If you are a consumer who purchased the product for use primarily for personal, family, or household purposes, this warranty extends for as long as you own the product and the home in which the product is installed. If you purchased the product for use primarily for any other purpose, including, without limitation, a commercial purpose, this warranty extends only (i) for 1 year, with respect to Interaktiv and Retroaktiv products and (ii) for 5 years, with respect to AXOR, ShowerPower and Pharo products.

THIS WARRANTY DOES NOT COVER and HANSGROHE WILL NOT PAY FOR:

- A. Conditions, malfunctions or damage not resulting from defects in material or workmanship.
- B. Conditions, malfunctions or damage resulting from (1) improper installation, improper maintenance, misuse, abuse, negligence, accident or alteration, or (2) the use of abrasive or caustic cleaning agents or "no rinse" cleaning products, or the use of the product in any manner contrary to the product instructions.
- C. Labor or other expenses for the disconnection or return of the product for warranty service, or for installation or reinstallation of the product.
- D. Accessories or related products not manufactured by Hansgrohe.

#### TO OBTAIN WARRANTY SERVICE

Contact your Hansgrohe retailer, or write to Technical Service at:

Hansgrohe Inc.  
1492 Bluegrass Lakes Parkway  
Alpharetta GA 30004

Or, call Hansgrohe toll-free at (800) 334-0455.

In requesting warranty service, you will need to provide

- 1. The sales receipt or other evidence of the date and place of purchase.
- 2. A description of the problem.
- 3. Delivery of the product or the defective part, postage prepaid and carefully packed and insured, to Hansgrohe Inc. 1492 Bluegrass Lakes Parkway, Alpharetta, Georgia 30004, Attention: Technical Service, if required by Hansgrohe.

When warranty service is completed, any repaired or replacement product or part will be returned to you postage prepaid.

#### EXCLUSIONS AND LIMITATIONS

REPAIR OR REPLACEMENT (OR, IN LIMITED CIRCUMSTANCES, REFUND OF THE PURCHASE PRICE) AS PROVIDED UNDER THIS WARRANTY IS THE EXCLUSIVE REMEDY OF THE PURCHASER. HANSGROHE NEITHER ASSUMES NOR AUTHORIZES ANY PERSON TO CREATE FOR IT ANY OBLIGATION OR LIABILITY IN CONNECTION WITH THIS PRODUCT.

HANSGROHE SHALL NOT BE LIABLE TO PURCHASER OR ANY PERSON FOR ANY INCIDENTAL, SPECIAL, OR CONSEQUENTIAL DAMAGES, ARISING OUT OF BREACH OF THIS WARRANTY OR ANY IMPLIED WARRANTY (INCLUDING MERCHANTABILITY).

Some States do not allow the exclusion or limitation of incidental or consequential damages, so the above limitation or exclusion may not apply to you.

This warranty gives you specific legal rights and you may have other rights which vary from State to State.

You may be required by law to give us a reasonable opportunity to correct or cure any failure to comply before you can bring any action in court against us under the Magnuson-Moss Warranty Act.

#### PRODUCT INSTRUCTIONS AND QUESTIONS

Upon purchase or prior to installation, please carefully inspect your Hansgrohe product for any damage or visible defect. Prior to installing, always carefully study the enclosed instructions on the proper installation and the care and maintenance of the product. If you have questions at any time about the use, installation, or performance of your Hansgrohe product, or this warranty, please call or write to us at the toll-free number and address printed above.

**hansgrohe**

Hansgrohe, Inc. • 1490 Bluegrass Lakes Parkway • Alpharetta, GA 30004  
Tel. 770 360-9880 • Fax 770 360 9887

[www.hansgrohe-USA.com](http://www.hansgrohe-USA.com)