

Before Installing:

1. Master switch can only be used in association with Kichler® Cabinet Lighting fixtures and accessories.

Installation:

1. A. Determine best location for master switch. Cord length will determine maximum distance from outlet. Be sure to leave enough slack to route cable along cabinet bottom.

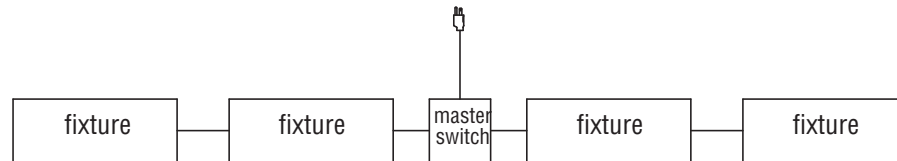

- B. Mounting surface should be a minimum of 1/2" thick and approximately a minimum of 2 1/2" between side of master switch and cabinet side..
- C. Connections to fixtures should be done using connectors on each side of master switch and using either interconnect cables or direct connect to fixtures.
- D. Interconnect cables are not intended for use through or concealed behind walls, floors or ceilings.

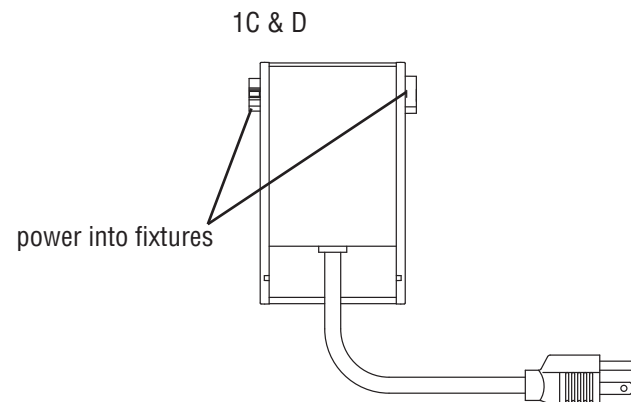

2. Remove cover from master switch.
3. Locate master switch position or connect directly to Kichler Cabinet Lighting fixture then drive provided screw through slot inside master switch and into mounting surface until master switch is secure. If screw is difficult to install drill a 1/16" maximum pilot hole.
4. Reassemble cover to master switch using provided screws.
5. If not using direct connect method, connect master switch to Kichler Cabinet Lighting fixture(s) using interconnect cable(s).
6. Hold switch cable to mounting surface and determine best path for cable. If switch cable is being run from cabinet to cabinet a notch such as a "V" could be cut in cabinet side panels to help keep cable out of sight.
7. Peel backing off retaining clip(s) and affix to desired location(s). Surface should be as clean as possible.
8. Slip cable into clip(s) and snap closed.
9. Use connector cover(s) over connector(s) not being used.
10. Plug master switch plug into wall outlet.

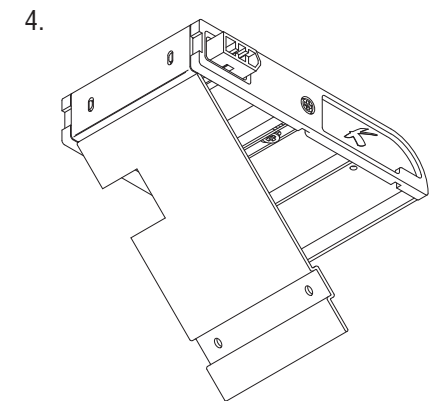
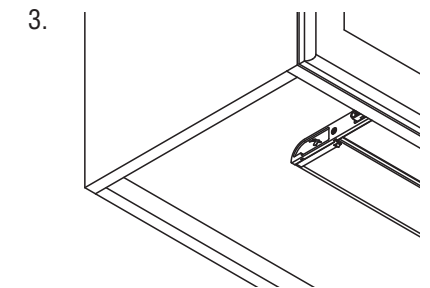
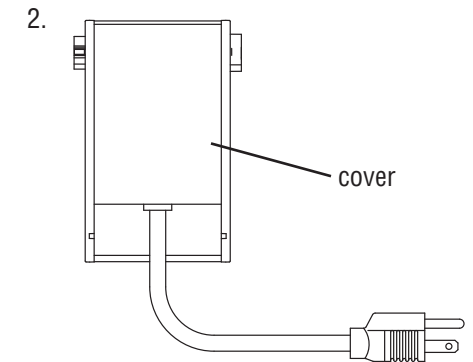
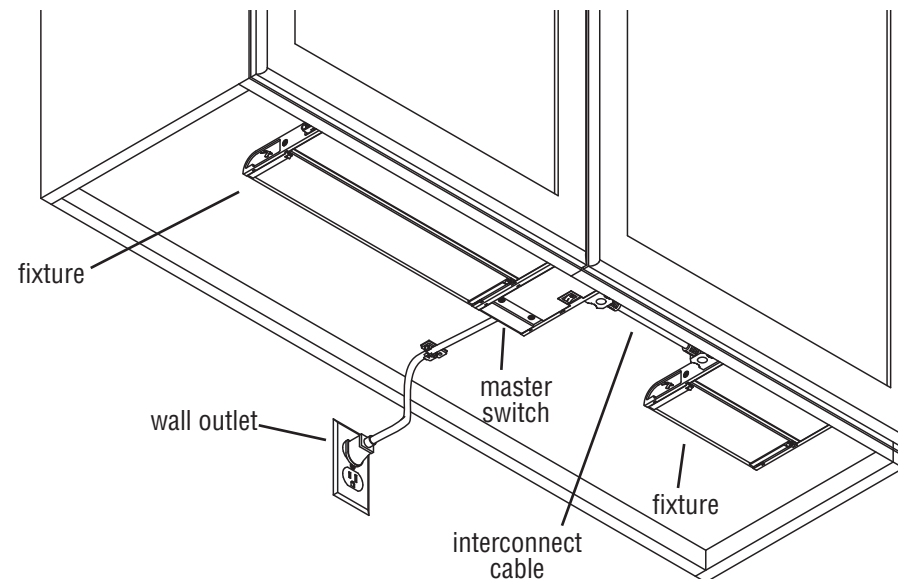

KICHLER 
LIGHTING