

Product Information

Applicable product:	
5' bath whirlpool	K-1337-H
Recommended accessories:	
Drain	K-7166-AF

Fixture*:	
Basin area:	
Bathing well	42" (1067 mm) x 28" (711 mm)
Top area	55" (1397 mm) x 40" (1016 mm)
To overflow:	
Water depth	15-1/2" (394 mm)
Capacity	73 gal (276.3 L)
Weight	115 lbs (52 kg)
* Approximate measurements for comparison only.	

Pump:	V	Hz	A
1-speed	120	60	7.5
Heater:	kW	V	Hz
	1.5	120	60
		A	12.5

Included components:	
Cutout template	1017044-7

Required Electrical Service

Two dedicated circuits required, each protected with Class A Ground-Fault Circuit-Interrupter (GFCI):	
Pump/control	120 V, 15 A, 60 Hz
Heater	120 V, 15 A, 60 Hz
Locate the outlets behind the whirlpool and within 24" (610 mm) of the pump and heater.	

Installation Notes

Install this product according to the installation guide.

Floor support under whirlpool must provide for a minimum of 43 lbs/square foot (208 kg/square meter) loading.

Provide pump/control access in either location shown; supplies must not interfere with pump/control access.

Fixture conforms to CSA B45.5/IAPMO Z124. All dimensions are nominal.

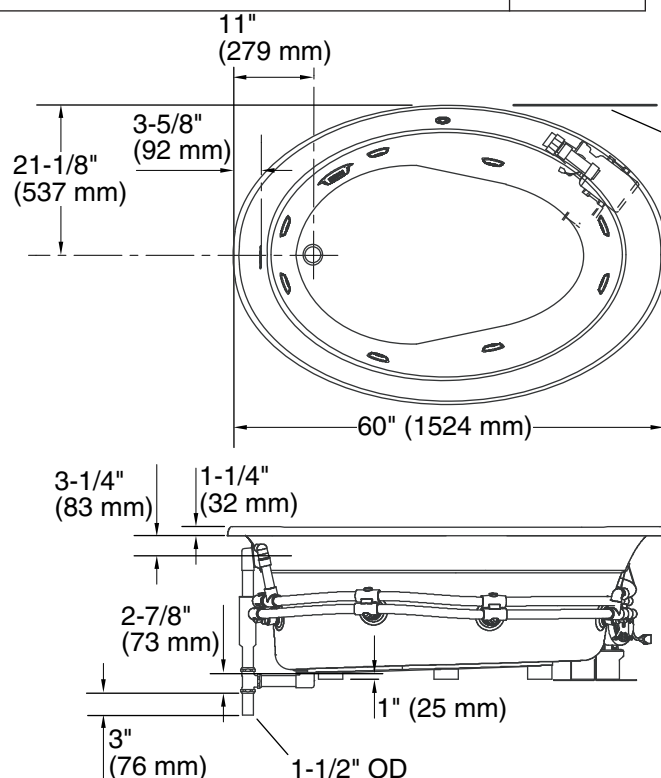

No change in measurements if connected with drain illustrated.

Pump/Control Access
20" (508 mm) W x
5" (381 mm) H

