



Escale®

6' Bath

K-11343



Features

- Center drain.
- Integral lumbar support.
- Coordinates with other products in the Escale collection.
- 71-5/8" (1819 mm) x 35-5/8" (905 mm) x 24-1/8" (613 mm)

Material

- Acrylic

Installation

- Drop-in

Recommended Accessories

K-7214 27" Cable Bath Drain
K-7219 Bath Drain
18486
K-1601 Bath/Whirlpool Footstop
K-1676 Bath/Pillow
K-24916 Wireless Music Kit
K-922
K-923 Bath Filler
K-924
K-7213 27" Cable Bath Drain
K-7265 Clearflo Bath Drain



Codes/Standards

CSA B45.5/IAPMO Z124
Greenguard UL 2818 - Gold



KOHLER® One-Year Limited Warranty

See website for detailed warranty information.

Available Color/Finishes

Color tiles intended for reference only.

Color	Code	Description
-------	------	-------------

	0	White
	96	Biscuit
	47	Almond

USA/Canada: 1-800-4KOHLER (1-800-456-4537)

Kohler Co. reserves the right to make revisions without notice to product specifications.

For the most current Specification Sheet, go to www.kohler.com.

12-20-2016 03:07

THE BOLD LOOK
OF **KOHLER®**

No change in measurements if connected with drain illustrated. (K-7214)

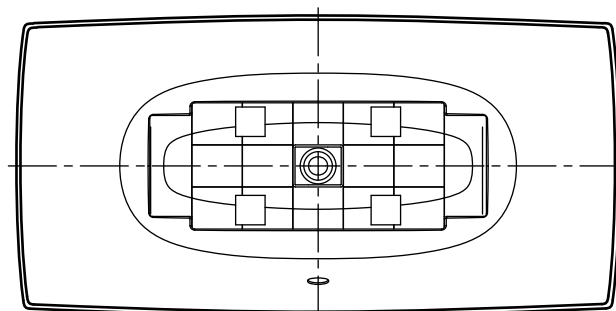
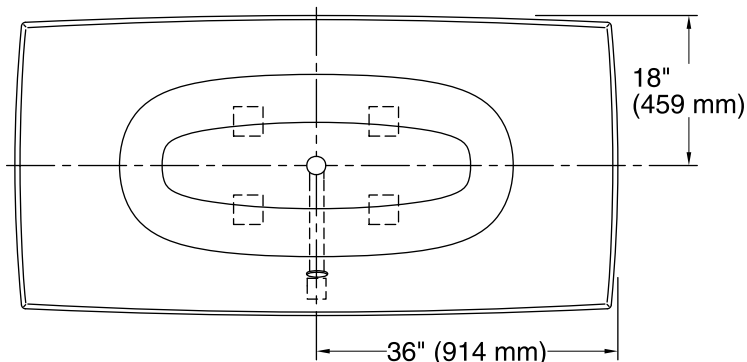

Bottom View

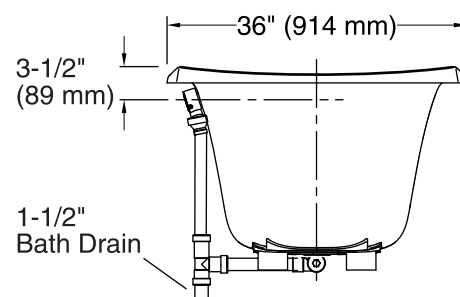
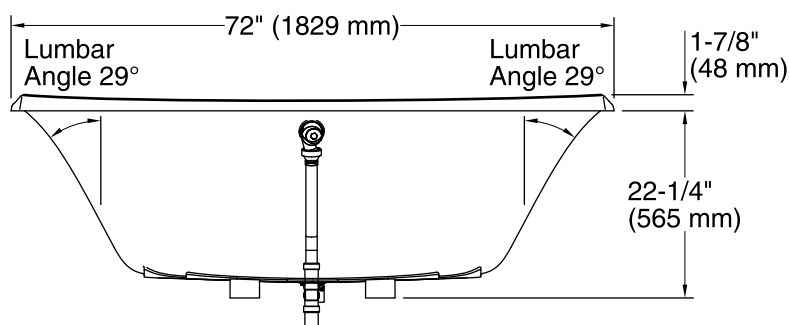

Technical Information

All product dimensions are nominal.

Installation:	Drop-in
Drain location:	Center
Basin area, bottom:	46-3/4" x 21-5/8" (1187 mm x 549 mm)
Basin area, top:	69-15/16" x 34-3/8" (1776 mm x 873 mm)
Weight:	68 lbs (30.8 kg)
Minimum floor load:	42 lbs/ft ² (205.1 kg/m ²)
Water depth:	16-1/2" (419 mm)
Water capacity:	71 gal (268.8 L)
Template:	Drop-in, 1054544-7, required, included
Minimum flat for door:	0" (0 mm)

Notes

Measure your actual product for rough-in details.

Install this product according to the installation instructions.

The hot water supply should be 70% of the capacity of the bath or greater. Installations will vary.

This bath is designed for drop-in installation only. It is not suited for use in a three wall alcove with an overhead shower.