



**Brenham™**  
Wall-Mount Bathroom Sink  
**K-1997-4N**

**Features**

- With hanger.
- Without overflow.
- Drilled for concealed arm carrier
- 4 " (102 mm) centers.
- 21-15/16 " (557 mm) x 19-3/4 " (502 mm)

**Material**

- Vitreous china.

**Installation**

- Wall-mount installation.

**Optional Accessories**

K-8998 P-Trap  
K-1998 Shroud

**Components**

Additional included component/s: Hanger (2 required).



ADA

CSA B651

OBC

**Codes/Standards**

ASME A112.19.2/CSA B45.1  
ADA  
ICC/ANSI A117.1  
CSA B651  
OBC

See website for detailed warranty information.

**Available Color/Finishes**

*Color tiles intended for reference only.*

**Color Code Description**



0 White

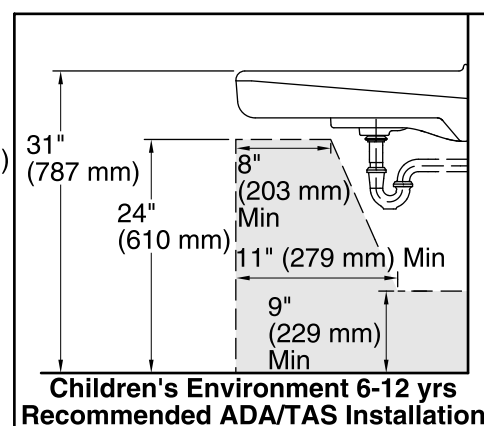
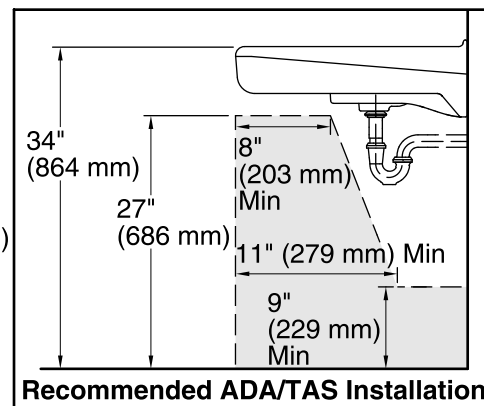
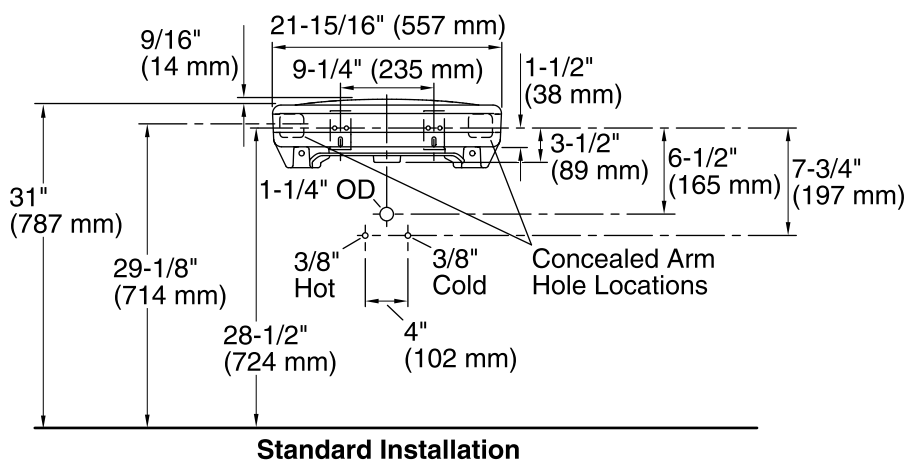
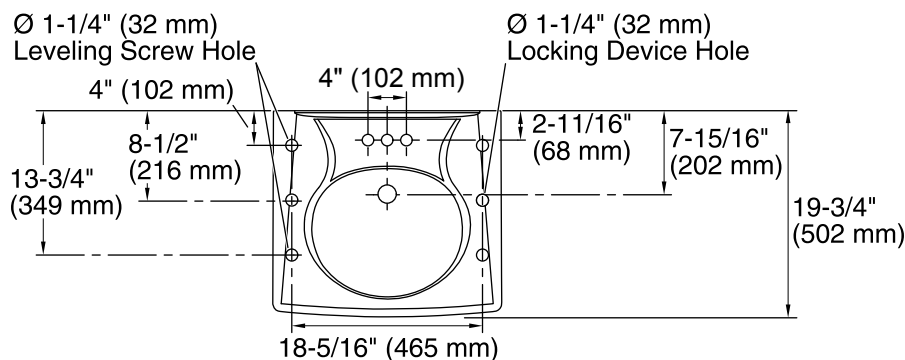

## Technical Information

All product dimensions are nominal.

Bowl configuration: Single

Installation: Wall-mount

Bowl area (Only) Length: 14-3/8" (365 mm)  
Width: 12-5/16" (313 mm)  
With overflow: Yes  
Water depth: 3-1/4" (83 mm)

Bowl area With overflow: Yes

Number of deck holes: 3

Faucet hole(s): 1-1/4" (32 mm)

Drain hole: 1-3/4" (44 mm)

## Notes

Install this product according to the installation instructions.

ADA, OBC, CSA B651 compliant when installed to the specific requirements of these regulations.