

Features

- Catalyzed polyurethane provides a durable moisture-resistant finish.
- Double doors with adjustable hinges.
- Two pullout storage extensions, each with adjustable shelf.
- Includes cabinet hardware.
- Express™ vanities are easy to transport and set up in minutes.

Material

- Ailanthus solids and quarter-sawn ash veneers.

Recommended Accessories

K-2209 Bathroom Sink
K-3053-1 Vanity-top Bathroom Sink
K-3053-4 Vanity-top Bathroom Sink
K-3053-8 Vanity-top Bathroom Sink

Optional Accessories

K-2509 Mirror



Codes/Standards

CARB P2

KOHLER® One-Year Limited Warranty

See website for detailed warranty information.

Available Color/Finishes

Color tiles intended for reference only.

Color	Code	Description
-------	------	-------------



F39	Oxford
-----	--------

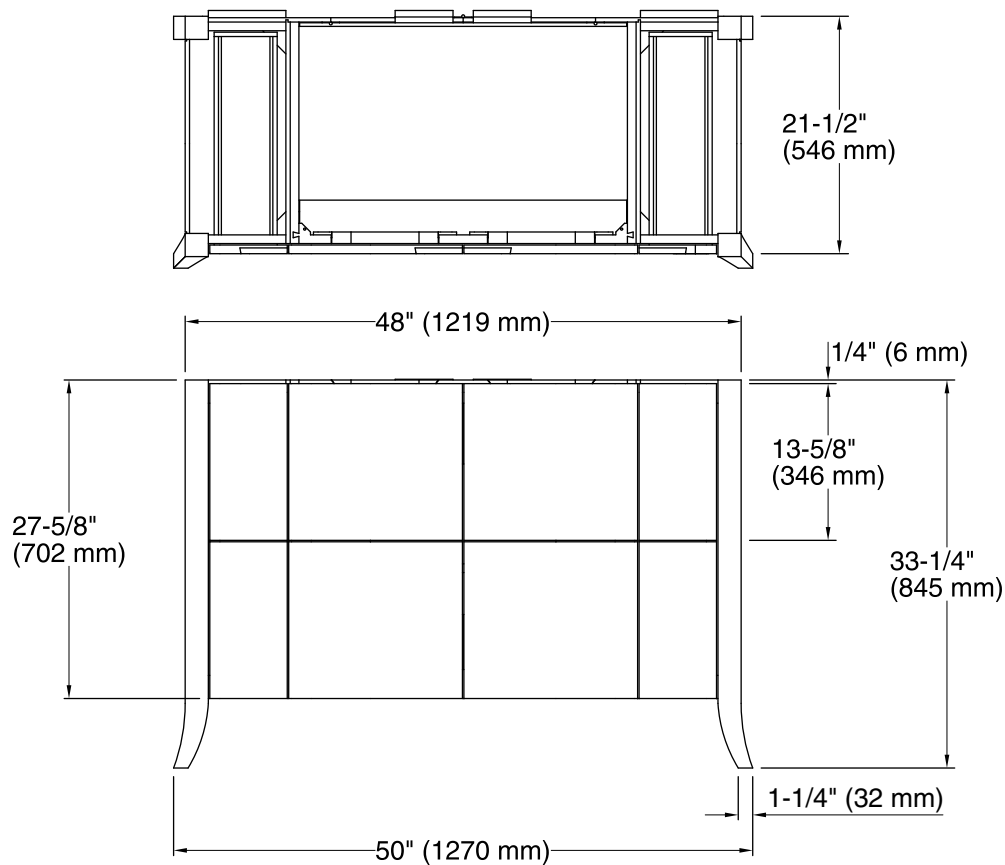

Technical Information

All product dimensions are nominal.

Notes

Install this product according to the installation guide.