



**Octave®**  
Top-mount Kitchen Sink  
**K-3844-3**

**Features**

- 36-inch minimum base cabinet width.
- 18-gauge stainless steel.
- Top-mount.
- Large/medium bowl.
- Three faucet holes.
- With SilentShield® sound-absorption technology.
- 33" (838 mm) x 22" (559 mm)

**Optional Accessories**

K-6485 Sink Rack  
K-8801 Sink Strainer  
1177161 Installation Clip Kit

**Components**

Product includes:  
K-6139 Sponge Caddy  
K-6484 Sink Rack  
1177160 Hardware Kit, Top-mount



**Codes/Standards**

ASME A112.19.3/CSA B45.4

**Lifetime Limited Warranty for  
KOHLER® Stainless Steel Sinks**

See website for detailed warranty information.

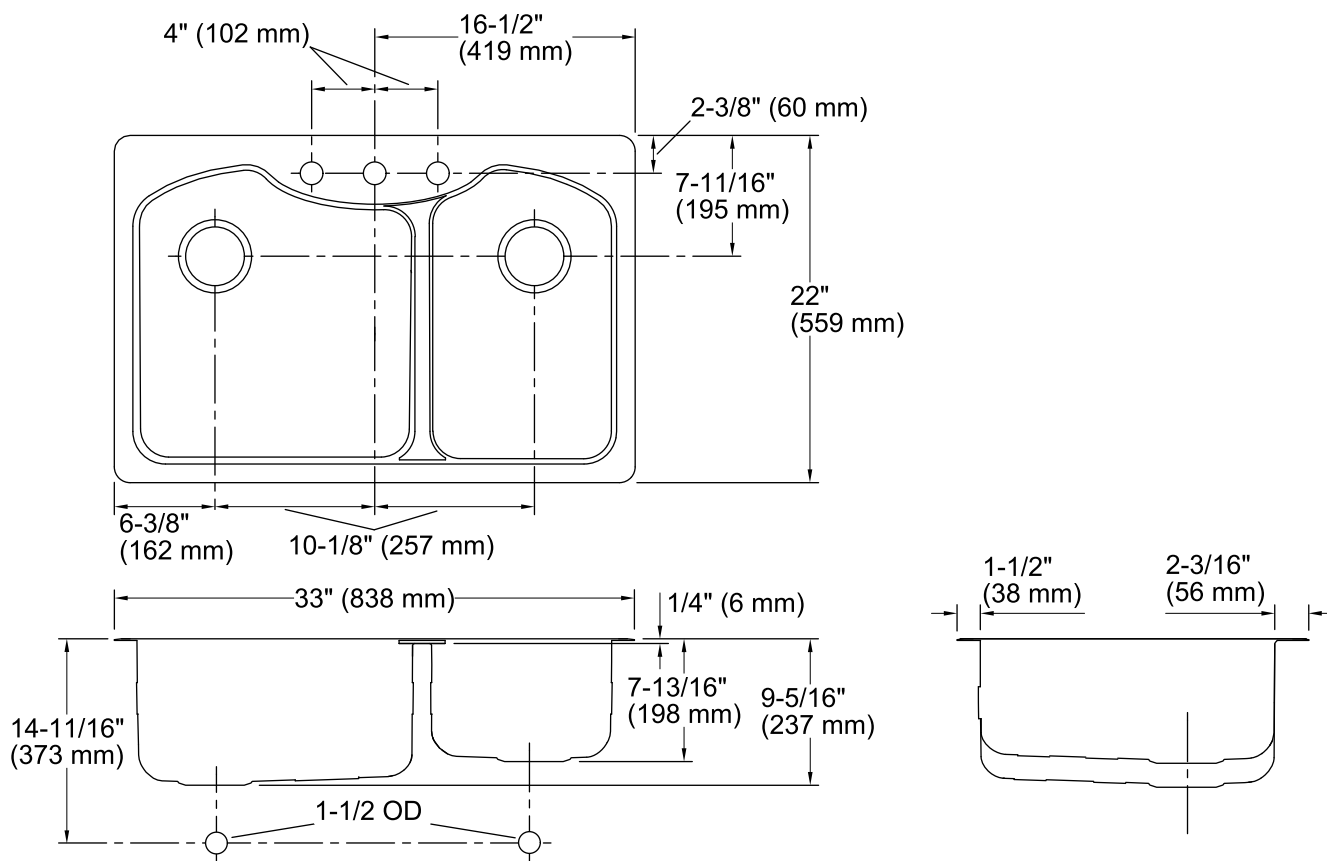

## Technical Information

All product dimensions are nominal.

Bowl configuration: Large/medium

Installation: Top-mount

Cutout: Top-mount, 32-1/2" x 21-1/2" (826 mm x 546 mm) with 1/2" (13 mm) radius corners

Bowl area (Left) Length: 17-3/8" (441 mm)

Width: 18-5/16" (465 mm)

Water depth: 9" (229 mm)

Bowl area (Right) Length: 11-5/16" (287 mm)

Width: 18-5/16" (465 mm)

Water depth: 9" (229 mm)

Number of deck holes: 3

Faucet hole(s): 1-7/16" (37 mm)

Drain hole: 3-5/8" (92 mm)

## Notes

Install this product according to the installation instructions.