

### Features

- Vitreous china.
- Two-piece toilet.
- Comfort Height® Elongated bowl.
- Class Five® flushing system.
- Includes left-hand polished chrome trip lever.
- 1.28 gpf (4.8 lpf).
- 2-1/8" (54 mm) fully glazed trapway.
- 14" (356 mm) rough-in.
- Less seat and supply.
- 11-3/8" (289 mm) x 8" (203 mm) water area.
- 31-5/8" (803 mm) x 18-1/4" (464 mm) x 30-3/4" (781 mm).
- Floor mount / Floor outlet.
- Insuliner® tank liner included.
- Tank cover locks included.

### Optional Accessories

K-4008 Toilet Seat  
 K-4108 Toilet Seat with Cleansing Functionality  
 K-4636 Toilet Seat  
 K-4652 Toilet Seat  
 K-4659 Toilet Seat  
 K-4684 Toilet Seat  
 K-4688 Toilet Seat  
 K-4694 Toilet Seat  
 K-4709 Toilet Seat with Cleansing Functionality  
 K-4732 Toilet Seat  
 K-4733 Toilet Seat  
 K-4737 Toilet Seat with Cleansing Functionality  
 K-4748 Toilet Seat  
 K-4774 Toilet Seat  
 K-4814 Toilet Seat  
 K-4888 Elongated Toilet Seat  
 K-5588 Elongated Toilet Seat  
 K-5638 Elongated Toilet Seat  
 K-7637 Angle Supply with Stop (single)  
 K-9379 Trip Lever  
 K-4712-T Toilet Seat  
 K-4731-C Commercial Heavy-duty Toilet Seat  
 K-4761-BN Toilet Seat  
 K-4761-CP Toilet Seat

### Components

Product includes:

K-4199 Comfort Height® Elongated Bowl  
 K-4841-UT Toilet Tank

Additional included component/s: Tank cover, Trip lever, Bolt cap accessory pack, and Tank accessory pack.



ADA

CSA B651

OBC

### Codes/Standards

ASME A112.19.2/CSA B45.1  
 DOE - Energy Policy Act 1992  
 EPA WaterSense®  
 California Energy Commission (CEC)  
 ADA  
 ICC/ANSI A117.1  
 CSA B651  
 OBC



### KOHLER® One-Year Limited Warranty

See website for detailed warranty information.

### Available Color/Finishes

*Color tiles intended for reference only.*

#### Color Code Description

	0	White
	96	Biscuit
	47	Almond

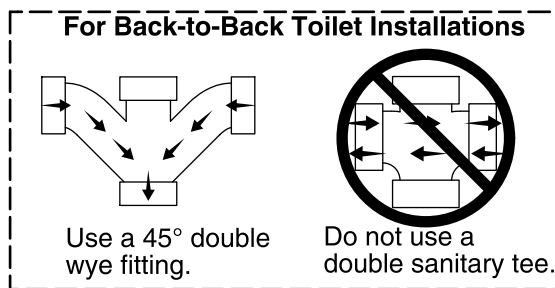
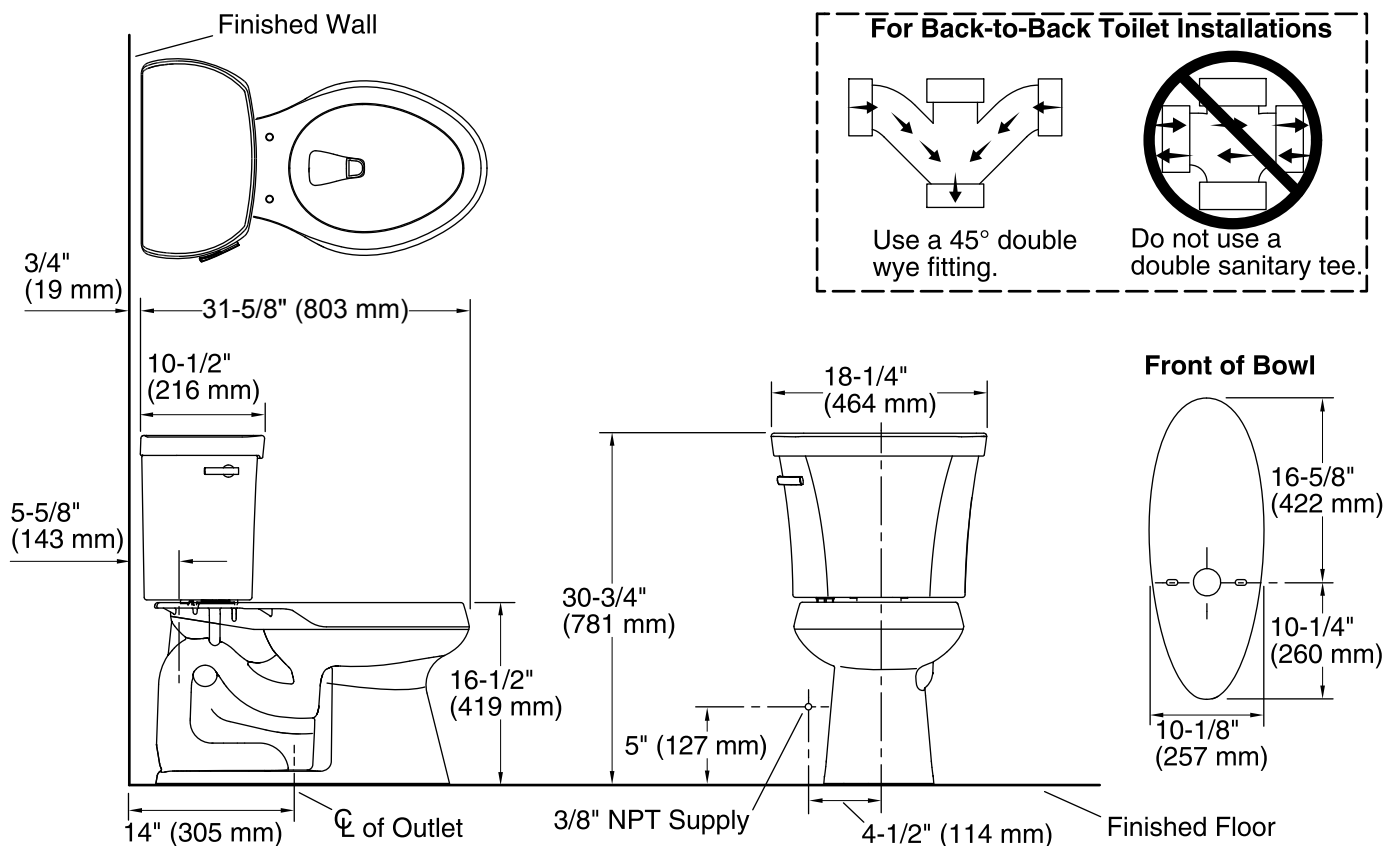

## Technical Information

All product dimensions are nominal.

Toilet type:	Two-piece, Floor-mount
Waste Outlet:	Floor
Bowl shape:	Elongated front
Flush type:	Class Five
Trap passageway:	2-1/8" (54 mm)
Water Consumption	
Full:	1.28 gpf (4.8 lpf)
Water surface size:	11-3/8" x 8" (289 mm x 203 mm)
Rim to water surface:	5-3/8" (137 mm)
Rough-in:	14" (356 mm)
Seat-mounting holes:	5-1/2" (140 mm)

## Notes

Install this product according to the installation instructions.

For back-to-back toilet installations: Use only a 45° double wye fitting.

ADA, OBC, CSA B651 compliant when installed to the specific requirements of these regulations.

The Model Plumbing Codes require the installation of elongated open-front toilet seats on public bathrooms.