



**Bakersfield™**  
Top-mount Kitchen Sink  
**K-5832-3**

**Features**

- 30-inch minimum base cabinet width.
- KOHLER cast iron.
- Acid-resistant enamel finish.
- Single bowl.
- Top-mount.
- Three faucet holes.
- 31" (787 mm) x 22" (559 mm)

**Recommended Accessories**

K-9000 P-Trap

**Optional Accessories**

K-5836 Cutting Board

K-6517 Sink Rack

K-8801 Sink Strainer



**Codes/Standards**

ASME A112.19.1/CSA B45.2

**KOHLER® Enameled Cast Iron Kitchen Sink - Lifetime Limited Warranty**

See website for detailed warranty information.

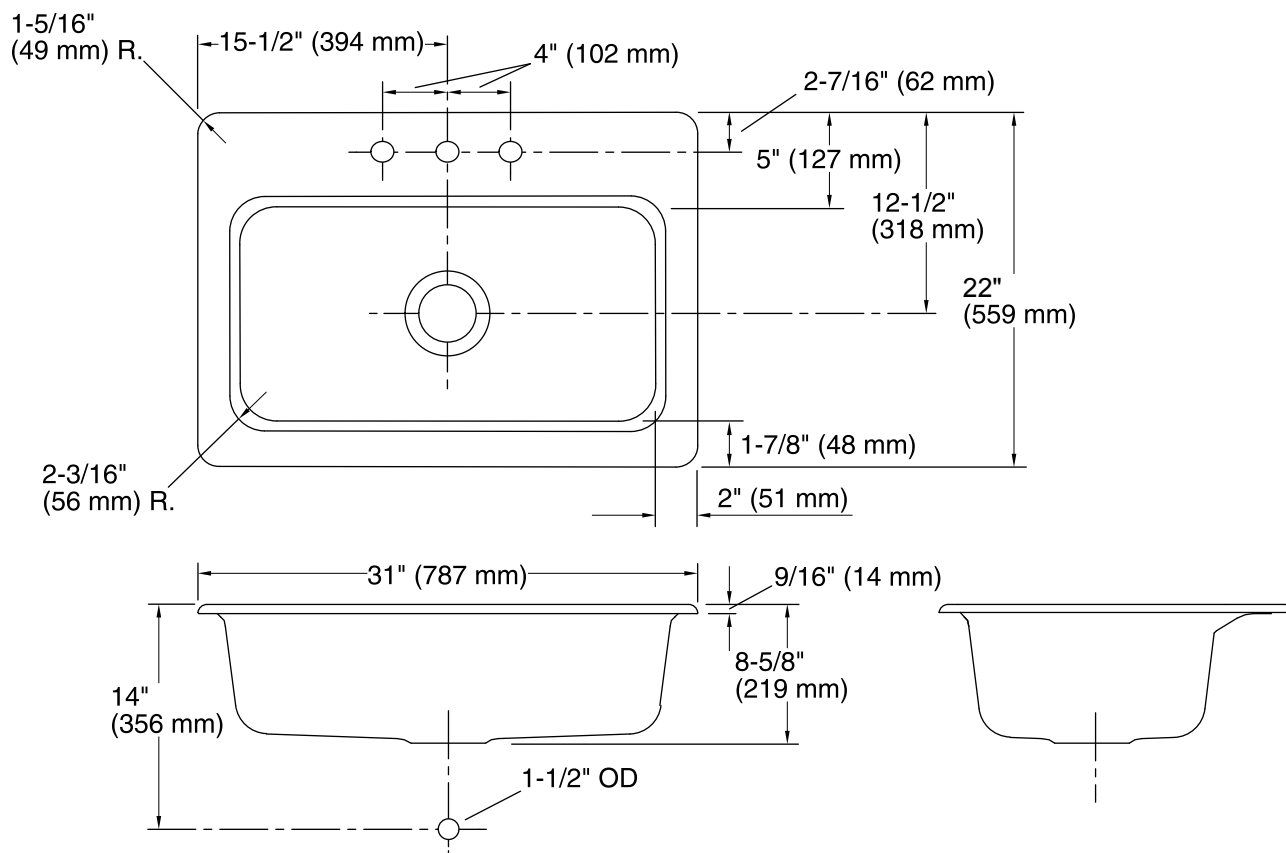

## Technical Information

All product dimensions are nominal.

Bowl configuration: Single

Installation: Top-mount

Cutout: Top-mount, 29-3/4" x 20-3/4" (756 mm x 527 mm) with 1" (25 mm) radius corners

Bowl area (Only) Length: 27" (686 mm)  
Width: 15" (381 mm)  
Bowl depth: 8" (203 mm)

Number of deck holes: 3

Faucet hole(s): 1-3/8" (35 mm)

Drain hole: 3-5/8" (92 mm)

## Notes

Install this product according to the installation instructions.

Cut-out is 29-3/4" (756 mm) by 20-3/4" (527 mm) with 1" (25 mm) radius corners.