



# Sunward®

## 5.5' Whirlpool Bath

### K-6347-HB



#### Features

- End drain.
- Textured bottom surface.
- Multiple pump location options give you more choices for installation and access.
- Integral lumbar support and armrests for comfort.
- 20" (508 mm) x 66" (1676 mm) x 42" (1067 mm)

#### Material

- Acrylic

#### Hydrotherapy

- Single-speed whirlpool offers 6 fully adjustable hydro-massage jets for water flow and direction.
- Built-in 1500W heater.

#### Installation

- Drop-in or under-mount.

#### Required Accessories

K-11677 Bath Drain  
738

#### Recommended Accessories

K-24916 Wireless Music Kit (Qty 2)



#### Codes/Standards

ASME A112.19.7/CSA B45.10  
CSA B45.5/IAPMO Z124  
UL 1795  
Greenguard UL 2818 - Gold  
CARB P2



#### KOHLER® One-Year Limited Warranty

See website for detailed warranty information.

#### Available Color/Finishes

*Color tiles intended for reference only.*

Color	Code	Description
-------	------	-------------

	0	White
	96	Biscuit
	47	Almond

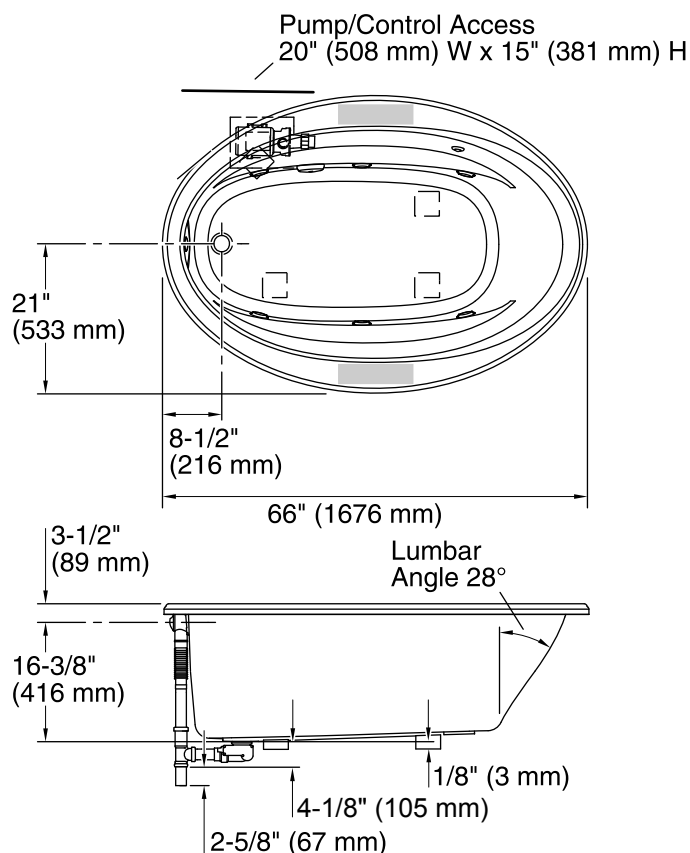

No change in measurements if connected with drain illustrated. (K-37382)

Recommended faucet area

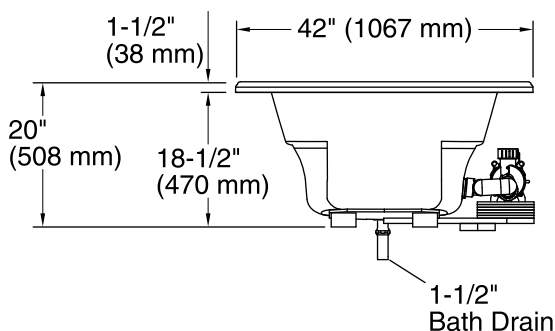
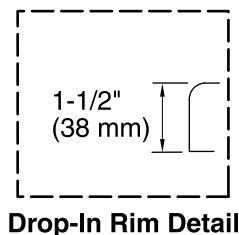

## Required Electrical Service

Two dedicated circuits required, protected with Class A Ground-Fault Circuit-Interrupter (GFCI) or Residual Current Device (RCD).

Pump: 120 V, 15 A, 60 Hz

## Technical Information

All product dimensions are nominal.

Installation: Drop-in, Under-mount  
Drain location: End  
Basin area, bottom: 48-5/8" x 24-1/2" (1235 mm x 622 mm)  
Basin area, top: 60" x 32-3/16" (1523 mm x 818 mm)  
Minimum floor load: 34 lbs/ft² (166 kg/m²)  
Water depth: 14-5/16" (364 mm)  
Water capacity: 70 gal (265 L)  
Template: Drop-in, 1233384-7, not required, included  
Electrical component rating: Pump: 120 V, 7.5 A, 60 Hz  
Heater: 120 V, 12.5 A, 60 Hz, 1500 W  
Pump speed: Single  
Minimum flat for door: 0" (0 mm)

## Notes

Measure your actual product for rough-in details.

Install this product according to the installation instructions.

The hot water supply should be 70% of the capacity of the bath or greater. Installations will vary.

Provide one grounded electrical outlet within 24" (610 mm) of each component.