

## Features

- Brass construction.
- Brass valve bodies.
- Quarter-turn washerless ceramic disc valves.
- 5" (127 mm) spout reach.
- Less drain.
- 8" (203 mm) rigid connections.
- Vandal-resistant aerator.
- Variety of handle style options.
- 0.5 gal/min (1.9 l/min) maximum flow rate [max at 60 psi (4.14 bar)].

## Required Accessories

- K-16012-2 Standard Handles for Widespread Base Faucet  
**or**  
K-16012-3 Cross Handles for Widespread Base Faucet  
**or**  
K-16012-4 Lever Handles for Widespread Base Faucet  
**or**  
K-16012-5 Wristblade Handles for Widespread Base Faucet



## Codes/Standards

ASME A112.18.1/CSA B125.1  
NSF 61  
NSF 372  
All applicable US Federal and State material regulations  
DOE - Energy Policy Act 1992  
California Energy Commission (CEC)

## KOHLER® Faucet Lifetime Limited Warranty

See website for detailed warranty information.

## Available Color/Finishes

*Color tiles intended for reference only.*

Color	Code	Description
-------	------	-------------

	CP	Polished Chrome
--	----	-----------------

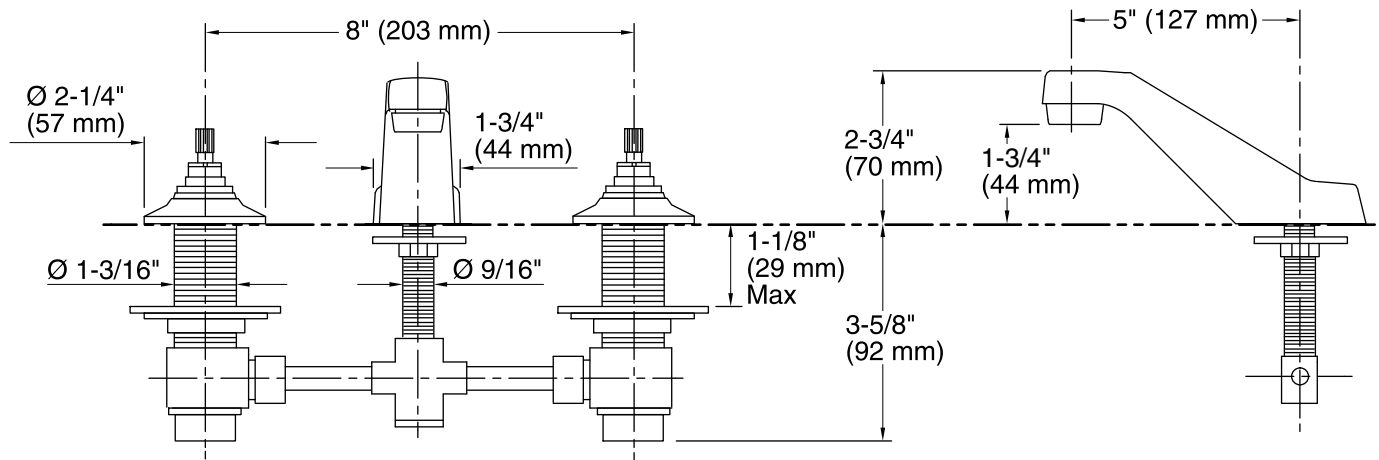

## Technical Information

All product dimensions are nominal.

### Spout:

Spout reach: 5" (127 mm)

### Faucet:

Flow rate: 0.5 gal/min (1.9 l/min)

Pressure: 60 psi (4.1 bar)

## Notes

Install this product according to the installation guide.