

Features

- Brass valve bodies.
- Brass construction.
- Quarter-turn washerless ceramic disc valves.
- Pop-up drain with lift rod and tailpiece.
- Standard aerator.
- Variety of handle style options.
- 5-1/4" (133 mm) gooseneck spout.
- Lower flow aerator options are available. (Please refer to the Kohler Price Book).
- 8" (203 mm) to 16" (406 mm) centers.
- 2.2 gal/min (8.3 l/min) maximum flow rate [max at 60 psi (4.14 bar)].

Required Accessories

- K-16010-2 Standard Handles for Centerset Base Faucet
or
K-16010-3 Cross Handles for Centerset Base Faucet
or
K-16010-4 Lever Handles for Centerset Base Faucet
or
K-16010-5 Wristblade Lever Handles for Centerset Base Faucet

Optional Accessories

- 1160595 .35 gpm Aerator, Medium



ADA

Codes/Standards

ASME A112.18.1/CSA B125.1
NSF 61
NSF 372
All applicable US Federal and State material regulations
DOE - Energy Policy Act 1992
ADA
ICC/ANSI A117.1

KOHLER® Faucet Lifetime Limited Warranty

See website for detailed warranty information.

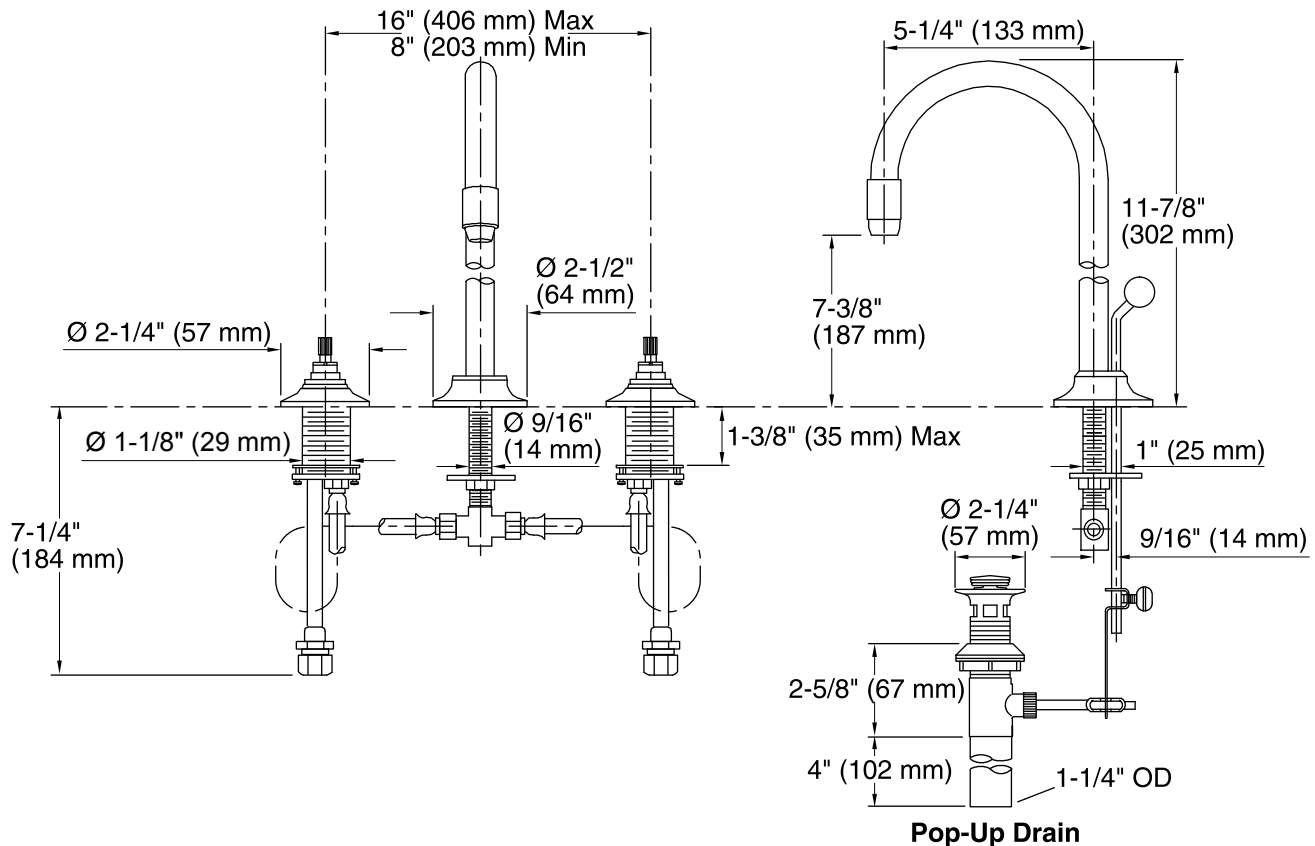

Technical Information

All product dimensions are nominal.

Drain included: YES

Drain tailpiece included: YES

Spout:

Spout reach: 5-1/4" (133 mm)

Faucet:

Flow rate: 2.2 gal/min (8.3 l/min)

Pressure: 60 psi (4.1 bar)

Notes

Install this product according to the installation guide.

ADA compliant when installed to the specific requirements of these regulations.