



**Pennington®**  
Countertop Bathroom Sink  
**K-R2196-4**

**Features**

- 4" (102 mm) centers.
- With overflow.
- ADA compliant when installed in a 21" (533 mm) minimum depth countertop
- 20-1/4" (514 mm) x 17-1/2" (445 mm)

**Material**

- Vitreous china.

**Installation**

- Drop-in

**Recommended Accessories**

K-8998 P-Trap

**Components**

Additional included component/s: Cut-out template.



**ADA**

**Codes/Standards**

ASME A112.19.2/CSA B45.1

ADA

ICC/ANSI A117.1

**Kohler One-Year Limited Warranty**

See website for detailed warranty information.

**Available Color/Finishes**

*Color tiles intended for reference only.*

Color	Code	Description
-------	------	-------------

	0	White
--	---	-------

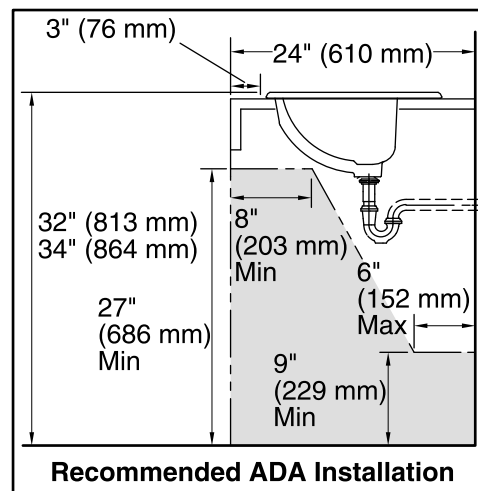
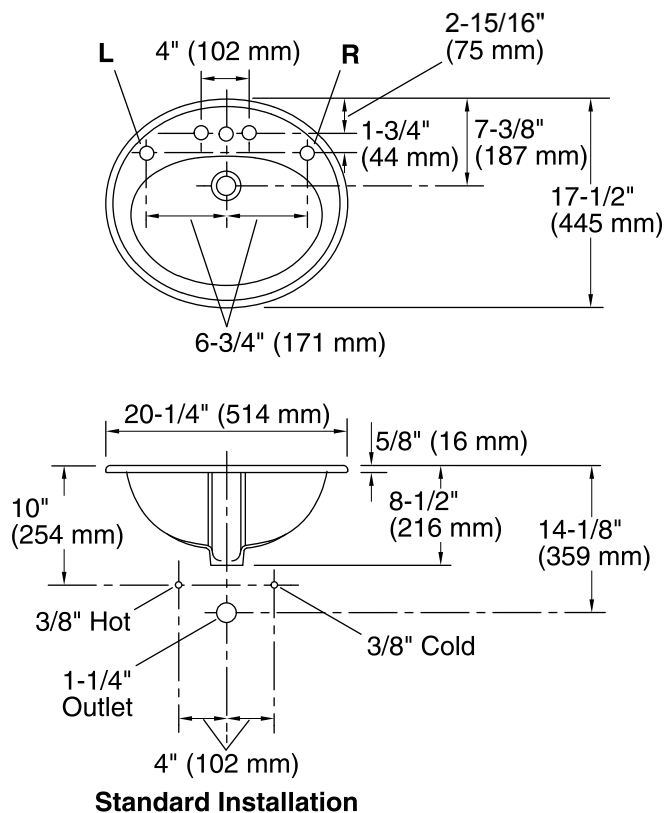

## Technical Information

All product dimensions are nominal.

Bowl area	Bowl depth: 10" (254 mm)
	Water depth: 4" (102 mm)
Faucet hole(s):	1-1/4" (32 mm)
Soap/Lotion hole:	1-1/4" (32 mm)
Drain hole:	1-3/4" (44 mm)
Template:	1002970-7, not required, not included

## Notes

Install this product according to the installation instructions.

**NOTICE:** Countertop manufacturer or cutter must use the cut-out template provided with the product, or a current one provided by Kohler Co. (call 1-800-4-KOHLER). Kohler Co. is not responsible for cut-out errors when the incorrect cut-out template is used.

ADA compliant when installed to the specific requirements of these regulations.