

MAAX SUBMITTAL SPECIFICATIONS

Vivez l'expérience

MAAX®

Enjoy the experience

32S

MODEL NUMBER 103000

DIMENSIONS: 32" x 34" x 73" Fiberglass



STANDARD FEATURES

- 1-piece shower
- Built-in soap dishes

OPTIONS

- PVC quick caulking shower drain with Chrome or Brushed Nickel grid
- ABS shower drain with Chrome stainless steel grid
- ABS shower drain with ABS grid

UNIQUE FEATURES

- None

SYSTEMS

- None

DOOR SELECTION

Combine with MAAX's complete shower door offering visit www.maax.com

Project :
Contractor :
MAAX Representative : Tel :
Date :

CERTIFICATIONS

Maax products adhere to one or more of the following certifications:



www.maax.com

2018-01-08

MAAX SUBMITTAL SPECIFICATIONS

32S

MODEL NUMBER 103000

TECHNICAL DRAWINGS

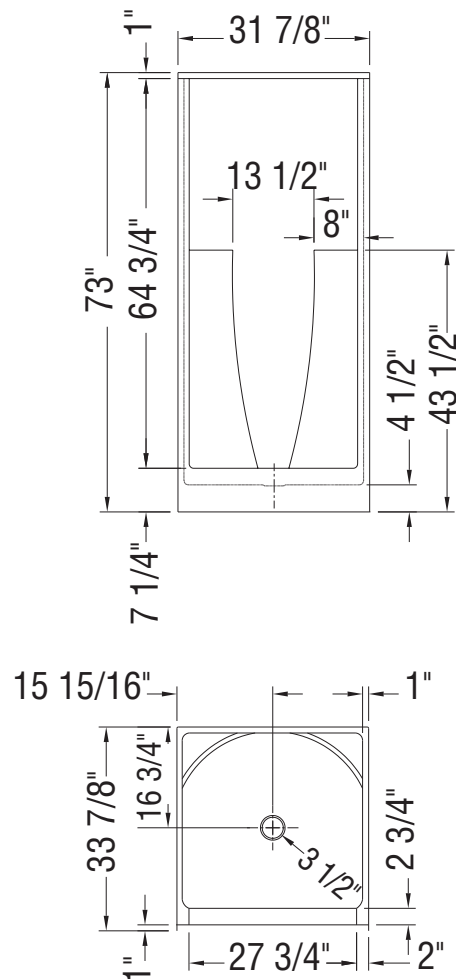

All dimensions are approximate. Structure measurements must be verified against the unit to ensure proper fit.

2018-01-08