

# MAAX SUBMITTAL SPECIFICATIONS

Vivez l'expérience  
**MAAX**<sup>®</sup>  
Enjoy the experience

## 59" Finesse

**MODEL NUMBER 101347**

DIMENSIONS: 48-61" x 30-34" x 59" Acrylic



### STANDARD FEATURES

- High gloss acrylic
- 1/8" thickness
- 2 towel bars and 4 shelves
- 5-year warranty

### OPTIONS

- None

### UNIQUE FEATURES

- None

### SYSTEMS

- None

### DOOR SELECTION

Combine with MAAX's complete shower door offering visit [www.maax.com](http://www.maax.com)

Project : .....  
Contractor : .....  
MAAX Representative : ..... Tel : .....  
Date : .....

### CERTIFICATIONS

Maax products adhere to one or more of the following certifications:



[www.maax.com](http://www.maax.com)

2018-01-08

## MAAX SUBMITTAL SPECIFICATIONS

# 59" Finesse

MODEL NUMBER 101347

## TECHNICAL DRAWINGS

---

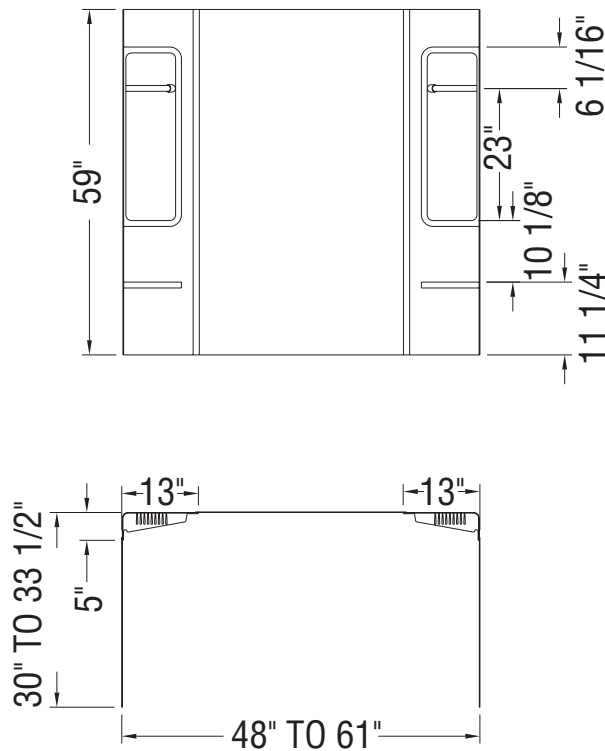

All dimensions are approximate. Structure measurements must be verified against the unit to ensure proper fit.

2018-01-08