

MAAX SUBMITTAL SPECIFICATIONS

Vivez l'expérience
MAAX[®]
Enjoy the experience

59 Panama

MODEL NUMBER 101646

DIMENSIONS: 48-61" x 34" x 59" Polystyrene



Project :
Contractor :
MAAX Representative : Tel :
Date :

STANDARD FEATURES

- Tub walls with smooth finish
- 2 towel bars
- 4 shelves

OPTIONS

- None

UNIQUE FEATURES

- None

SYSTEMS

- None

DOOR SELECTION

Combine with MAAX's complete shower door offering visit www.maax.com

CERTIFICATIONS

Maax products adhere to one or more of the following certifications:



www.maax.com

2018-01-08

MAAX SUBMITTAL SPECIFICATIONS

Vivez l'expérience
MAAX[®]
Enjoy the experience

59 Panama

MODEL NUMBER 101646

TECHNICAL DRAWINGS

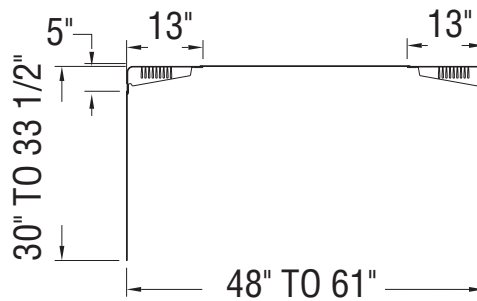
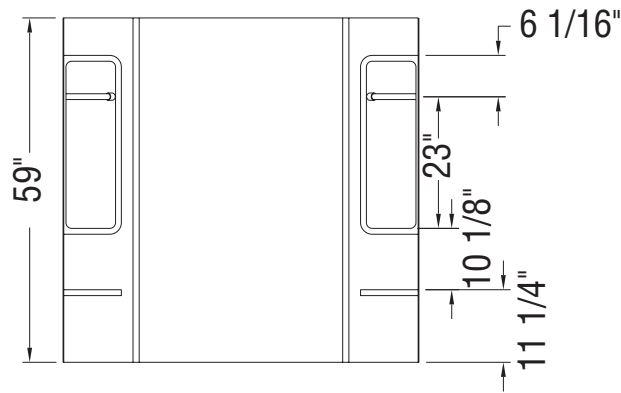

All dimensions are approximate. Structure measurements must be verified against the unit to ensure proper fit.

2018-01-08