

MAAX SUBMITTAL SPECIFICATIONS

80 Capri Plus

MODEL NUMBER 101591

DIMENSIONS: 60-62" x 30-33" x 80" Polystyrene



STANDARD FEATURES

- Smooth finish
- High gloss
- 2 towel bars
- 6 shelves
- 80" can accommodate a shower

OPTIONS

- None

UNIQUE FEATURES

- None

SYSTEMS

- None

DOOR SELECTION

Combine with MAAX's complete shower door offering visit www.maax.com

Project :
Contractor :
MAAX Representative : Tel :
Date :

CERTIFICATIONS

Maax products adhere to one or more of the following certifications:



MAAX SUBMITTAL SPECIFICATIONS

80 Capri Plus

MODEL NUMBER 101591

TECHNICAL DRAWINGS

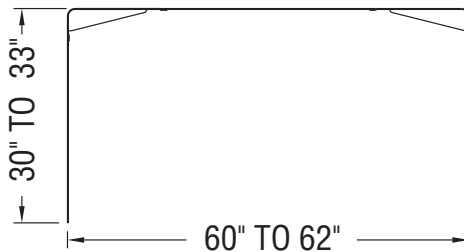
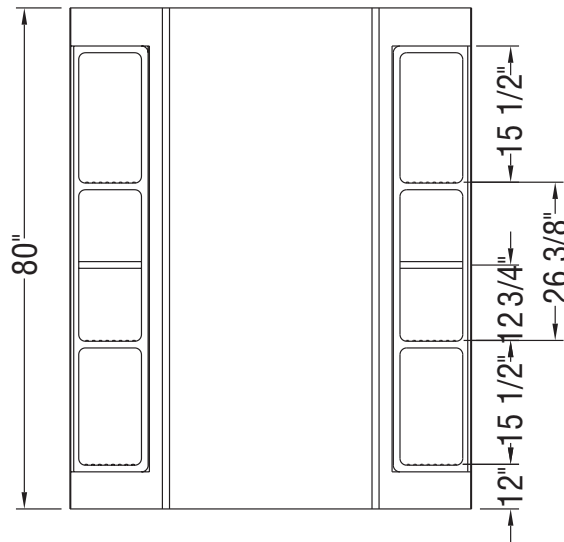

All dimensions are approximate. Structure measurements must be verified against the unit to ensure proper fit.