

MAAX SUBMITTAL SPECIFICATIONS

Aspen-1P (1-Piece)

MODEL NUMBER 101023

DIMENSIONS: 60" x 31" x 85" Acrylic



STANDARD FEATURES

- 1 or 3-piece tub shower
- Integrated shelves
- Acrylic towel bar
- Roof cap included
- Textured bottom
- Integrated apron with access panel when equipped with system

OPTIONS

- Chromatherapy
- Cable-operated waste and overflow
- Water heater assembly (factory installed)
- Microjet trim kit
- Metal trim kit for Air Push Control
- Recessed light

UNIQUE FEATURES

- None

SYSTEMS

Microjets[®] Aerosens[®] **DOOR**

SELECTION

Combine with MAAX's complete shower door offering visit www.maax.com

CERTIFICATIONS

Maax products adhere to one or more of the following certifications:



Project :
 Contractor :
 MAAX Representative : Tel :
 Date :

MAAX SUBMITTAL SPECIFICATIONS

Aspen-1P (1-Piece)

MODEL NUMBER 101023

TECHNICAL DRAWINGS

Aspen 1 Piece

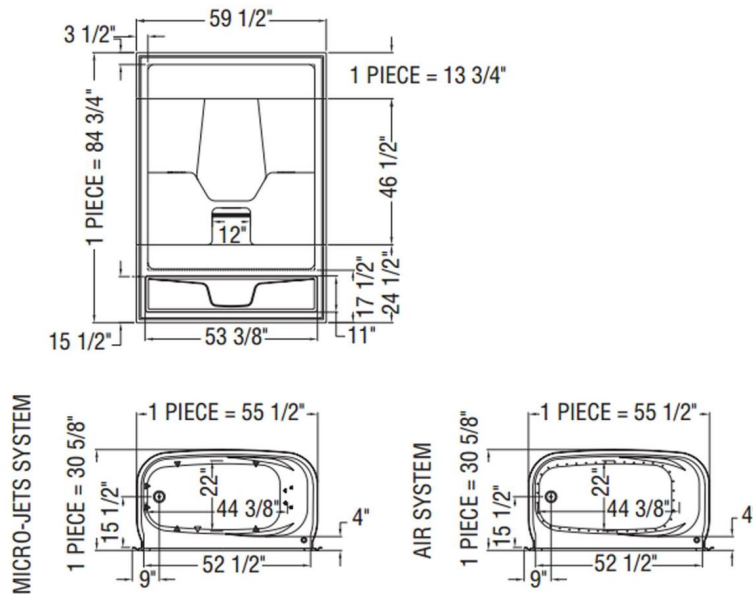

Aspen 3 Piece

