

## MAAX SUBMITTAL SPECIFICATIONS

# Carlton II

**MODEL NUMBER 101165**

DIMENSIONS: 48" x 35" x 75" Fiberglass

Vivez l'expérience  
**MAAX**<sup>®</sup>  
Enjoy the experience

### STANDARD FEATURES

- 2 built-in shelves
- 2 built-in seats

### OPTIONS

- PVC quick caulking shower drain with Chrome or Brushed Nickel grid
- ABS shower drain with Chrome stainless steel grid
- ABS shower drain with ABS grid

### UNIQUE FEATURES

- None

### SYSTEMS

- None

### DOOR SELECTION

Combine with MAAX's complete shower door offering visit [www.maax.com](http://www.maax.com)

Project : .....  
Contractor : .....  
MAAX Representative : ..... Tel : .....  
Date : .....

### CERTIFICATIONS

Maax products adhere to one or more of the following certifications:



**[www.maax.com](http://www.maax.com)**

2018-01-08

## MAAX SUBMITTAL SPECIFICATIONS

# Carlton II

MODEL NUMBER 101165

## TECHNICAL DRAWINGS

---

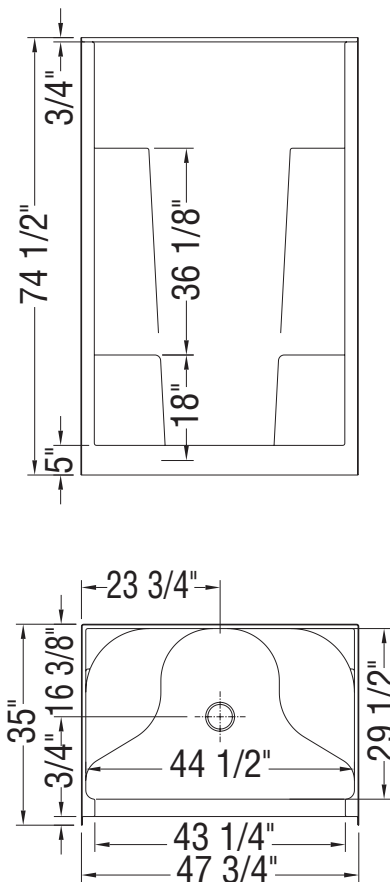

All dimensions are approximate. Structure measurements must be verified against the unit to ensure proper fit.

2018-01-08