

# MAAX SUBMITTAL SPECIFICATIONS

## Elina

**MODEL NUMBER 106389**

DIMENSIONS: 66" x 34" x 27" Acrylic

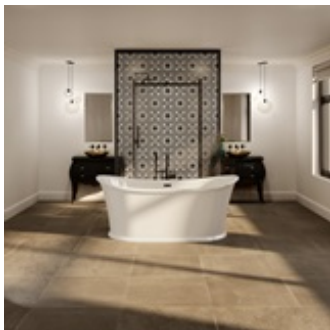

Project : .....  
Contractor : .....  
MAAX Representative : ..... Tel : .....  
Date : .....

**www.maax.com**

Vivez l'expérience  
**MAAX**<sup>®</sup>  
Enjoy the experience

### STANDARD FEATURES

- Seamless 1-piece bathtub with a symmetrical look
- Maximized bathing well with comfortable raised backrests and center drain
- Linear overflow and drain in chrome (pre-installed)
- F<sup>2</sup> Drain compatible
- Available in white only

### OPTIONS

- Linear-rounded overflow and waste metal trim kit
- F2 Drain - kit for freestanding bathtub installation
- F2 Drain – Pack of 12 kits for freestanding bathtub installation
- F2 Drain - PVC kit for bathtub installation
- Positioning template (sold separately)
- Round waste metal trim

### UNIQUE FEATURES

- Compatible with F2 Drain

### SYSTEMS

- None

### CERTIFICATIONS

Maax products adhere to one or more of the following certifications:



2018-01-08

# MAAX SUBMITTAL SPECIFICATIONS

## Elina

MODEL NUMBER 106389

### TECHNICAL DRAWINGS

Vivez l'expérience  
**MAAX**<sup>®</sup>  
Enjoy the experience

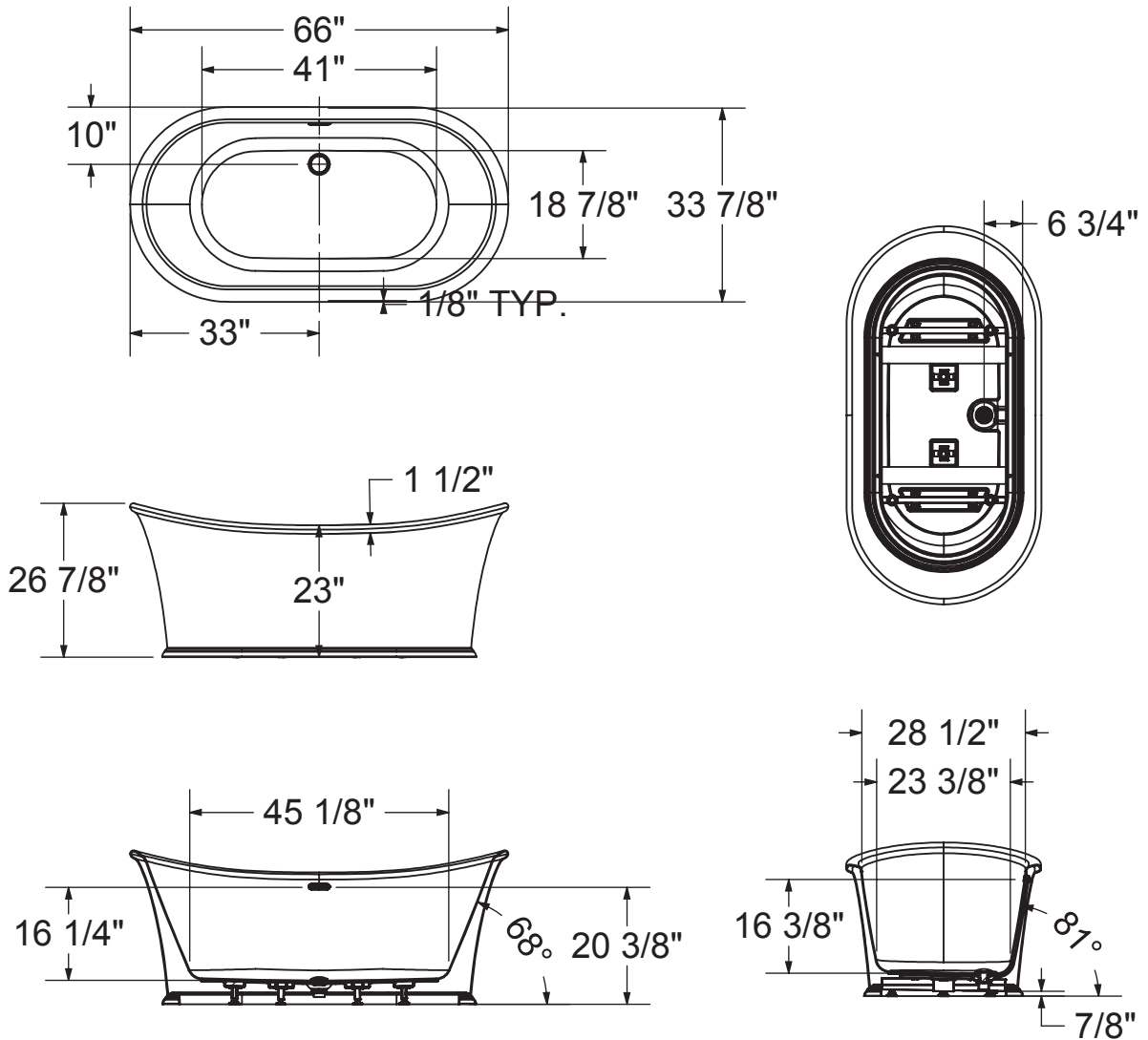

All dimensions are approximate. Structure measurements must be verified against the unit to ensure proper fit.

2018-01-08