

MAAX SUBMITTAL SPECIFICATIONS

Equinox II

MODEL NUMBER 102500

DIMENSIONS: 40" x 40" x 78" Acrylic



Vivez l'expérience
MAAX[®]
Enjoy the experience

STANDARD FEATURES

- 1-piece shower
- 3 built-in shelves
- Footrest
- Optional roof cap

OPTIONS

- Roof cap
- Recessed light
- PVC quick caulking shower drain with Chrome or Brushed Nickel grid
- ABS shower drain with Chrome stainless steel grid
- ABS shower drain with ABS grid

UNIQUE FEATURES

- None

SYSTEMS

- None

DOOR SELECTION

Combine with MAAX's complete shower door offering visit www.maax.com

CERTIFICATIONS

Maax products adhere to one or more of the following certifications:



Project :
Contractor :
MAAX Representative : Tel :
Date :

www.maax.com

2018-01-08

MAAX SUBMITTAL SPECIFICATIONS

Equinox II

MODEL NUMBER 102500

TECHNICAL DRAWINGS

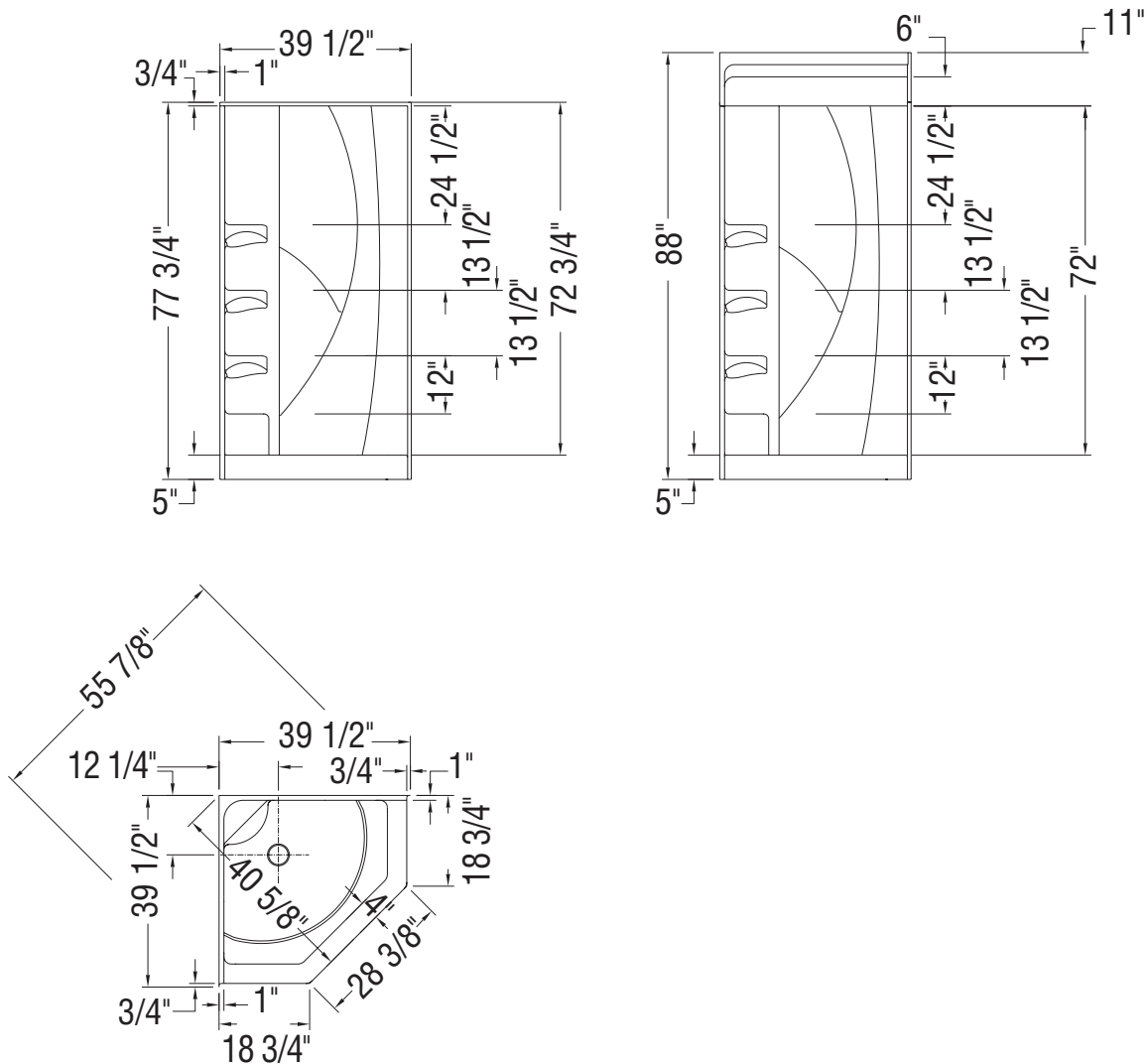

All dimensions are approximate. Structure measurements must be verified against the unit to ensure proper fit.

2018-01-08