

## MAAX SUBMITTAL SPECIFICATIONS

# Exhibit 6030 IFS DTF

**MODEL NUMBER 105547**

DIMENSIONS: 60" x 30" x 18" Acrylic



Project : .....  
Contractor : .....  
MAAX Representative : ..... Tel : .....  
Date : .....

**www.maax.com**

Vivez l'expérience  
**MAAX**<sup>®</sup>  
Enjoy the experience

### STANDARD FEATURES

- Unique feature: minimalist look with discreet armrests
- Textured bottom
- Alcove installation
- Integrated double tiling flange

### OPTIONS

- Cable-operated waste and overflow
- Foam pillow with 2 suction pads
- Waste and overflow

### UNIQUE FEATURES

- Tiling Flange

### SYSTEMS

- None

### DOOR SELECTION

Combine with MAAX's complete shower door offering visit [www.maax.com](http://www.maax.com)

### CERTIFICATIONS

Maax products adhere to one or more of the following certifications:



2018-01-08

## MAAX SUBMITTAL SPECIFICATIONS

# Exhibit 6030 IFS DTF

MODEL NUMBER 105547

## TECHNICAL DRAWINGS

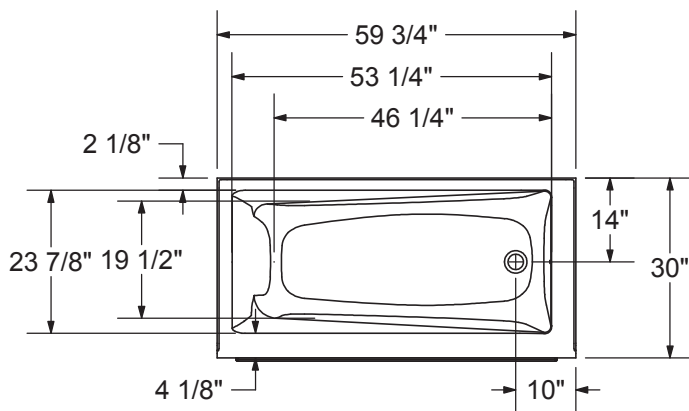

1" Single Integrated tiling  
 flange (shown)  
 2 3/8" Double Integrated tiling  
 flange (not shown)

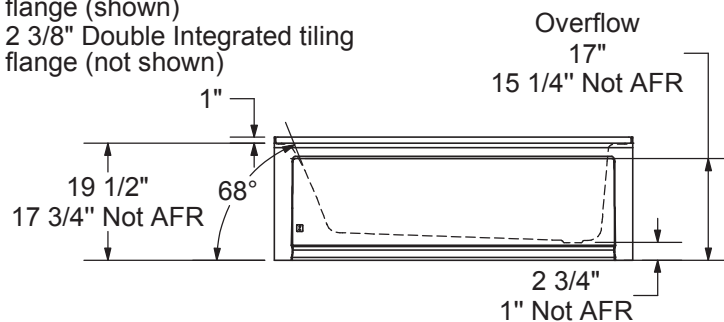

SKIRT



Wood support design may vary.  
 Single Integrated tiling flange: 1" height x 1/4" thickness (shown)  
 Double Integrated tiling flange: 2 3/8" height (not shown)  
 All dimensions are approximate. Structure measurements  
 must be verified against the unit to ensure proper fit.