

MAAX SUBMITTAL SPECIFICATIONS

KDS 3060

MODEL NUMBER 145036

DIMENSIONS: 60" x 30" x 80" Fiberglass



Project :
Contractor :
MAAX Representative : Tel :
Date :

Vivez l'expérience
MAAX®
Enjoy the experience

STANDARD FEATURES

- Product available with or without Above-the-floor rough
- 4-piece shower with threshold base
- Large top corner shelves, wide soap dish and acrylic handle
- Right seat, left seat or no seat configuration
- Unique feature: pin system for easy front installation
- All grab bars can support up to 300 lbs

OPTIONS

- 18" Modern straight grab bar
- 24" Modern straight grab bar
- Wall reinforcement (one wall)
- One 12-in. handle with metallic finish

UNIQUE FEATURES

- PIN system

SYSTEMS

- None

DOOR SELECTION

Combine with MAAX's complete shower door offering visit www.maax.com

CERTIFICATIONS

Maax products adhere to one or more of the following certifications:



www.maax.com

2018-01-08

MAAX SUBMITTAL SPECIFICATIONS

KDS 3060

MODEL NUMBER 145036

TECHNICAL DRAWINGS

STANDARD

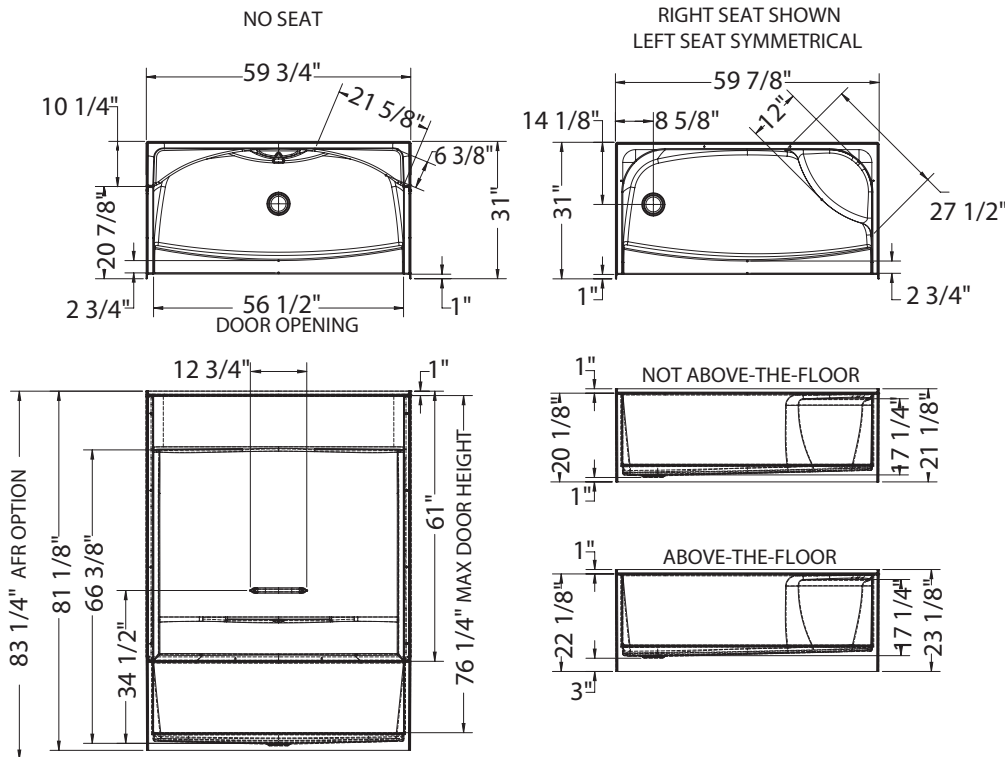

REINFORCEMENT BACKING

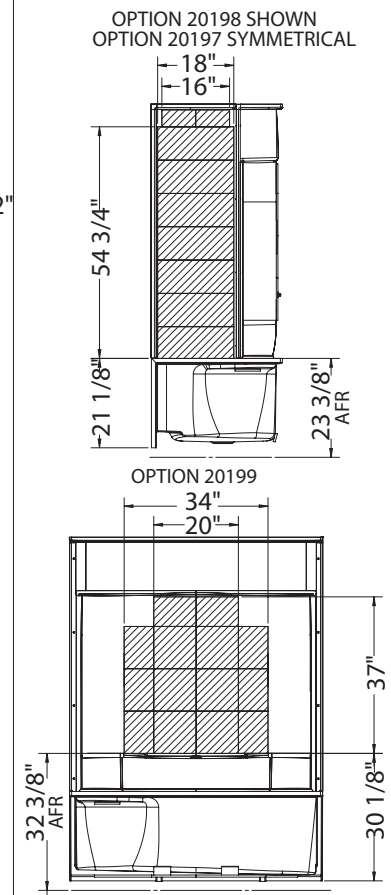

GRAB BARS

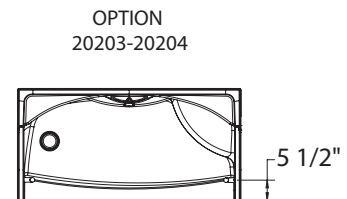
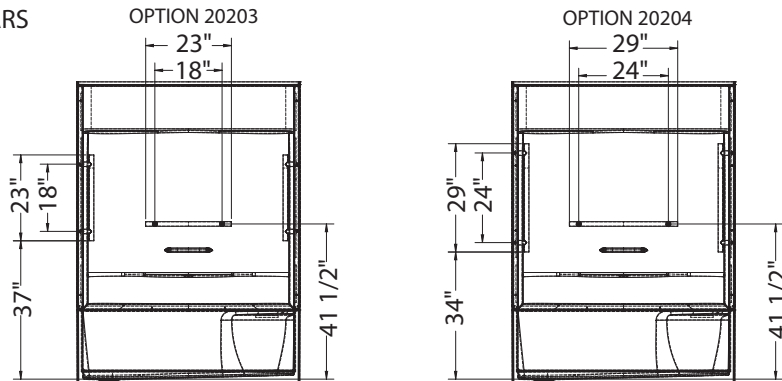

All dimensions are approximate. Structure measurements must be verified against the unit to ensure proper fit.

2018-01-08