

MAAX SUBMITTAL SPECIFICATIONS

Melodie

MODEL NUMBER 100073

DIMENSIONS: 66" x 33" x 20" Acrylic

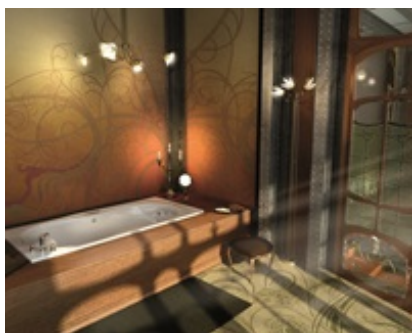

Project :
 Contractor :
 MAAX Representative : Tel :
 Date :

www.maax.com

Vivez l'expérience
MAAX[®]
 Enjoy the experience

STANDARD FEATURES

- Raised bi-level bottom and curved lines for complete relaxation
- Relaxing armrests with ergonomic backrests
- Ample deck space for faucet installation, apron available
- Drop-in, undermount ¹⁰ or alcove installation with center drain
- White cushion included with whirlpool and combined systems
- For alcove installation, specify tiling flange

OPTIONS

- Thermo-Acoustic system
- Metal trim kit for whirlpool and combined systems
- Tiling flange
- Removable acrylic apron
- Two chromatherapy lights
- One chromatherapy light

UNIQUE FEATURES

- None

SYSTEMS

- Aerofeel Chromatherapy
- Combined Aerofeel/Hydromax
- Hydromax Hydromax REST
- Hydromax with Backmax
- Ozonator

DOOR SELECTION

Combine with MAAX's complete shower door offering visit www.maax.com



2018-01-08

MAAX SUBMITTAL SPECIFICATIONS

Melodie

MODEL NUMBER 100073

TECHNICAL DRAWINGS

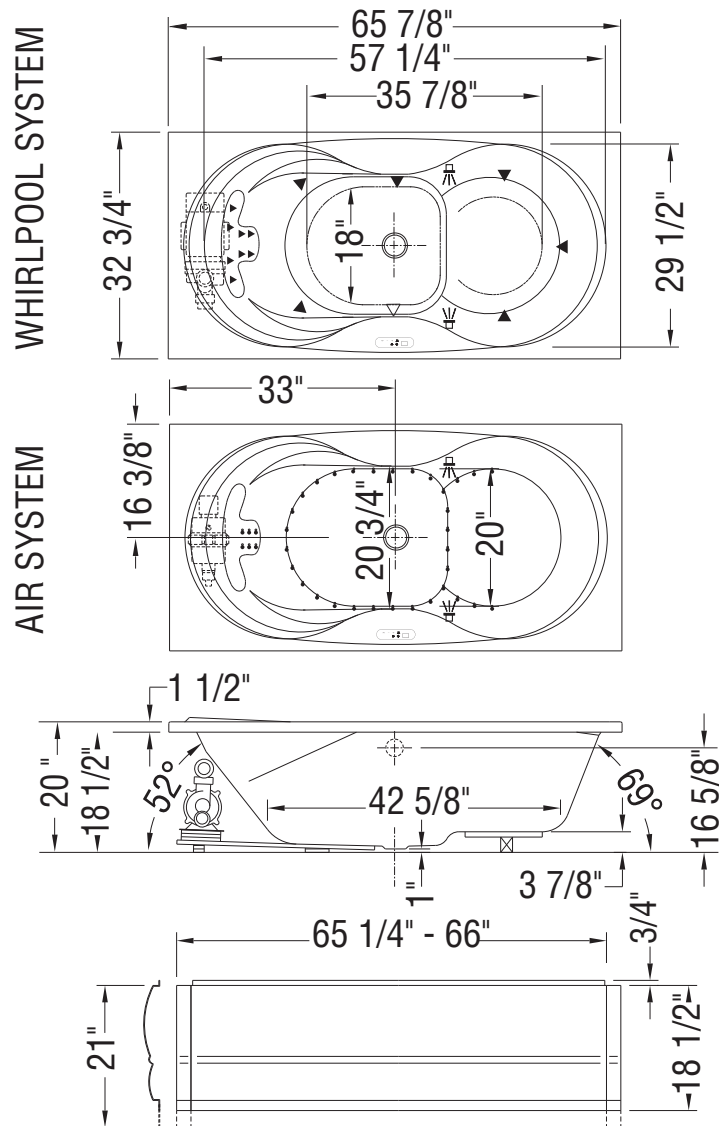

- (▲): Indicates whirlpool jets positioning
 - (△): Indicates suction positioning
 - (●): Indicates airjets positioning
 - (✎): Indicates chromatherapy light positioning
- Bathtub base includes anti-vibration Neutra-Phone leg supports (not shown).
All dimensions are approximate. Structure measurements must be verified against the unit to ensure proper fit.