

MAAX SUBMITTAL SPECIFICATIONS

Nancy

MODEL NUMBER 101212

DIMENSIONS: 54" x 54" x 23" Acrylic



Project :
Contractor :
MAAX Representative : Tel :
Date :

www.maax.com

Vivez l'expérience
MAAX®
Enjoy the experience

STANDARD FEATURES

- Two-person bathtub with spacious interior
- Smooth bottom
- Built-in seat
- Two raised neckrests
- Drop-in installation
- Center drain





OPTIONS

- One chromatherapy light
- Water heater assembly (factory installed)
- Microjet trim kit
- Hydrosens trim kit
- Metal trim kit for Air Push Control
- Cut-out template

UNIQUE FEATURES

- None

SYSTEMS

-  Backmax  Microjets **DOOR**
 Hydrosens
 Aerosens **SELECTION**
 Combined
Aerosens/Hydrosens

Combine with MAAX's complete shower door offering visit www.maax.com

CERTIFICATIONS

Maax products adhere to one or more of the following certifications:



2018-01-08

MAAX SUBMITTAL SPECIFICATIONS

Nancy

MODEL NUMBER 101212

TECHNICAL DRAWINGS

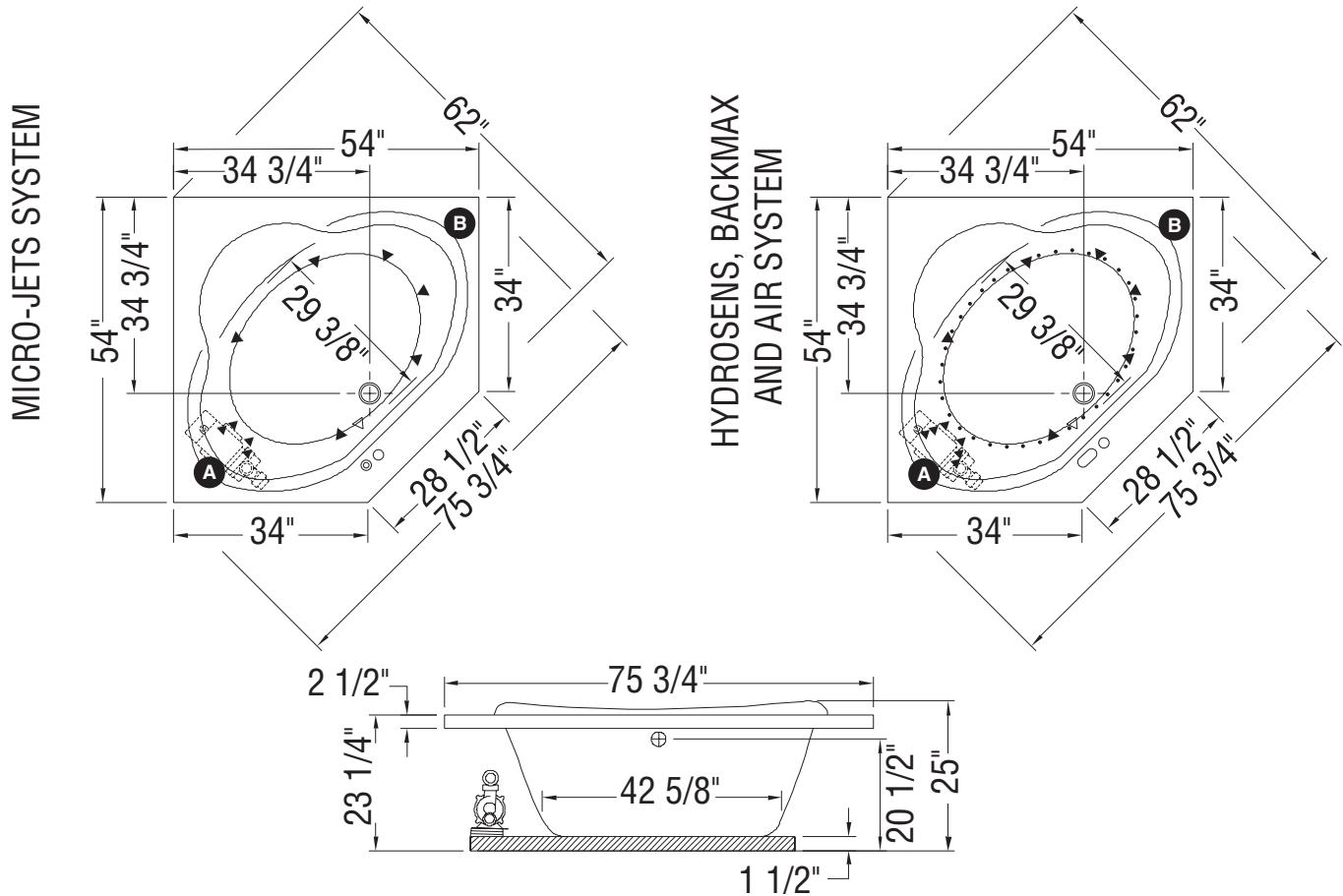

- A** : Specify blower and/or pump location when ordering
B : Specify whirlpool and backjets positioning
 (▲) : Indicates whirlpool and backjets positioning
 (△) : Indicates suction positioning
 (•) : Indicates airjets positioning

All dimensions are approximate. Structure measurements must be verified against the unit to ensure proper fit.