

MAAX SUBMITTAL SPECIFICATIONS

OPS-3636 - Base Model

MODEL NUMBER 106027

DIMENSIONS: 36" x 36" x 76 5/8" Fiberglass



STANDARD FEATURES

- 1-piece transfer shower reinforced according to FHA accessibility requirements
- Configurable to be compliant with major accessibility codes when properly installed
- Center drain, textured bottom
- 1 1/8 in. skirt and 1/2 in. high threshold
- Base model

OPTIONS

- Chrome recessed soap dish (drilled, not installed)
- 36" Chrome curtain rod
- Solid Brass drain with Chrome plated Stainless Steel grid
- 36" White vinyl shower curtain

UNIQUE FEATURES

- None

SYSTEMS

- None

CERTIFICATIONS

Maax products adhere to one or more of the following certifications:



Project :
Contractor :
MAAX Representative : Tel :
Date :

MAAX SUBMITTAL SPECIFICATIONS

OPS-3636 - Base Model

MODEL NUMBER 106027

TECHNICAL DRAWINGS

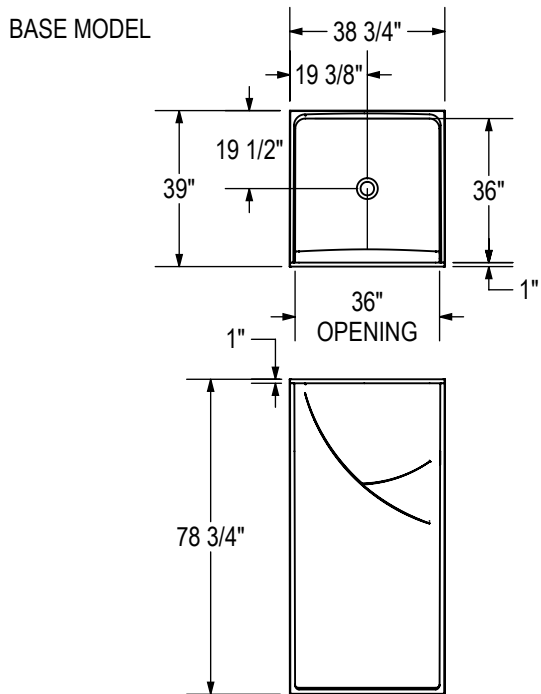

THRESHOLD DETAIL

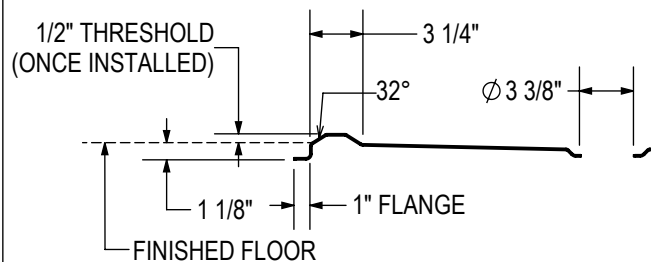

REINFORCEMENT BACKING

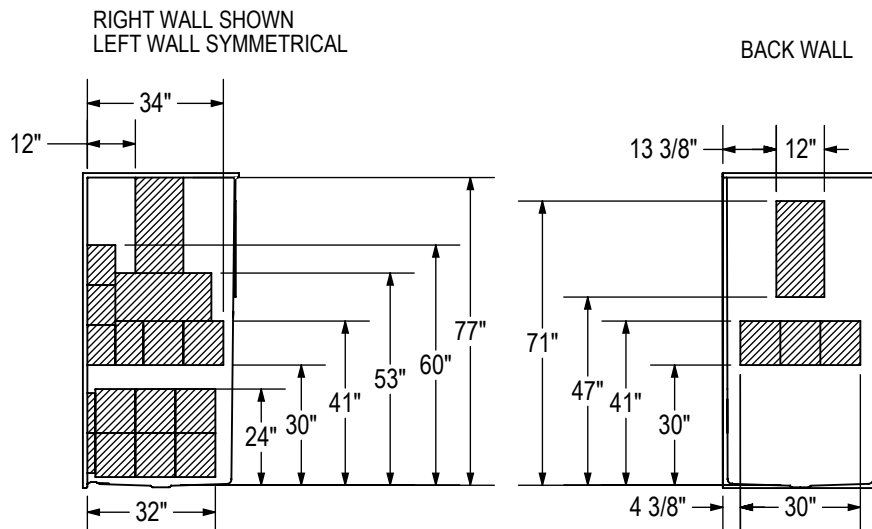

All dimensions are approximate. Structure measurements must be verified against the unit to ensure proper fit.