

MAAX SUBMITTAL SPECIFICATIONS

OPS-4248 - Base Model

MODEL NUMBER 106053

DIMENSIONS: 42" x 48" x 76 1/2" Fiberglass



STANDARD FEATURES

- 1-piece shower reinforced to meet California Title 24 requirements
- Configurable to be fully compliant with California Title 24
- 1 1/4" skirt and 1/2" exterior threshold
- Back center drain, textured bottom

OPTIONS

- Chrome recessed soap dish (drilled, not installed)
- 42" chrome curtain rod
- Solid Brass drain with Chrome plated Stainless Steel grid
- 48" white vinyl shower curtain with stainless steel hooks

UNIQUE FEATURES

- None

SYSTEMS

- None

CERTIFICATIONS

Maax products adhere to one or more of the following certifications:



Project :
Contractor :
MAAX Representative : Tel :
Date :

MAAX SUBMITTAL SPECIFICATIONS

OPS-4248 - Base Model

MODEL NUMBER 106053

TECHNICAL DRAWINGS

BASE MODEL

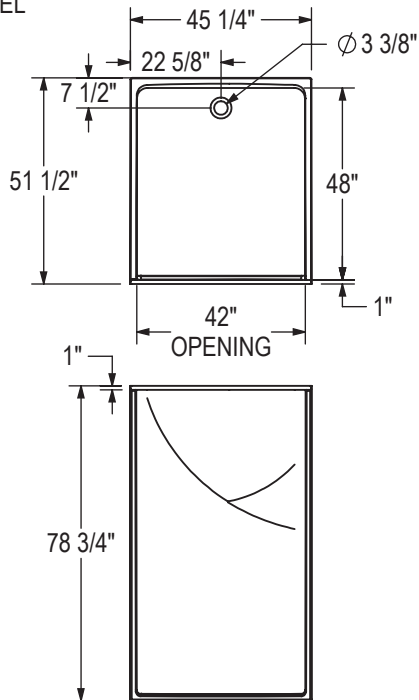

THRESHOLD DETAIL

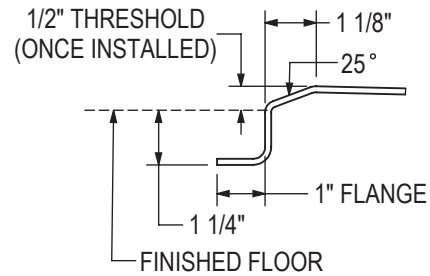

REINFORCEMENT BACKING

RIGHT WALL SHOWN
 LEFT WALL SYMMETRICAL

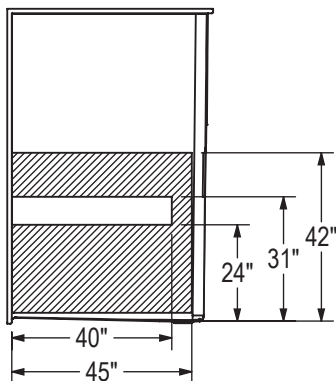

BACKWALL

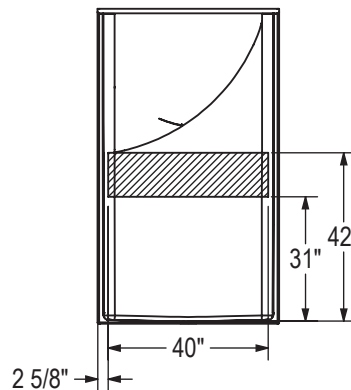

All dimensions are approximate. Structure measurements must be verified against the unit to ensure proper fit.