

MAAX SUBMITTAL SPECIFICATIONS

Rubix Access 6030 IFS

MODEL NUMBER 106348

DIMENSIONS: 60" x 30" x 14" Acrylic



STANDARD FEATURES

- Alcove bathtub with integrated flat skirt and tiling flange
- Available in Above-the-Floor Rough (AFR) or not
- Low deck height of 16 in. (AFR) or 14 in.
- Compliant with accessibility codes when properly installed
- Antislip Bottom
- Cubic design

OPTIONS

- Cable-operated waste and overflow
- Foam pillow with 2 suction pads
- Waste and overflow

UNIQUE FEATURES

- Tiling Flange

SYSTEMS

- None

DOOR SELECTION

Combine with MAAX's complete shower door offering visit www.maax.com

Project :
Contractor :
MAAX Representative : Tel :
Date :

CERTIFICATIONS

Maax products adhere to one or more of the following certifications:



MAAX SUBMITTAL SPECIFICATIONS

Rubix Access 6030 IFS

MODEL NUMBER 106348

TECHNICAL DRAWINGS

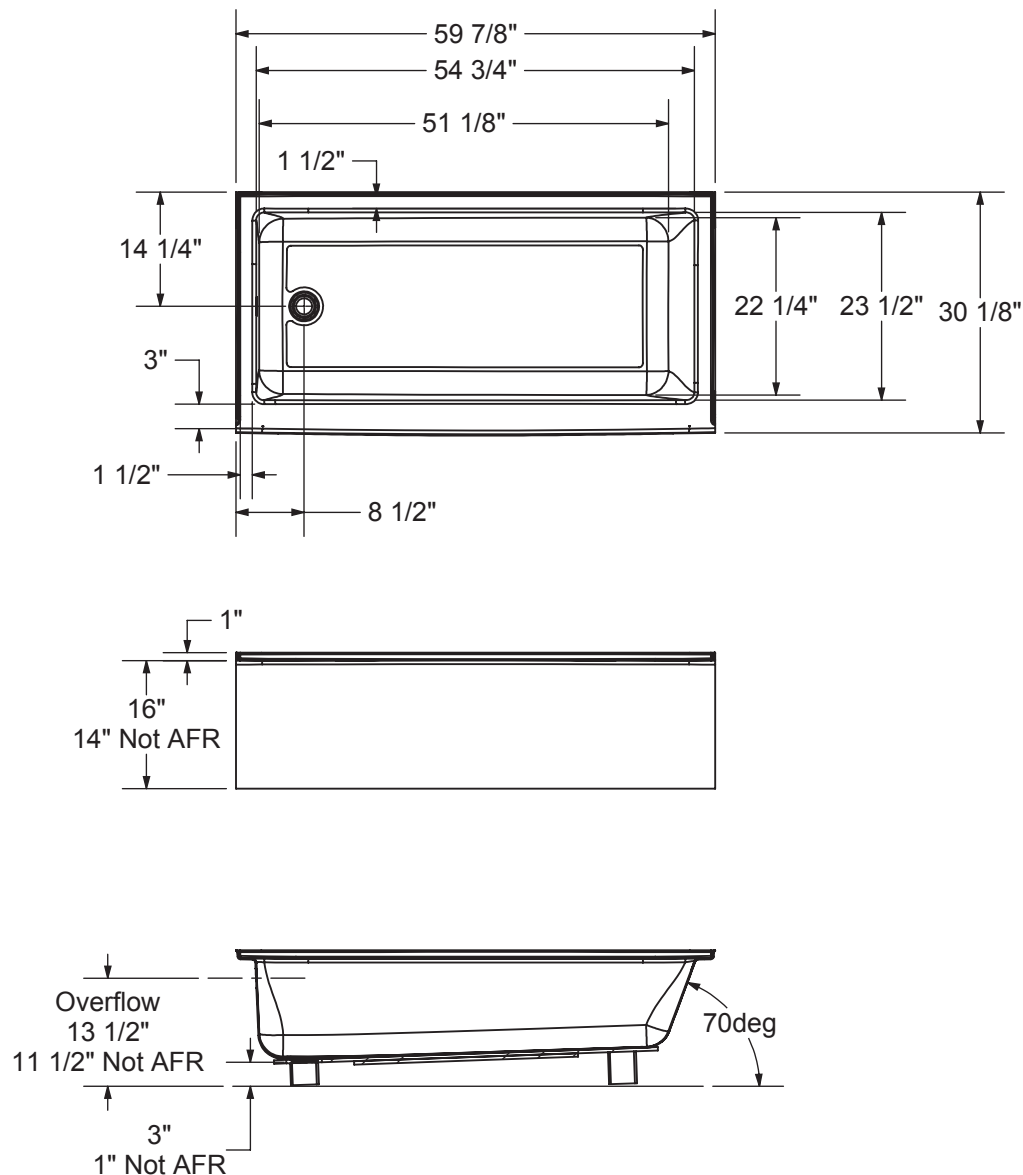

Wood support design may vary.
All dimensions are approximate. Structure measurements
must be verified against the unit to ensure proper fit.