

MAAX SUBMITTAL SPECIFICATIONS

Skybox 6636

MODEL NUMBER 105722

DIMENSIONS: 66" x 36" x 24" Acrylic



Project :
Contractor :
MAAX Representative : Tel :
Date :

www.maax.com

Vivez l'expérience
MAAX®
Enjoy the experience

STANDARD FEATURES

- Unique features: deep bathtub with choice of two deck heights (3/8 or 2 in.) Please specify when ordering
- Ample deck space for faucet installation
- Drop-in, undermount or alcove installation
- Textured bottom
- End drain

OPTIONS

- Brass waste and overflow for high-rise construction
- One chromatherapy light
- Water heater assembly (factory installed)
- Microjet trim kit
- Two 6-in. grab bars
- Hydrosens trim kit

UNIQUE FEATURES

- None

SYSTEMS

 Microjet  Hydrosens **DOOR**
 Aerosens **SELECTION**
 Combined
Aerosens/Hydrosens
 BackmaxCombine with
MAAX's complete
shower door offering visit
www.maax.com

CERTIFICATIONS

Maax products adhere to one or more of the following certifications:



2018-01-08

MAAX SUBMITTAL SPECIFICATIONS

Skybox 6636

MODEL NUMBER 105722

TECHNICAL DRAWINGS

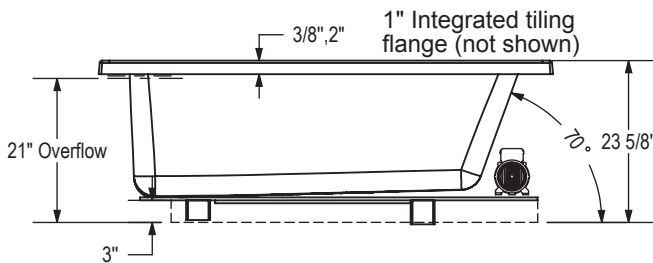
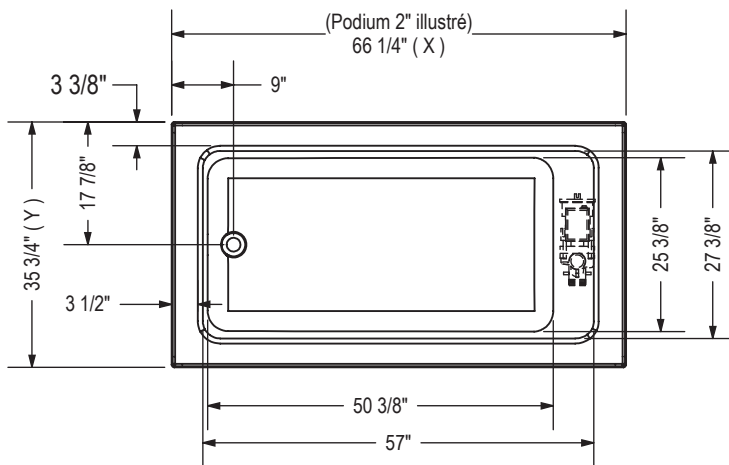

	DROP IN 2"	DROP IN 3/8"	ALCOVE
X	66 1/4"	66"	65 3/4"
Y	35 3/4"	35 5/8"	35 5/8"

Wood support design may vary.

Integrated tiling flange: 1" height X 1/4" thickness (not shown)
 Tiling flange position is determined by chosen configuration.

All dimensions are approximate.

Structure measurement must be verified against the unit to ensure proper fit.

MICROJETS
SYSTEM

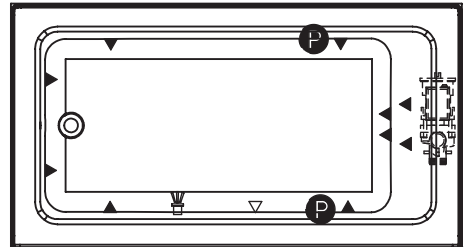

HYDROSENS with
BACKMAX SYSTEM

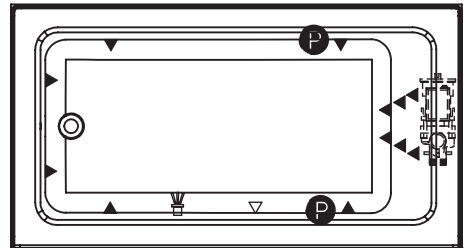

AIR SYSTEM

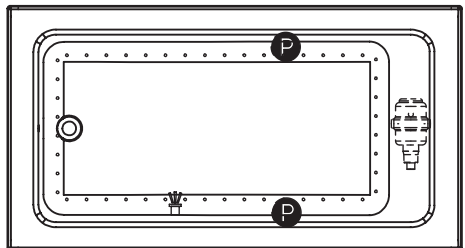

- (P) : Indicates optional grab bar positioning
- (▲) : Indicates whirlpool jets positioning
- (△) : Indicates suction positioning
- (●) : Indicates airjets positioning
- (⚡) : Indicates chromatherapy light positioning

APRON (alcove version only)

