

MAAX SUBMITTAL SPECIFICATIONS

Solo

MODEL NUMBER 100892

DIMENSIONS: 34" x 28" x 85" Acrylic



Project :
Contractor :
MAAX Representative : Tel :
Date :

Vivez l'expérience
MAAX[®]
Enjoy the experience

STANDARD FEATURES

- 1-piece shower with roof cap
- Integrated soap dish and shelf
- Optional: halogen light (recommended)

OPTIONS

- Recessed light
- ABS shower drain with Chrome stainless steel grid
- PVC quick caulking shower drain with Chrome or Brushed Nickel grid
- ABS shower drain with ABS grid

UNIQUE FEATURES

- None

SYSTEMS

- None

DOOR SELECTION

Combine with MAAX's complete shower door offering visit www.maax.com

CERTIFICATIONS

Maax products adhere to one or more of the following certifications:



www.maax.com

2018-01-08

MAAX SUBMITTAL SPECIFICATIONS

Solo

MODEL NUMBER 100892

TECHNICAL DRAWINGS

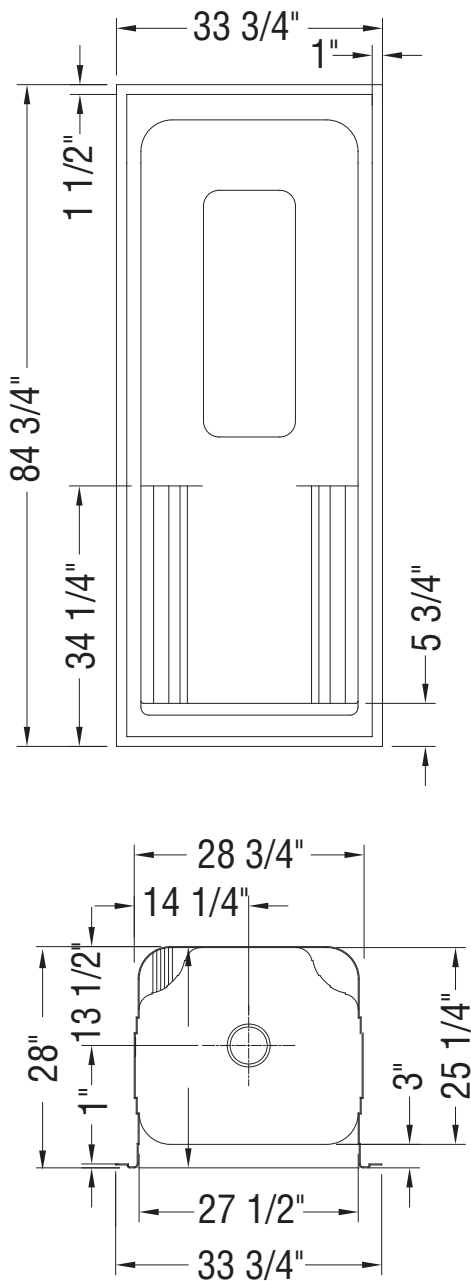

All dimensions are approximate. Structure measurements must be verified against the unit to ensure proper fit.