

MAAX SUBMITTAL SPECIFICATIONS

Stamina 48-I (3-Piece)

MODEL NUMBER 101139-S

DIMENSIONS: 51" x 36" x 85" Acrylic



STANDARD FEATURES

- 3-piece shower: base, walls and roof cap
- Sectional unit ideal for renovation projects
- Seat & footrest
- Integrated soap dish, shelves and towel bar¹
- Optional: roof halogen light (recommended)

OPTIONS

- Halogen light
- Halogen light - certified cULus - 12V.-4
- ABS shower drain with Chrome stainless steel grid
- ABS shower drain with ABS grid
- PVC quick caulking shower drain with Chrome or Brushed Nickel grid

UNIQUE FEATURES

- None

SYSTEMS

- None

DOOR SELECTION

Combine with MAAX's complete shower door offering visit www.maax.com

CERTIFICATIONS

Maax products adhere to one or more of the following certifications:



Project :
Contractor :
MAAX Representative : Tel :
Date :

MAAX SUBMITTAL SPECIFICATIONS

Stamina 48-I (3-Piece)

MODEL NUMBER 101139-S

TECHNICAL DRAWINGS

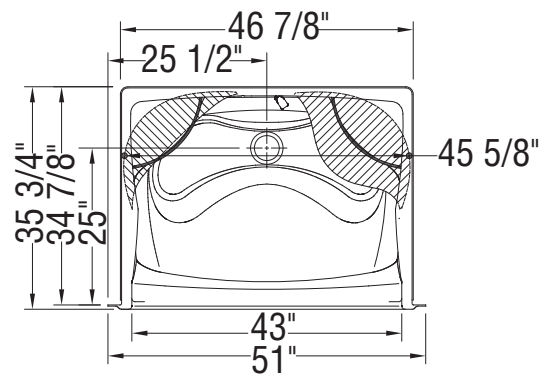
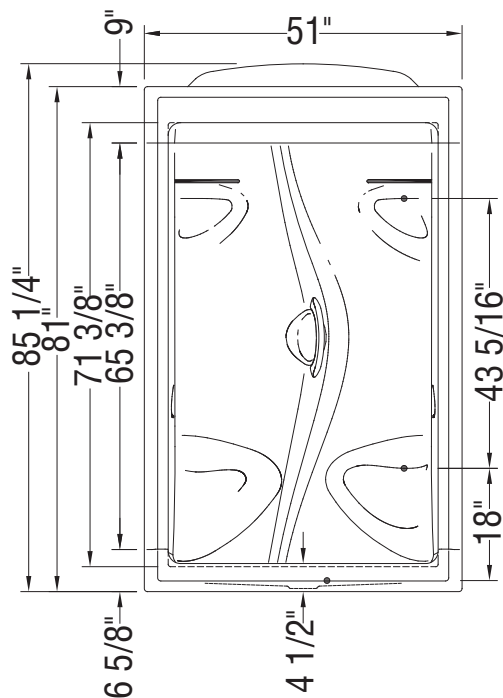

Left foot rest / Right seat

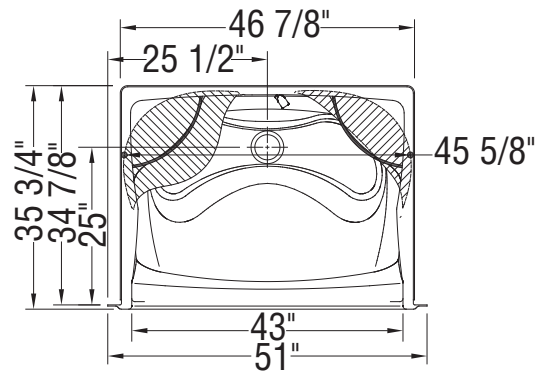

Left seat / Right foot rest

Flat surface for the installation of the valve 8-in. diameter

All dimensions are approximate. Structure measurements must be verified against the unit to ensure proper fit.