

MAAX SUBMITTAL SPECIFICATIONS

TSEA Plus

MODEL NUMBER 105674

DIMENSIONS: 60" x 32" x 78" Fiberglass



Project :
Contractor :
MAAX Representative : Tel :
Date :

Vivez l'expérience
MAAX[®]
Enjoy the experience

STANDARD FEATURES

- 1-piece tub shower without roof cap
- Integrated wide shelves
- 20 in. apron, 13 3/8 in. deep bathing well
- Above-the-Floor Rough (AFR)
- Optional wall reinforcement and grab bars

OPTIONS

- Left wall reinforcement only
- Right wall reinforcement only
- Back wall reinforcement only
- One chromatherapy light
- Metal trim kit for whirlpool and combined systems
- Cable-operated waste and overflow

UNIQUE FEATURES

- Above-the-Floor Rough (AFR)

SYSTEMS

 MAAX Professional Whirlpool

 Chromatherapy **DOOR SELECTION**

Combine with MAAX's complete shower door offering visit www.maax.com

CERTIFICATIONS

Maax products adhere to one or more of the following certifications:



www.maax.com

2018-01-08

MAAX SUBMITTAL SPECIFICATIONS

TSEA Plus

MODEL NUMBER 105674

TECHNICAL DRAWINGS

STANDARD

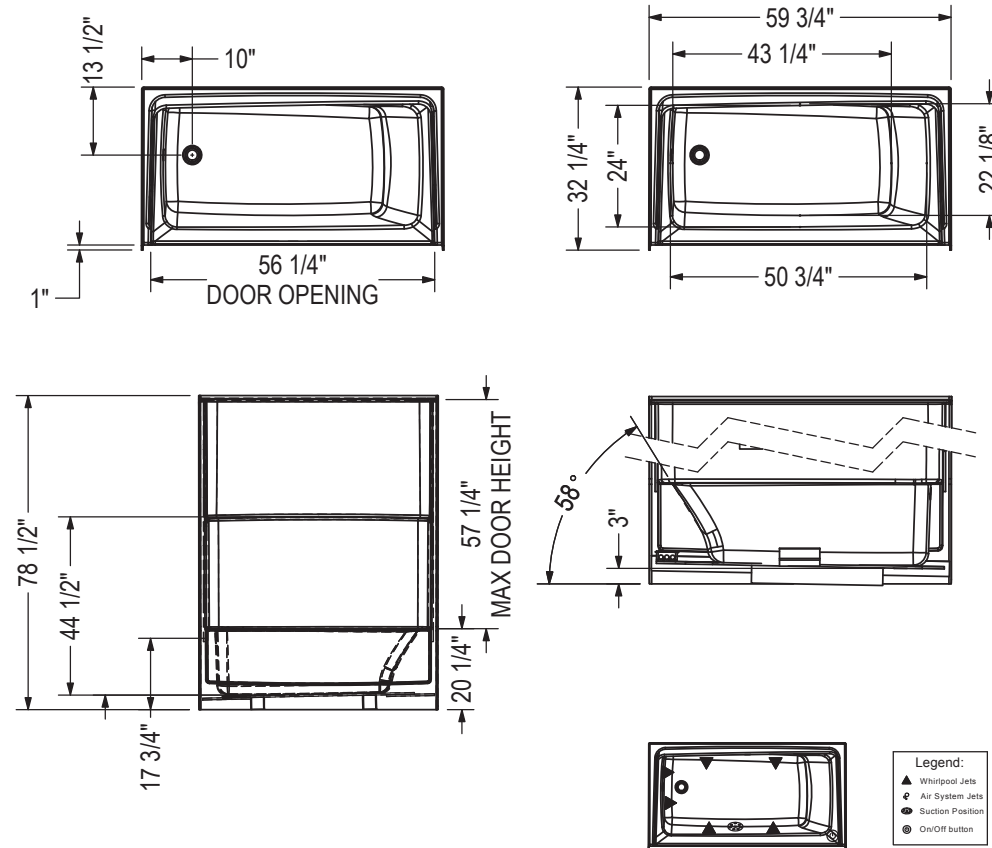

OPTIONAL REINFORCEMENT

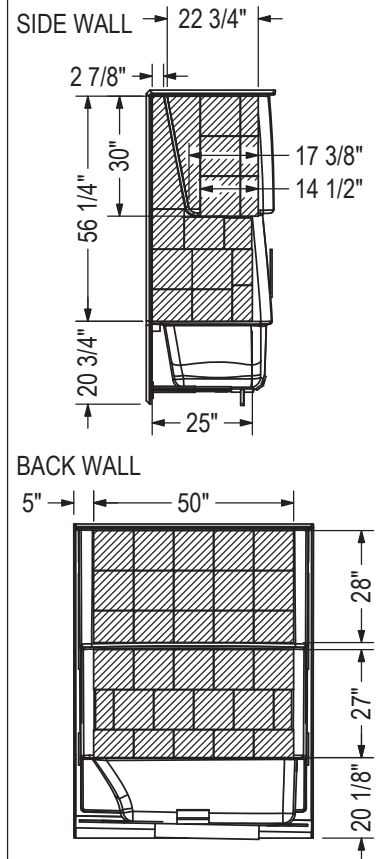

GRAB BARS

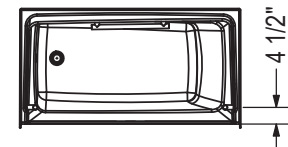
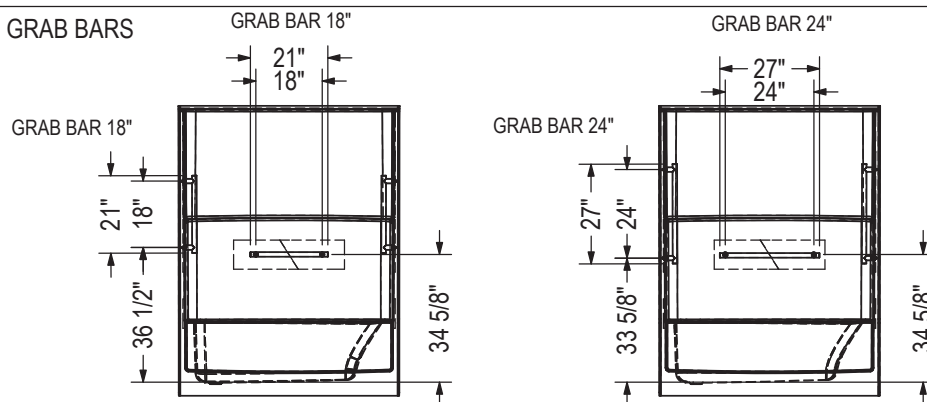

All dimensions are approximate. Structure measurements must be verified against the unit to ensure proper fit.