

Vivez l'expérience

MAAX®

Enjoy the experience

MAAX SUBMITTAL SPECIFICATIONS

TSEA61 (1-Piece)

MODEL NUMBER 140099

DIMENSIONS: 60" x 31" x 75" Fiberglass



STANDARD FEATURES

- 1-piece tub shower without roof cap
- Integrated shelf and towel bar

OPTIONS

- Foam pillow with 2 suction pads
- Metal trim kit for whirlpool and combined systems
- One chromatherapy light
- Left wall reinforcement only
- Right wall reinforcement only
- Back wall reinforcement only

UNIQUE FEATURES

- None

SYSTEMS

 MAAX Professional Whirlpool

DOOR SELECTION

Combine with MAAX's complete shower door offering visit www.maax.com

Project :

Contractor :

MAAX Representative : Tel :

Date :

CERTIFICATIONS

Maax products adhere to one or more of the following certifications:



www.maax.com

2018-01-08

MAAX SUBMITTAL SPECIFICATIONS

TSEA61 (1-Piece)

MODEL NUMBER 140099

TECHNICAL DRAWINGS

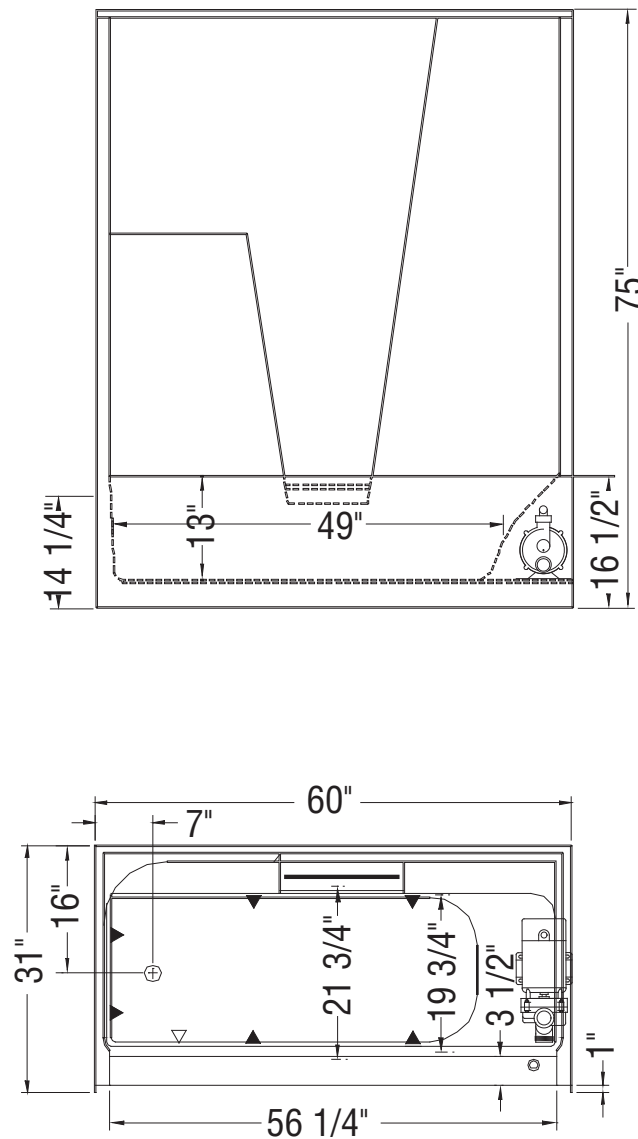

(▲): Indicates Whirlpool jets positioning

(△): Indicates suction positioning

All dimensions are approximate. Structure measurements must be verified against the unit to ensure proper fit.