

## MAAX SUBMITTAL SPECIFICATIONS

# TSTE A62 (1-Piece)

**MODEL NUMBER 140109**

DIMENSIONS: 60" x 31" x 72" Fiberglass



### STANDARD FEATURES

- 1-piece tub shower without roof cap
- Integrated shelf
- Unique feature: tile pattern finish

### OPTIONS

- Foam pillow with 2 suction pads
- Metal trim kit for whirlpool and combined systems
- One chromatherapy light
- Wall reinforcement (one wall)

### UNIQUE FEATURES

- None

### SYSTEMS

 MAAX Professional Whirlpool

### DOOR SELECTION

Combine with MAAX's complete shower door offering visit [www.maax.com](http://www.maax.com)

Project : .....  
Contractor : .....  
MAAX Representative : ..... Tel : .....  
Date : .....

### CERTIFICATIONS

Maax products adhere to one or more of the following certifications:



## MAAX SUBMITTAL SPECIFICATIONS

# TSTE62 (1-Piece)

MODEL NUMBER 140109

## TECHNICAL DRAWINGS

Full Wall Reinforcement Shown

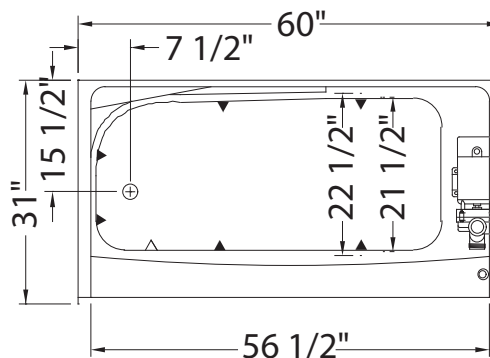
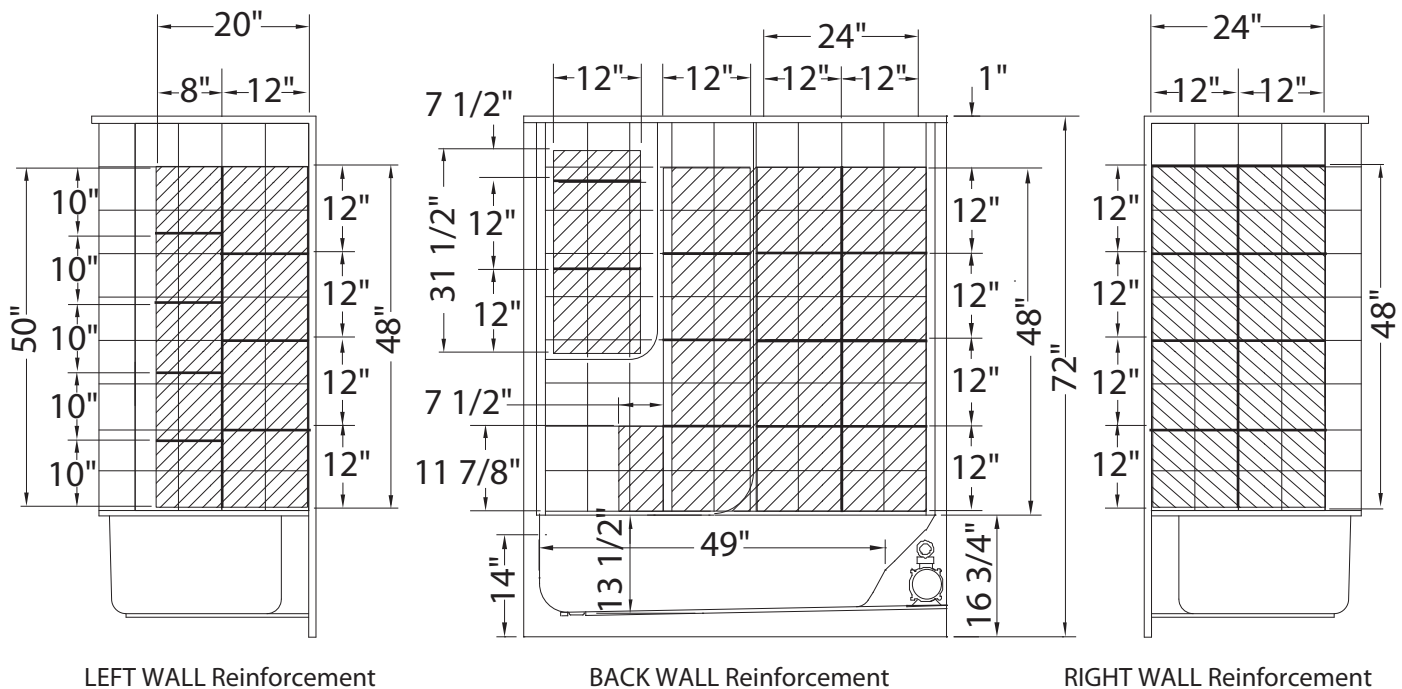

( ▲ ): Indicates Whirlpool jets positioning  
 ( △ ): Indicates suction positioning

All dimensions are approximate. Structure measurements must be verified against the unit to ensure proper fit.