

# MAAX SUBMITTAL SPECIFICATIONS

## US36

**MODEL NUMBER 102613**

DIMENSIONS: 36" x 36" x 79" Fiberglass



Project : .....  
Contractor : .....  
MAAX Representative : ..... Tel : .....  
Date : .....

**www.maax.com**

Vivez l'expérience  
**MAAX®**  
Enjoy the experience

### STANDARD FEATURES

- 1-piece shower without roof cap
- Integrated shelves
- Center drain

### OPTIONS

- Wall reinforcement (one wall)

### UNIQUE FEATURES

- None

### SYSTEMS

- None

### DOOR SELECTION

Combine with MAAX's complete shower door offering visit [www.maax.com](http://www.maax.com)

### CERTIFICATIONS

Maax products adhere to one or more of the following certifications:



2018-01-08

## MAAX SUBMITTAL SPECIFICATIONS

# US36

MODEL NUMBER 102613

## TECHNICAL DRAWINGS

Full Wall Reinforcement Shown

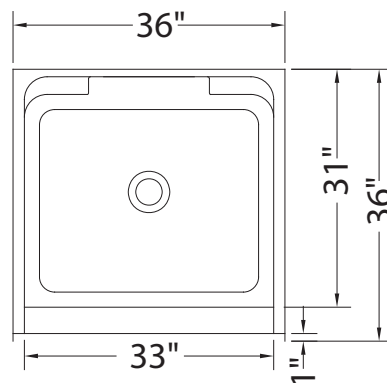
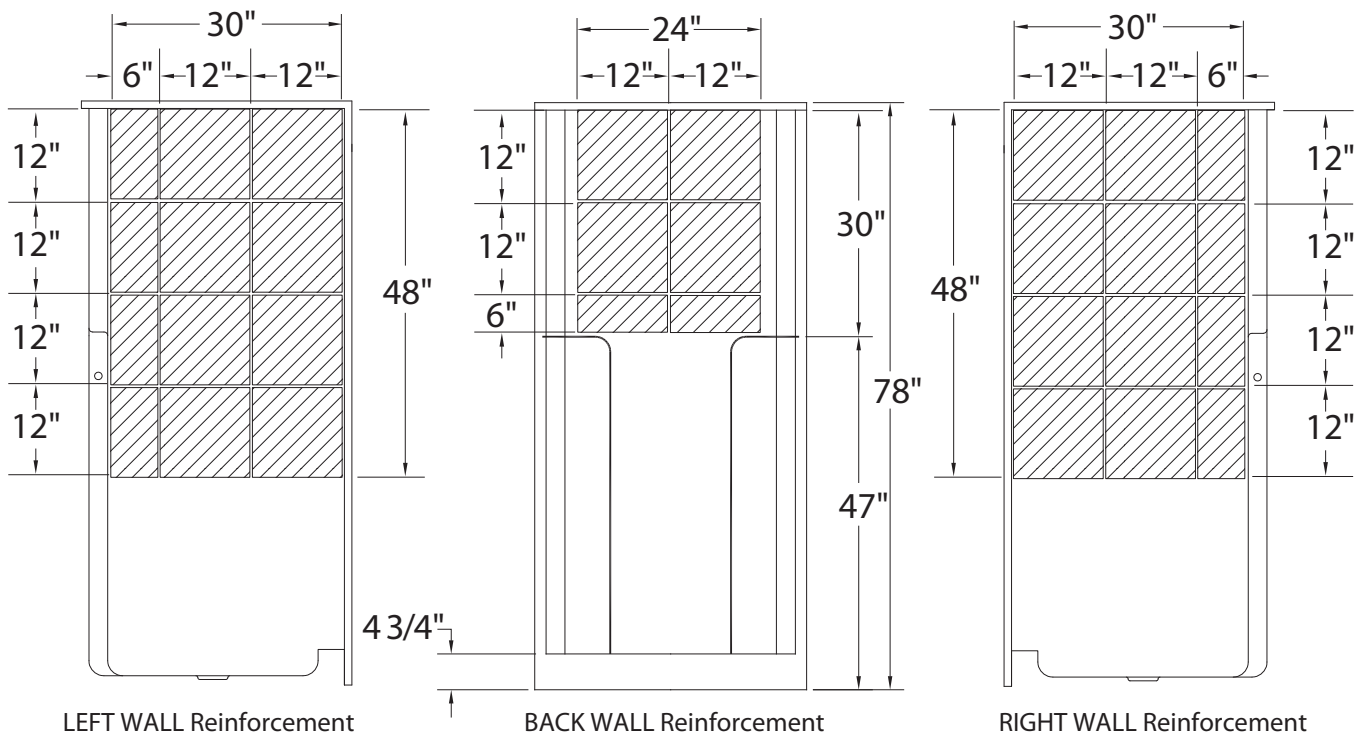

All dimensions are approximate. Structure measurements must be verified against the unit to ensure proper fit.

2018-01-08